

**SEWER JUNCTION INFORMATION
FOR SEWER ID MA60000334**

REFERENCE—METERS EAST OF MANHOLE MH60000193

DIST. FROM REF. MANHOLE	JUNCTION DIA.	CLOCK REF.	SERVICE TYPE	DESCRIPTION
2.5	100	02	JN	—
10.2	100	12	JN	CAPPED
22.5	100	12	JN	CAPPED
24.0	100	12	JN	CAPPED
25.6	100	12	JN	CAPPED
36.5	100	12	JN	—
47.1	100	12	JN	—
74.9	100	12	JX	LIVE

ALL JUNCTION INFORMATION
BASED ON CCTV INSPECTION

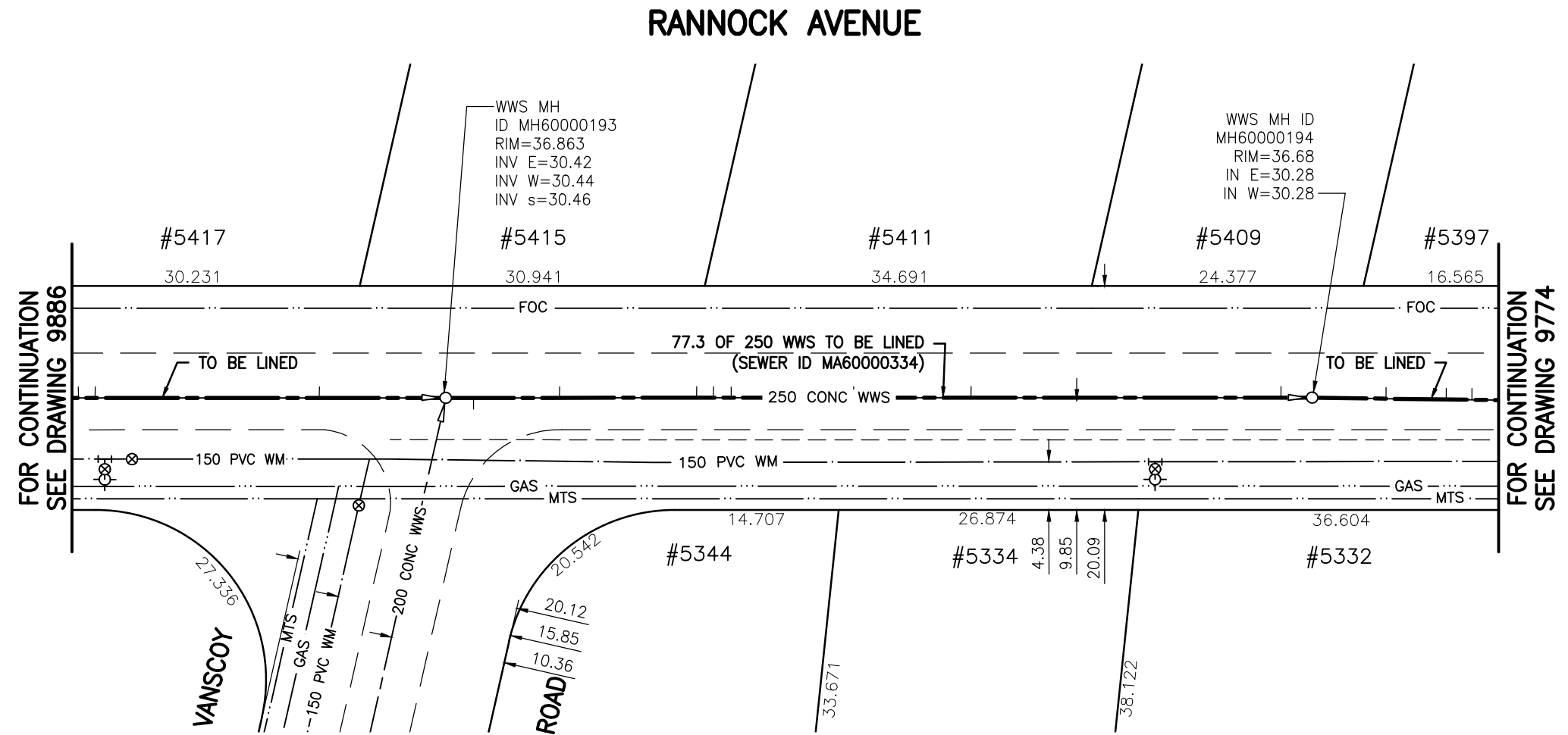

FOR CONTINUATION
SEE DRAWING 9886

FOR CONTINUATION
SEE DRAWING 9774



WARNING

IF POWER EQUIPMENT OR EXPLOSIVES ARE TO BE USED FOR EXCAVATION ON THIS PROJECT THE CONTRACTOR MUST:

- 1) NOTIFY THE GAS COMPANY OF THE PROPOSED LOCATION OF EXCAVATION.
- 2) TAKE PRECAUTION TO AVOID DAMAGE TO GAS COMPANY INSTALLATIONS.

SEE PROVINCIAL REGULATION 140/92 FOR DETAILS

METRIC

WHOLE NUMBERS INDICATE MILLIMETRES
DECIMALIZED NUMBERS INDICATE METRES

BENCH MARK: W. side Community Row N. of Rannock Ave., Tblt. in N. Conc. Foundation of N. 762 Community Row, 1.0 m W. of N.E. Cor. of house & 0.15 m below stucco.



Certificate of Authorization

Stantec Consulting Ltd.

No. 1301 Date: _____

BID OPPORTUNITY 927-2011

**LOCATION APPROVED
UNDERGROUND STRUCTURES**

B.M.	48-015		
ELEV.	237.649m		
NO.	REVISIONS	DATE	BY

SUPV. U/G STRUCTURES COMMITTEE DATE

NOTE:
LOCATION OF UNDERGROUND STRUCTURES AS SHOWN ARE BASED ON THE BEST INFORMATION AVAILABLE BUT NO GUARANTEE IS GIVEN THAT ALL EXISTING UTILITIES ARE SHOWN OR THAT THE GIVEN LOCATIONS ARE EXACT. CONFIRMATION OF EXISTENCE AND EXACT LOCATION OF ALL SERVICES MUST BE OBTAINED FROM THE INDIVIDUAL UTILITIES BEFORE PROCEEDING WITH CONSTRUCTION.



Stantec Consulting Ltd.

905 Waverley Street, Winnipeg, Manitoba
Tel 204-489-5900 Fax 204-453-9012

DESIGNED BY	J.K.H.	CHECKED BY	W.A.B.
DRAWN BY	K.R.	APPROVED BY	H.A.K.
HOR. SCALE:	1:500	RELEASED FOR CONSTRUCTION:	
VERTICAL:	N/A	DATE	2011.09.30

ENGINEER'S SEAL

CONSULTANT DRAWING NO.
C-106



**THE CITY OF WINNIPEG
WATER AND WASTE DEPARTMENT**

**2011 SEWER RENEWALS
BY CIPP LINING - CONTRACT 21
RANNOCK AVENUE
MH AT VANSCOY RD. (CL) TO
1ST MH E. AT VANSCOY RD.**

SHEET	OF
9	119
CAD FILE DRAWING NUMBER I3220c-101-766.dwg	
CITY DRAWING NUMBER 9775	

\\CD1201-F02\work_group\1112\active\111213220\drawing\402_design\sheet_files\13220c-101-766.dwg
Date: 2011-12-19 3:42pm Login: Ammeter, Wes