



**SEWER JUNCTION INFORMATION
FOR SEWER ID MA60000339**

REFERENCE—METERS SOUTH OF MANHOLE MH60000197

DIST. FROM REF. MANHOLE	JUNCTION DIA.	CLOCK REF.	SERVICE TYPE	DESCRIPTION
16.0	100	12	CN	—
39.9	100	03	CNI	—
40.4	100	12	CN	—
70.7	100	06	JN	DROP MH

ALL JUNCTION INFORMATION
BASED ON CCTV INSPECTION

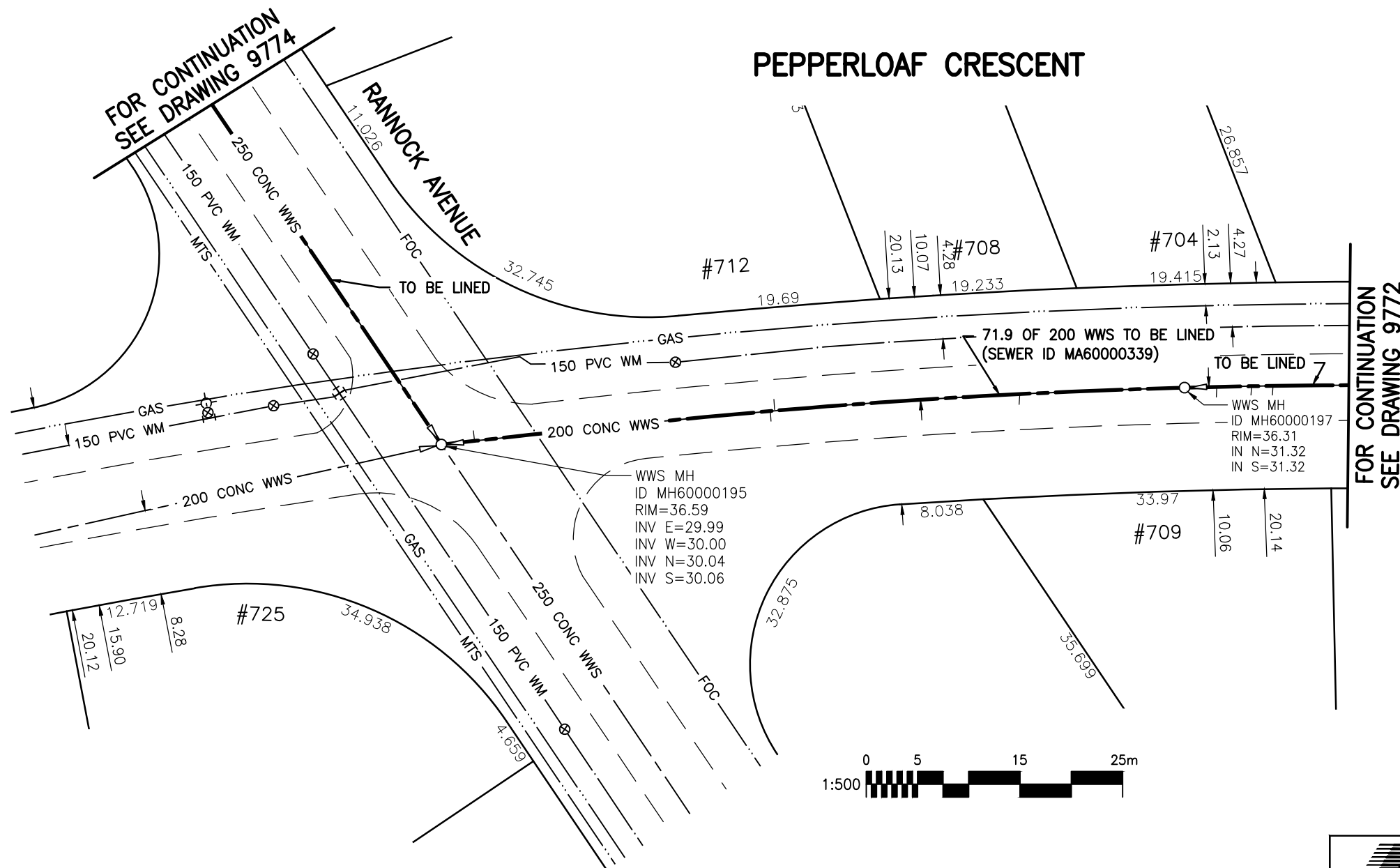

WARNING

IF POWER EQUIPMENT OR EXPLOSIVES ARE TO BE USED FOR EXCAVATION ON THIS PROJECT THE CONTRACTOR MUST:

- 1) NOTIFY THE GAS COMPANY OF THE PROPOSED LOCATION OF EXCAVATION.
- 2) TAKE PRECAUTION TO AVOID DAMAGE TO GAS COMPANY INSTALLATIONS.

SEE PROVINCIAL REGULATION 140/92 FOR DETAILS

METRIC

WHOLE NUMBERS INDICATE MILLIMETRES
DECIMALIZED NUMBERS INDICATE METRES

BENCH MARK: W. side Pepperloaf Cres. N. of Dunelm Lane, Tblt. in S. Conc. foundation of Roblin Park Community Club N. 640 Pepperloaf Cresc., 1.0 m W. of S.E. Cor. of Bldg. & 0.5 m below stucco.

Certificate of Authorization
Stantec Consulting Ltd.
No. 1301 Date: _____

BID OPPORTUNITY 927-2011

**LOCATION APPROVED
UNDERGROUND STRUCTURES**

B.M. 48-020	
ELEV. 236.668m	
SUPV. U/G STRUCTURES COMMITTEE	DATE
NOTE: LOCATION OF UNDERGROUND STRUCTURES AS SHOWN ARE BASED ON THE BEST INFORMATION AVAILABLE BUT NO GUARANTEE IS GIVEN THAT ALL EXISTING UTILITIES ARE SHOWN OR THAT THE GIVEN LOCATIONS ARE EXACT. CONFIRMATION OF EXISTENCE AND EXACT LOCATION OF ALL SERVICES MUST BE OBTAINED FROM THE INDIVIDUAL UTILITIES BEFORE PROCEEDING WITH CONSTRUCTION.	
NO.	REVISIONS
DATE	BY

Stantec Consulting Ltd.
905 Waverley Street, Winnipeg, Manitoba
Tel 204-489-5900 Fax 204-453-9012

DESIGNED BY	J.K.H.	CHECKED BY	W.A.B.
DRAWN BY	K.R.	APPROVED BY	H.A.K.
HOR. SCALE:	1:500	RELEASED FOR CONSTRUCTION:	
VERTICAL:	N/A	DATE	2011.09.30

ENGINEER'S SEAL

CONSULTANT DRAWING NO.
C-104

**THE CITY OF WINNIPEG
WATER AND WASTE DEPARTMENT**

**2011 SEWER RENEWALS
BY CIPP LINING - CONTRACT 21
PEPPERLOAF CRESCENT**

MH AT RANNOCK AV. (CL) TO
1ST MH N. RANNOCK AV.

SHEET	OF
7	119
CAD FILE DRAWING NUMBER I3220c-101-766.dwg	
CITY DRAWING NUMBER 9773	

\\CD1201-F02\work_group\1112\active\111213220\drawing\402_design\sheet_files\13220c-101-766.dwg
 Date: 2011-12-19 3:45pm Login: Ammeter, Wes