

SECTION "C-C"  
SCALE: 1:25

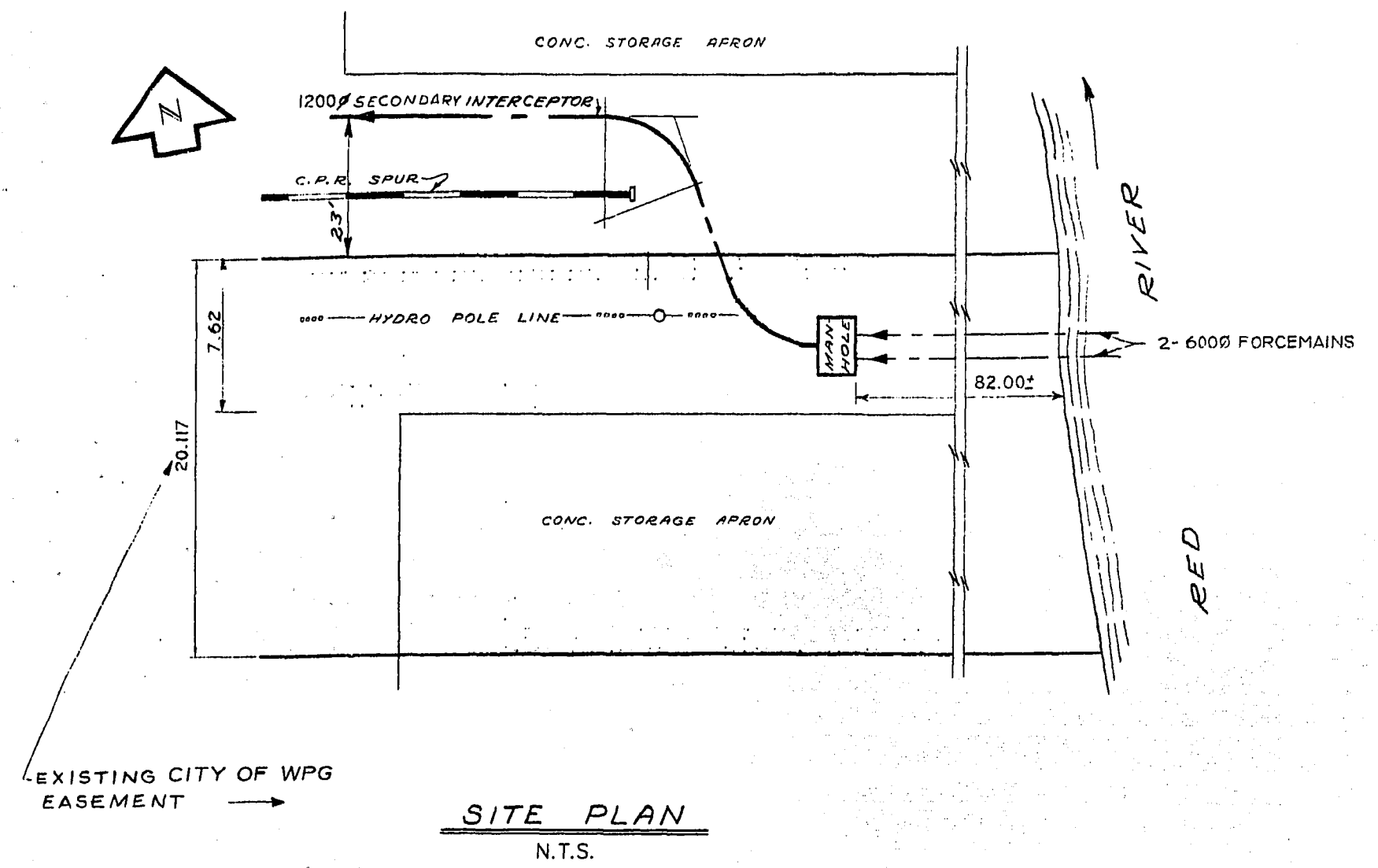

SITE PLAN  
N.T.S.

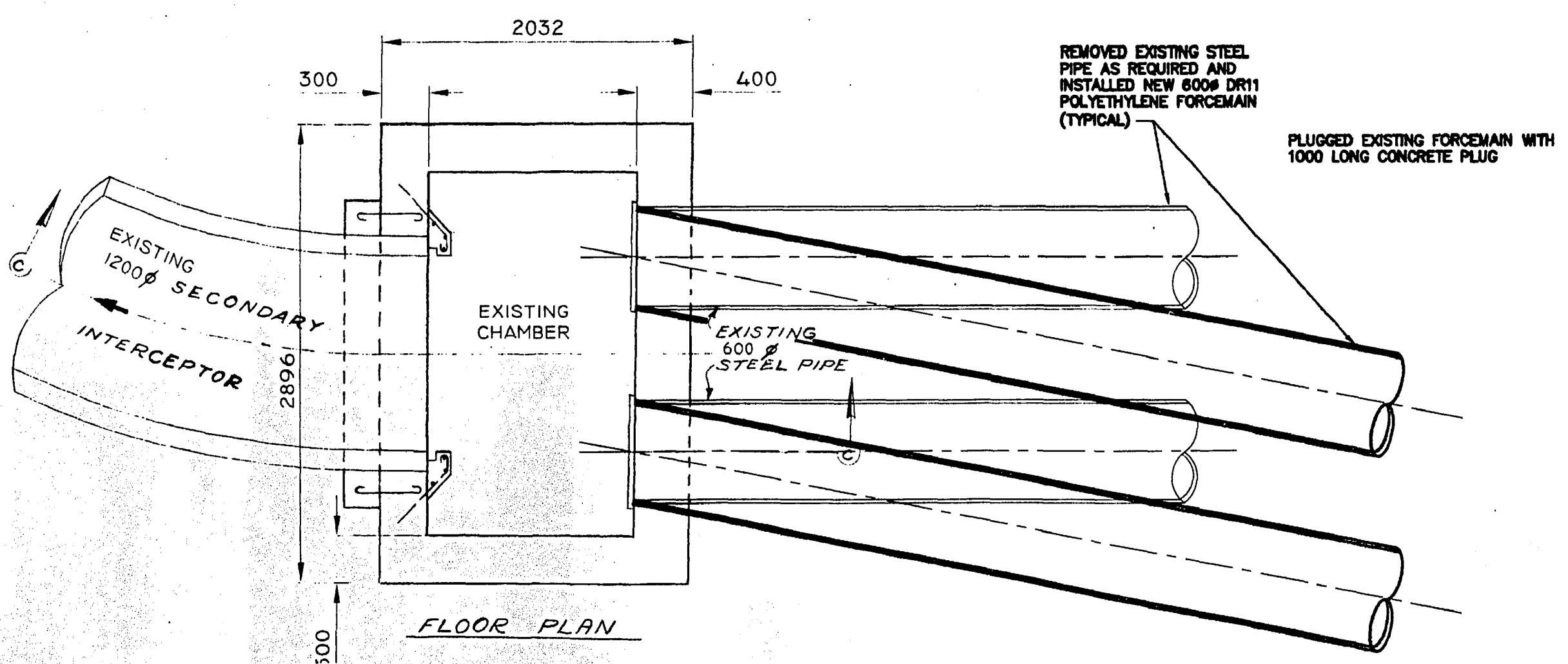

CONNECTION DETAILS 2-600 FORCEMAINS TO EXISTING MANHOLE  
SCALE: 1:25

PROJECT COMPLETION  
DATE 2004.05.10

METRIC  
WHOLE NUMBERS INDICATE MILLIMETRES  
DECIMALIZED NUMBERS INDICATE METRES

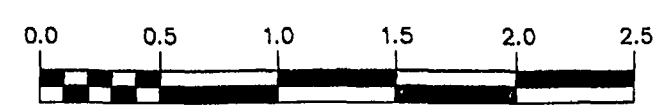

**AS-CONSTRUCTED**  
WATER AND WASTE DEPARTMENT

**WARNING**  
IF POWER EQUIPMENT OR EXPLOSIVES ARE TO BE USED FOR EXCAVATION ON THIS PROJECT THE CONTRACTOR  
1) NOTIFY THE GAS COMPANY OF THE PROPOSED LOCATION OF EXCAVATION.  
2) TAKE PRECAUTION TO AVOID DAMAGE TO GAS COMPANY INSTALLATIONS.  
SEE PROVINCIAL REGULATION 210/72 FOR DETAILS

B.M. ELEV.	FIELD BOOK #
POSTED TO LBS	
1.)	REVISED TO AS-CONSTRUCTED 04.10.01 WKT/CJM
NO. REVISIONS	DATE BY

CITY OF WINNIPEG WATER AND WASTE ENGINEERING DIVISION			
DESIGNED BY	JE	CHECKED BY	JE
DRAWN BY	WKT	APPROVED BY	KZ
HOR. SCALE	AS SHOWN	RELEASED FOR CONSTRUCTION	
VERTICAL			
DATE	2004.01.15	DATE	

ENGINEER'S SEAL  
  
 TENDER No. 16-2004  
 FILENAME: 05357.dwg  
 PLOT DATE: 2004 10 01

**THE CITY OF WINNIPEG**  
WATER AND WASTE DEPARTMENT  
 WINNIPEG  
 MONTCALM SEWAGE PUMPING STATION  
**FORCEMAIN REPLACEMENT**  
 SHEET 2 OF 4  
 CITY DRAWING NUMBER  
**05357**