

WORTHINGTON AVENUE

ST GEORGE RD

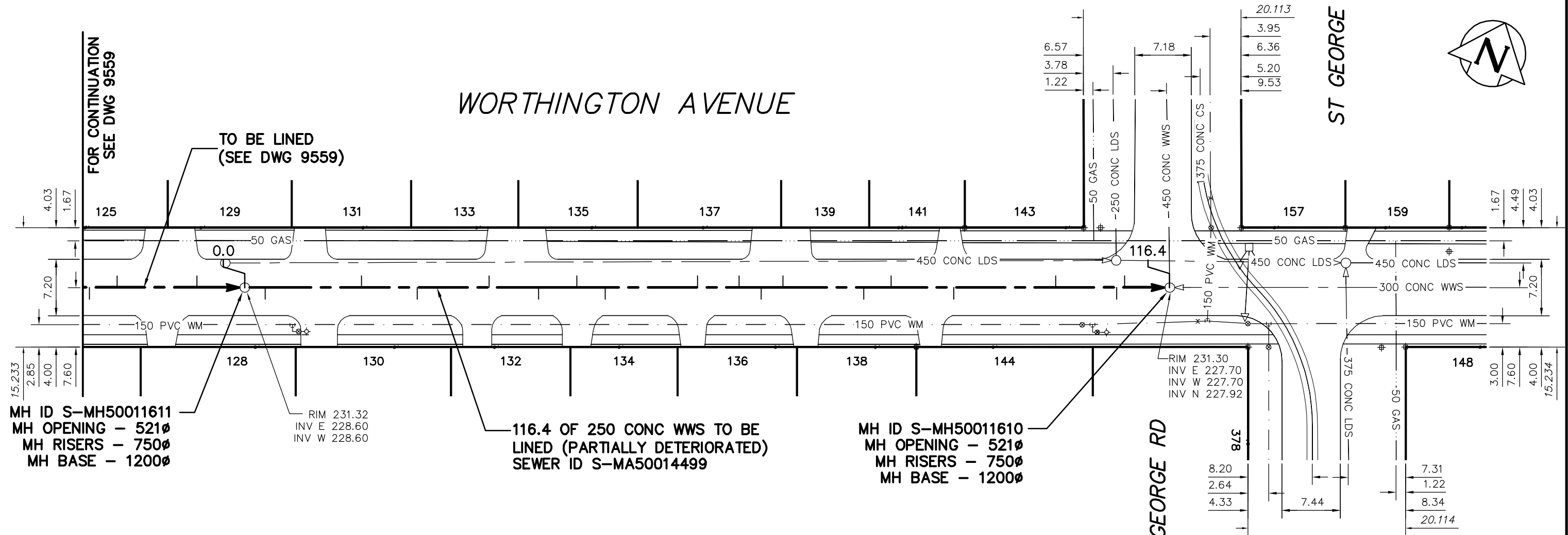

SEWER JUNCTION INFORMATION
FROM SEWER VIDEO INSPECTION
SEWER ID S-MA50014499

DISTANCE FROM MH ID S-MH50011611				
2.6	E	150Ø	SOUTH	CNI
14.9	E	150Ø	NORTH	JN
22.0	E	200Ø	SOUTH	JN
31.2	E	150Ø	NORTH	CNI
37.5	E	150Ø	SOUTH	CNI
42.4	E	150Ø	NORTH	CNI
46.0	E	150Ø	SOUTH	CNI
57.8	E	150Ø	NORTH	CN
63.1	E	150Ø	NORTH	CNI
65.9	E	150Ø	SOUTH	CNI
68.7	E	150Ø	NORTH	CN
79.0	E	150Ø	SOUTH	CNI
82.5	E	150Ø	NORTH	CNI
90.5	E	150Ø	SOUTH	CNI
103.5	E	150Ø	NORTH	CNI
111.3	E	150Ø	SOUTH	CN
112.3	E	150Ø	NORTH	CNI
-	E	150Ø	-	-

LEGEND:

52.0 | MEASUREMENT TO REPAIR FROM REFERENCE MH SHOWN THUS...

METRIC

WHOLE NUMBERS INDICATE MILLIMETRES
DECIMALIZED NUMBERS INDICATE METRES

ENGINEER'S SEAL

**ORIGINAL
SIGNED BY
S.R.J.
COURNOYER
11-03-18**

BID OPPORTUNITY No: 49-2011

FILENAME : 9558_9560.dwg

PLOT DATE : 2011 03 23

B.M. ELEV.	FIELD BOOK #:	CITY OF WINNIPEG WATER AND WASTE ENGINEERING DIVISION		THE CITY OF WINNIPEG WATER AND WASTE DEPARTMENT	
POSTED TO LBS		DESIGNED BY: SC	CHECKED BY: SC	2011 SEWER RENEWALS BY CIPP LINING, CONTRACT 14 WORTHINGTON AVENUE	
		DRAWN BY: KB	APPROVED BY: KZ	2ND MH E OF FITZPATRICK ROAD TO MH AT ST GEORGE ROAD	
		HOR. SCALE: 1:500	RELEASED FOR CONSTRUCTION: KAS ZUREK	SHEET 82 OF 85	
		VERTICAL		CITY DRAWING NUMBER	
NO.	REVISIONS	DATE	BY	9560	
		2011 03 18			