

STURGEON ROAD

MATCHLINE 0+210

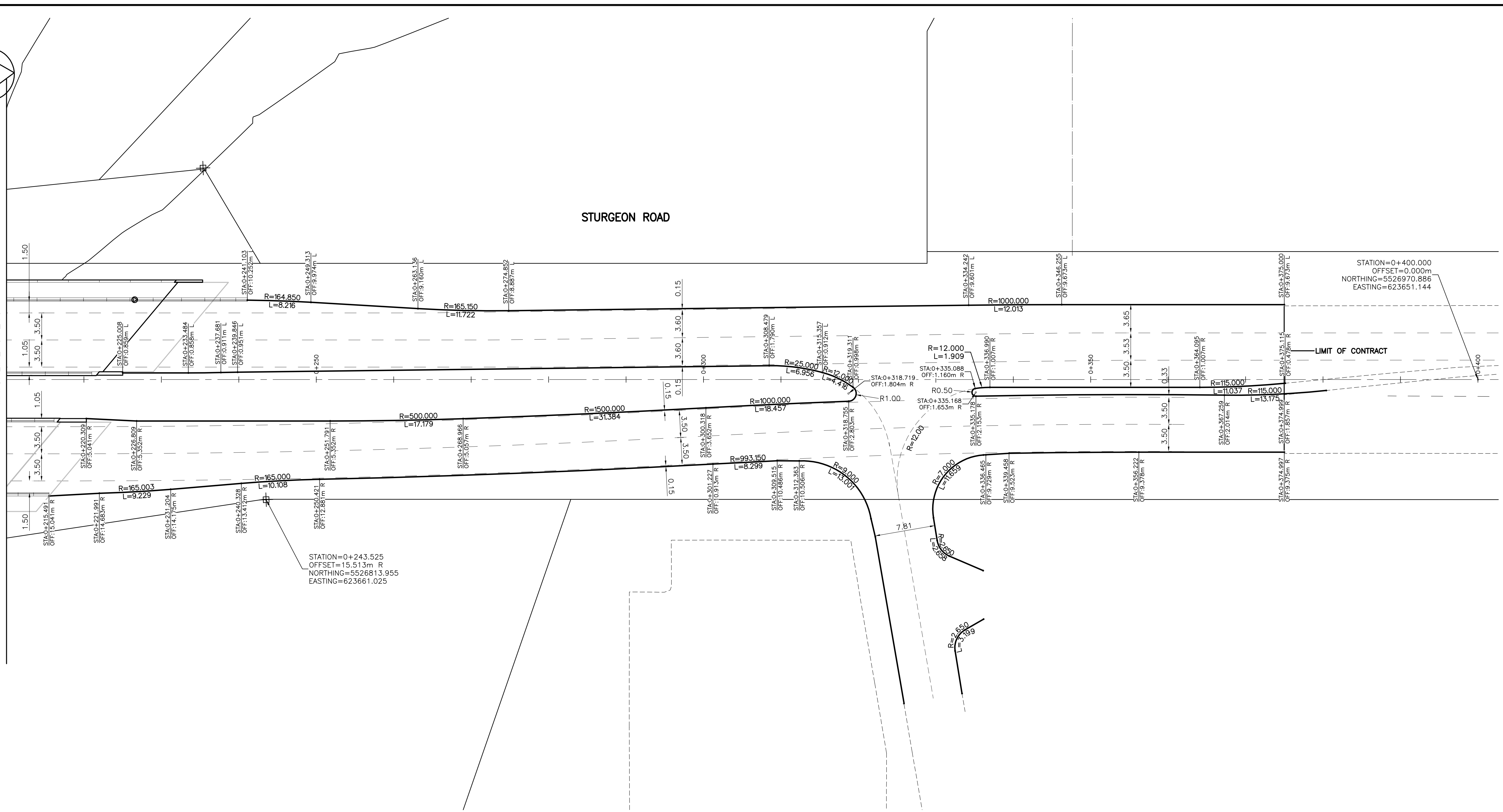

STATION=0+400.000  
OFFSET=0.000m  
NORTHING=5526970.866  
EASTING=623651.144

STATION=0+243.525  
OFFSET=15.513m R  
NORTHING=5526813.955  
EASTING=623661.025

WARNING

IF POWER EQUIPMENT OR EXPLOSIVES ARE TO BE USED FOR EXCAVATION ON THIS PROJECT THE CONTRACTOR MUST:  
1) NOTIFY THE GAS COMPANY OF THE PROPOSED LOCATION OF EXCAVATION.  
2) TAKE PRECAUTION TO AVOID DAMAGE TO GAS COMPANY INSTALLATIONS.  
SEE PROVINCIAL REGULATION 140/92 FOR DETAILS

METRIC

WHOLE NUMBERS INDICATE MILLIMETRES  
DECIMALIZED NUMBERS INDICATE METRES

83R498 - N. SIDE PORTAGE AVE. @  
HARRIS BLVD., TBLT. ON TOP OF 0.05m  
DIA. X 2.4m IRON PIPE, 6.5m N. OF  
N. CURB LINE OF PORTAGE AVE., & 2.2m  
E. OF C.L. CONC. PAVT. OF HARRIS BLVD.  
PRODUCED FROM THE S.



150 WM	WATERMAIN	150 WM	HYDRO	150 WM	WATERMAIN	150 WM
+	HYDRANT	+	M.T.S.	+	HYDRANT, VALVE	+
+	VALVE	+	CONCRETE	+	LAND DRAINAGE SEWER	+
300 LDS	LAND DRAINAGE SEWER	300 LDS	ASPHALT	250 WWS	WASTE WATER SEWER	250 WWS
250 WWS	WASTE WATER SEWER	250 WWS	SIDEWALK	X	PROFILE	
o	MANHOLE	o	PROPERTY LINE	o	NORTH OR WEST GUTTER	
□	CATCH BASIN	□	SURVEY BAR	o	SOUTH OR EAST GUTTER	
▽	CURB INLET	▽	DITCH	o	NORTH OR WEST R	
+	JUNCTIONS	+	ELEVATION	o	SOUTH OR EAST R	
+	CULVERT	+	SIDEWALK RAMP	△	NORTH OR WEST DITCH	
+	GAS	+		▽	SOUTH OR EAST DITCH	
EXISTING	LEGEND-PLAN	PROPOSED	EXISTING	LEGEND-PLAN	PROPOSED	EXISTING

LOCATION APPROVED UNDERGROUND STRUCTURES

SUPV. U/G STRUCTURES COMMITTEE DATE

NOTE:  
LOCATION OF UNDERGROUND STRUCTURES AS SHOWN ARE BASED ON THE BEST INFORMATION AVAILABLE BUT NO GUARANTEE IS GIVEN THAT ALL EXISTING UTILITIES ARE SHOWN OR THAT THE GIVEN LOCATIONS ARE EXACT. CONFIRMATION OF EXISTENCE AND EXACT LOCATION OF ALL SERVICES MUST BE OBTAINED FROM THE INDIVIDUAL UTILITIES BEFORE PROCEEDING WITH CONSTRUCTION.

B.M. 39-44	ELEV. 233.848 m
0	ISSUED FOR TENDER 11.12.15 V.M.M.
NO. REVISIONS	DATE BY

**Stantec Consulting Ltd.**  
100-1355 Taylor Ave., Winnipeg, Manitoba  
Tel 204-928-8840 Fax 204-284-4795

DESIGNED BY: V.M.M. CHECKED BY:  
DRAWN BY: T.G. APPROVED BY: V.M.M.

HOR. SCALE: 1:250  
VERTICAL: RELEASED FOR CONSTRUCTION: DATE

11.09.20

ENGINEER'S SEAL  
CONSULTANT DRAWING NO. C-106

**THE CITY OF WINNIPEG**  
PUBLIC WORKS DEPARTMENT  
ENGINEERING DIVISION

**STURGEON ROAD**  
BRIDGE REPLACEMENT  
PORTAGE AVENUE TO HALLONQUIST DRIVE  
STA. 0+210 TO STA. 0+375  
HORIZONTAL GEOMETRY

SHEET 64 OF 82  
CAD FILE DRAWING NUMBER 31590c-105-767.DWG  
CITY DRAWING NUMBER P-3331-02