

- NOTES:**
- CONTRACTOR TO EXPOSE EXISTING OUTFALL PIPE AT CHAMBER 2 AND 3 TO LOCATE THE CLOSEST JOINT ON THE UPSTREAM SIDE. CHAMBER 2 AND 3 TO BE POSITIONED SUCH THAT THE EASTERLY WALL IS AT THE JOINT.
 - CONTRACT ADMINISTRATOR WILL CONFIRM INVERT ELEVATION AT THIS JOINT PRIOR TO THE START OF ANY PIPE OR CHAMBER INSTALLATION.

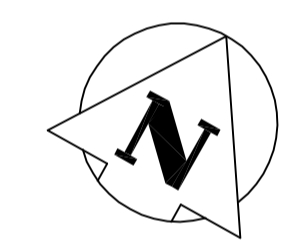

MATCH LINE 14+00 FOR CONTINUATION SEE DWG. 003

WARNING
 IF POWER EQUIPMENT OR EXPLOSIVES ARE TO BE USED FOR EXCAVATION ON THIS PROJECT THE CONTRACTOR MUST:
 1) NOTIFY THE GAS COMPANY OF THE PROPOSED LOCATION OF EXCAVATION.
 2) TAKE PRECAUTION TO AVOID DAMAGE TO GAS COMPANY INSTALLATIONS.
 SEE PROVINCIAL REGULATION 140/92 FOR DETAILS

METRIC
 WHOLE NUMBERS INDICATE MILLIMETRES
 DECIMALIZED NUMBERS INDICATE METRES

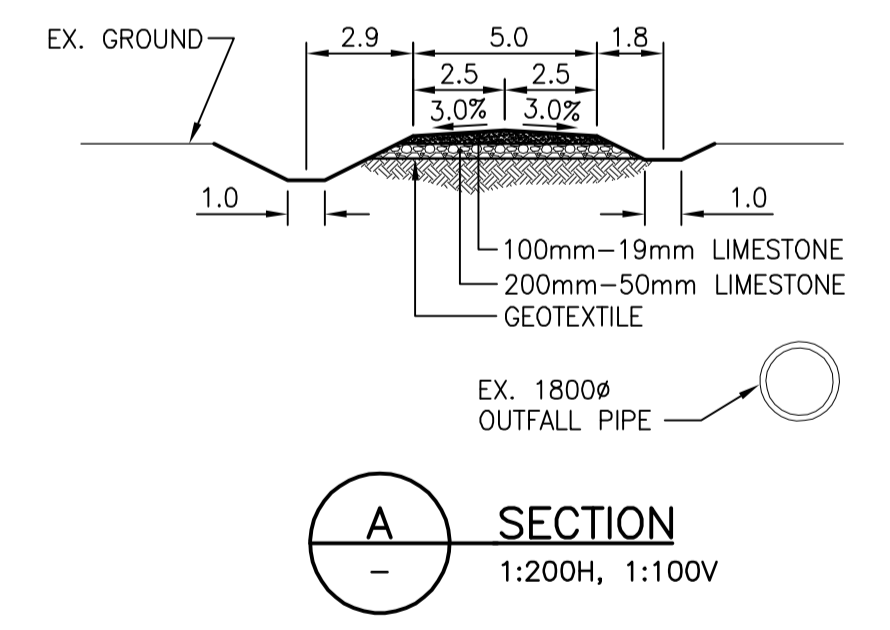
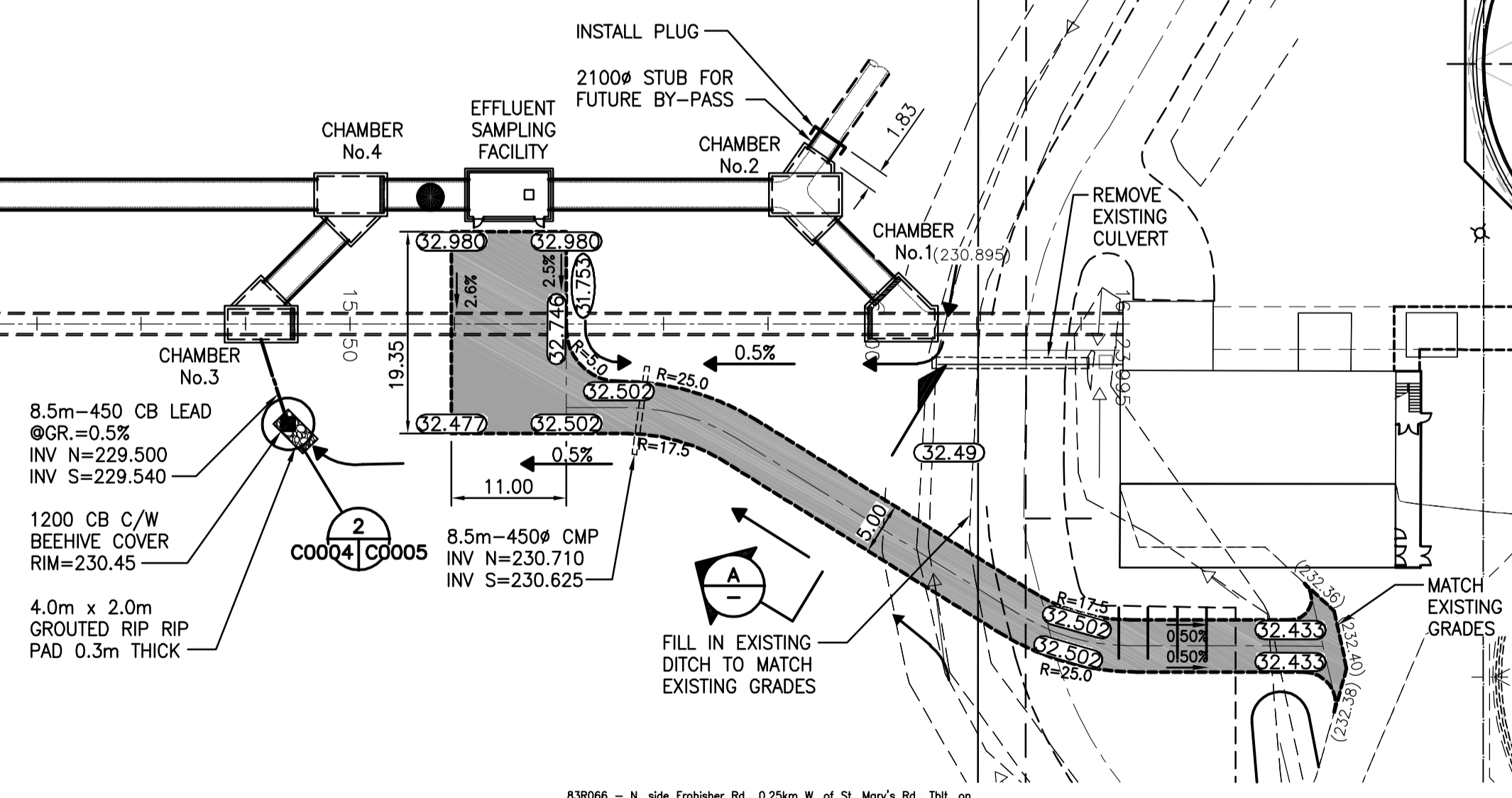

APECM
 Certificate of Authorization
 Stantec Consulting Ltd.
 No. 1301 Expiry: April 30, 2010

150 MM		150 MM					
+	WATERMAIN	+	HYDRANT				
+	VALVE						
+	LAND DRAINAGE SEWER	+	300 L.D.S.				
+	WASTE WATER SEWER	+	250 W.W.S.				
○	MANHOLE	●					
○	CATCH BASIN	+					
▽	CURB INLET	+					
+	JUNCTIONS	+		31.334			
+	CULVERT	+					
+	GAS	+					
---	EXISTING	---	LEGEND-PLAN	---	EXISTING	---	LEGEND-PLAN
---	PROPOSED	---	PROPOSED	---	EXISTING	---	LEGEND-PROFILE
---	PROPOSED	---	PROPOSED	---	EXISTING	---	LEGEND-PROFILE

LOCATION APPROVED UNDERGROUND STRUCTURES
 SUPV. U/G STRUCTURES DATE COMMITTEE
 NOTE:
 LOCATION OF UNDERGROUND STRUCTURES AS SHOWN ARE BASED ON THE BEST INFORMATION AVAILABLE BUT NO GUARANTEE IS GIVEN THAT THE GIVEN LOCATIONS ARE EXACT. CONFIRMATION OF EXISTENCE AND EXACT LOCATION OF ALL SERVICES MUST BE OBTAINED FROM THE INDIVIDUAL UTILITIES BEFORE PROCEEDING WITH CONSTRUCTION.

NO.	REVISIONS	DATE	BY
1	REVISED CHAMBER NUMBERING	09.10.22	
A	ISSUED FOR TENDER	09.10.13	

Stantec Consulting Ltd.
 905 Waverley Street, Winnipeg, Manitoba
 Tel 204-489-5900 Fax 204-453-9012

DESIGNED BY	H.A.K.	CHECKED BY	H.A.K.
DRAWN BY	K.R.	APPROVED BY	E.W.
HOR. SCALE:	1:500	RELEASED FOR CONSTRUCTION:	
VERTICAL:	1:50	DATE	

ENGINEER'S SEAL
 ORIGINAL SEALED BY
 H.A. KATZ
 P. ENG.
 09/10/13

THE CITY OF WINNIPEG
 WATER AND WASTE DEPARTMENT

Winnipeg

SOUTH END WATER POLLUTION CONTROL CENTRE
 INSTALLATION OF OUTFALL PIPE
 EFFLUENT SAMPLING FACILITY AND ASSOCIATED WORKS
 2400 OUTFALL PIPE
 STA. 14+00 TO STA. 16+75

CITY DRAWING NUMBER: **1-0102A-C0004-001-01**

BID OPPORTUNITY NO. **709-2009**

SHEET **1** OF **1**