

**SEWER JUNCTION INFORMATION  
FOR SEWER ID MA60013157**

REFERENCE—METERS EAST OF MANHOLE MH60011300

DIST. FROM REF. MANHOLE	JUNCTION DIA.	CLOCK REF.	SERVICE TYPE	DESCRIPTION
0.9	100	10	CNI	
6.8	100	10	JN	
15.0	100	10	CNI	
17.9	100	09	JN	CAPPED
28.9	100	10	CNI	
32.0	100	10	JN	CAPPED
44.8	100	11	JN	IN EPR
45.7	100	02	JX	IN EPR (BROKEN)
58.6	100	02	CXI	

**SEWER JUNCTION INFORMATION  
FOR SEWER ID MA60013163**

REFERENCE—METERS WEST OF MANHOLE MH60011305

DIST. FROM REF. MANHOLE	JUNCTION DIA.	CLOCK REF.	SERVICE TYPE	DESCRIPTION
3.5	100	02	CN	
9.9	100	02	JN	
17.2	100	10	CNI	LIVE

ALL JUNCTION INFORMATION  
BASED ON CCTV INSPECTION

**SEWER SERVICE INFORMATION**

ADDRESS	SIZE	PROPERTY LINE LOCATION
#719 OAKENWALD AVE RESIDENTIAL	NO INFORMATION	NO INFORMATION
#715 OAKENWALD AVE RESIDENTIAL	NO INFORMATION	NO INFORMATION
#709 OAKENWALD AVE RESIDENTIAL	NO INFORMATION	NO INFORMATION
#708 OAKENWALD AVE RESIDENTIAL	NO INFORMATION	NO INFORMATION
#705 OAKENWALD AVE RESIDENTIAL	NO INFORMATION	NO INFORMATION
#701 OAKENWALD AVE RESIDENTIAL	NO INFORMATION	NO INFORMATION
#801 LYON ST RESIDENTIAL	NO INFORMATION	NO INFORMATION
#681 LYON ST RESIDENTIAL	NO INFORMATION	NO INFORMATION

**WARNING**

IF POWER EQUIPMENT OR EXPLOSIVES ARE TO BE USED FOR EXCAVATION ON THIS PROJECT THE CONTRACTOR MUST:

- 1) NOTIFY THE GAS COMPANY OF THE PROPOSED LOCATION OF EXCAVATION.
- 2) TAKE PRECAUTION TO AVOID DAMAGE TO GAS COMPANY INSTALLATIONS.

SEE PROVINCIAL REGULATION 140/92 FOR DETAILS

**METRIC**

WHOLE NUMBERS INDICATE MILLIMETRES  
DECIMALIZED NUMBERS INDICATE METRES

BENCH MARK: S. side Oakenwald Ave., W. of Point Rd., Tblt. in E. Conc. foundation of Oakenwald School, No. 666 Oakenwald Ave., 1.0 m S. & 0.1 m below brick of N.E. Cor. of school.

BID OPPORTUNITY 536-2009

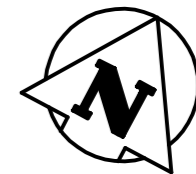
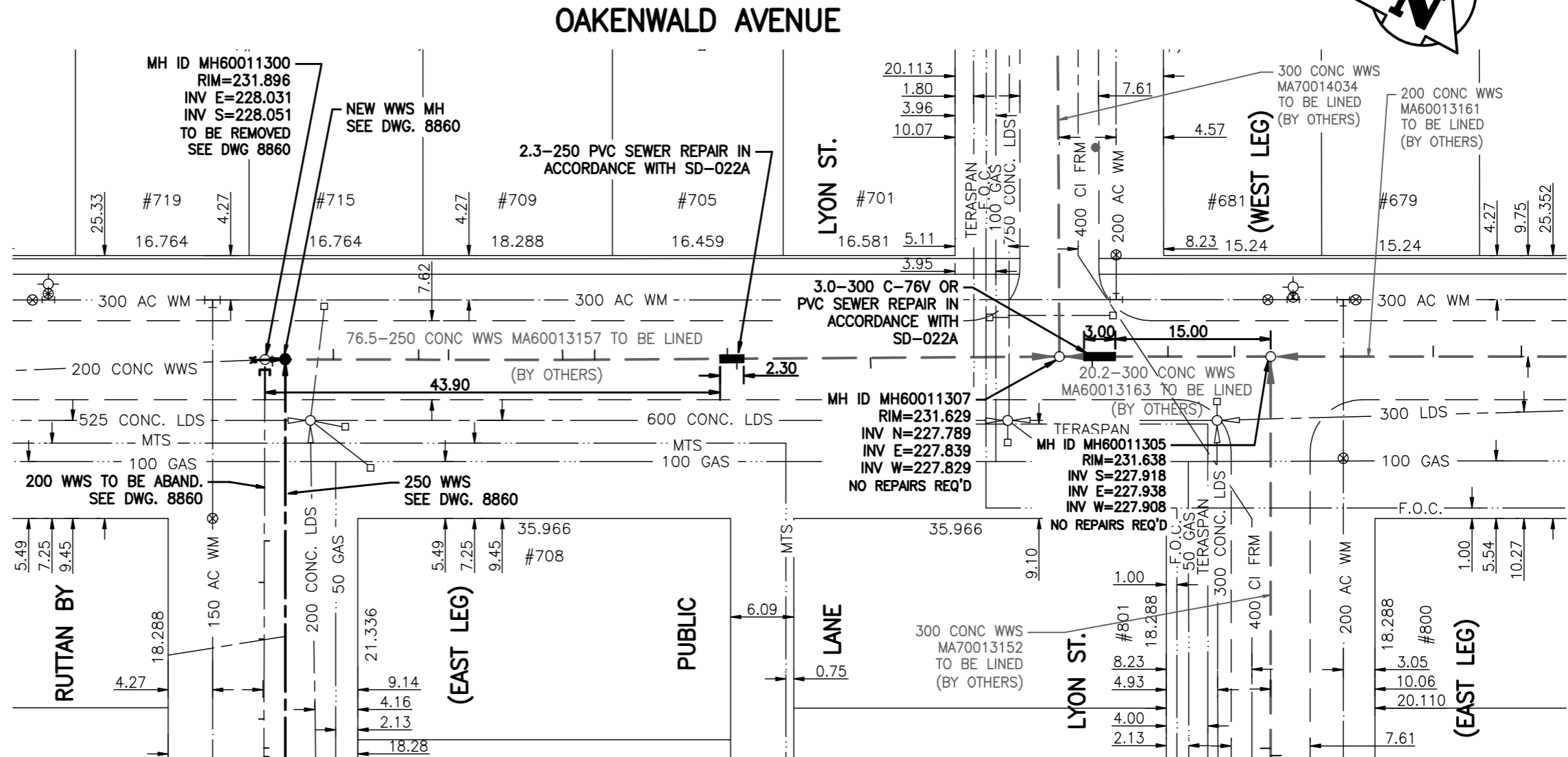

W:\112\1121\11211480\11211480.dwg (11211480.dwg) 2009-08-13 04:25:01 By: jhm

LOCATION APPROVED UNDERGROUND STRUCTURES		B.M. 64-014 ELEV. 232.479m	
SUPV. U/G STRUCTURES COMMITTEE	DATE		
NOTE:			
LOCATION OF UNDERGROUND STRUCTURES AS SHOWN ARE BASED ON THE BEST INFORMATION AVAILABLE BUT NO GUARANTEE IS GIVEN THAT ALL EXISTING UTILITIES ARE SHOWN OR THAT THE GIVEN LOCATIONS ARE EXACT. CONFIRMATION OF EXISTENCE AND EXACT LOCATION OF ALL SERVICES MUST BE OBTAINED FROM THE INDIVIDUAL UTILITIES BEFORE PROCEEDING WITH CONSTRUCTION.			
NO.	REVISIONS	DATE	BY

**Stantec Consulting Ltd.**  
905 Waverley Street, Winnipeg, Manitoba  
Tel 204-489-5900 Fax 204-453-9012

DESIGNED BY	J.K.H.	CHECKED BY	W.A.B.
DRAWN BY	J.K.H.	APPROVED BY	H.A.K.
HOR. SCALE:	1:500	RELEASED FOR CONSTRUCTION:	SIGNED BY K. ZUREK
VERTICAL:	N/A	DATE	AUG. 13, 2009

ENGINEER'S SEAL

**ORIGINAL SEALED BY**  
H.A. KATZ  
P. ENG.  
09.08.13

CONSULTANT DRAWING NO.  
C-101

**THE CITY OF WINNIPEG**  
WATER AND WASTE DEPARTMENT

**2009 SEWER RENEWALS AND EXTERNAL POINT REPAIRS**  
CONTRACT No. 23  
OAKENWALD AVENUE  
MH AT RUTTAN BAY (E LEG) TO MH AT LYON ST (E LEG)  
250 WWS POINT REPAIRS

SHEET	OF
5	14
CAD FILE DRAWING NUMBER 11480c-101-712.dwg	
CITY DRAWING NUMBER 8861	

**APEGM**  
Certificate of Authorization  
Stantec Consulting Ltd.  
No. 1301 Expiry: April 30, 2010