

1
L1
CONTEXT PLAN
Scale: 1:1000

NOTE:
Job has been cleared with the City of Winnipeg Survey Infrastructure Program. Geomatics Cleared Job # 8093.

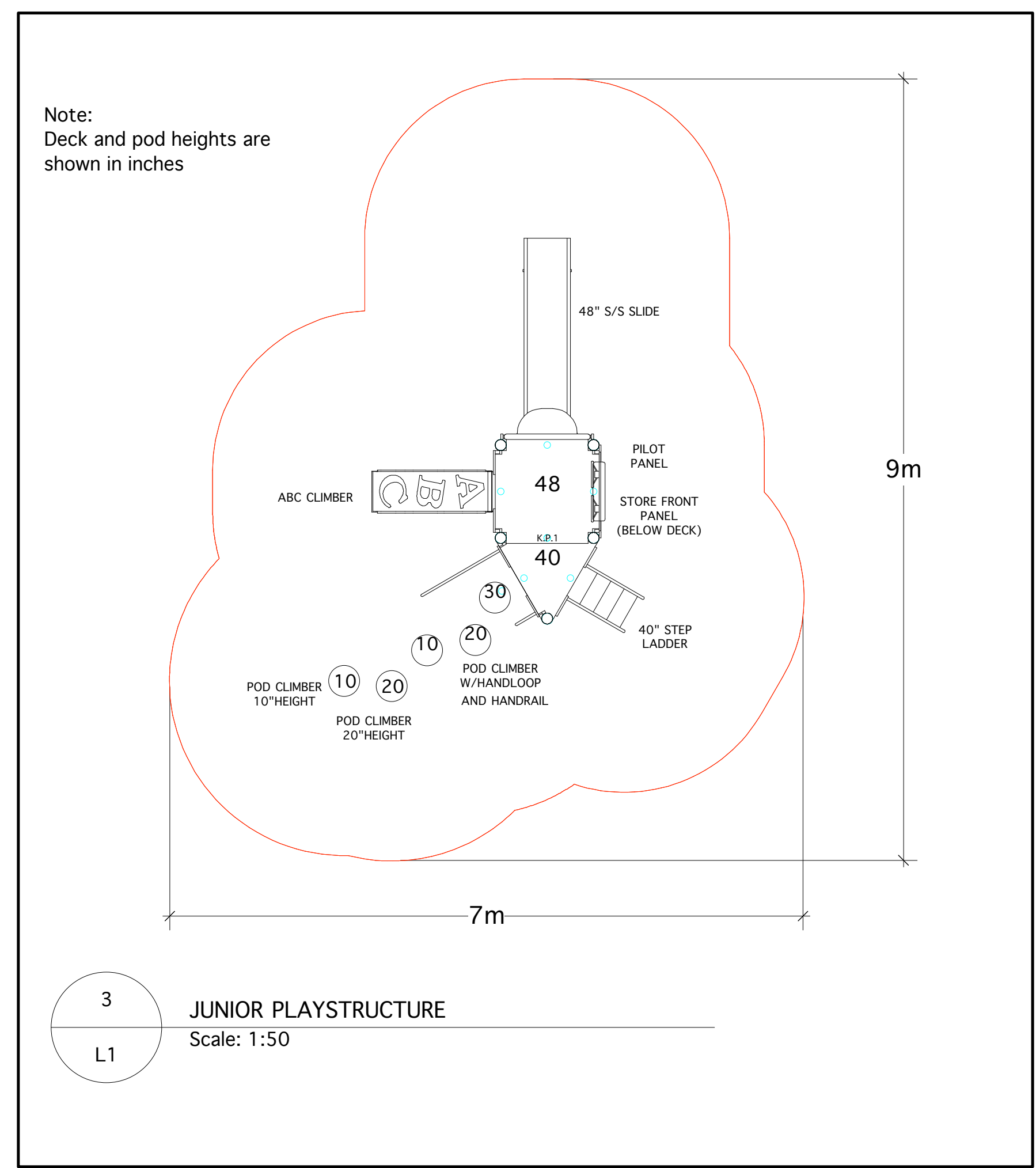

3
L1
JUNIOR PLAYSTRUCTURE
Scale: 1:50

2
L1
EXISTING CONDITIONS AND REMOVALS PLAN
Scale: 1:200

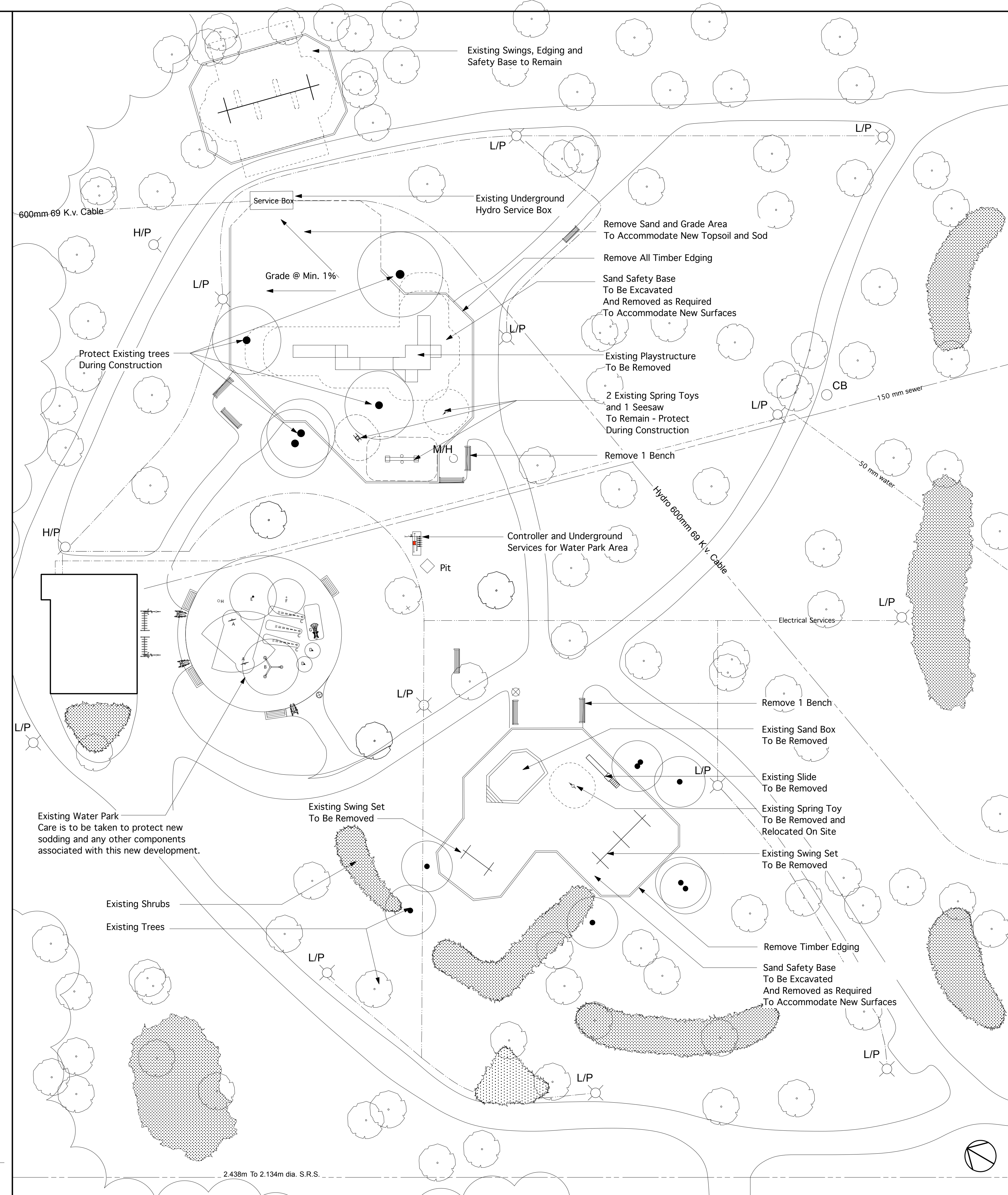

2.438m To 2.134m dia. S.R.S.

**PRELIMINARY
NOT FOR CONSTRUCTION**

NOTE:
LOCATION OF UNDERGROUND STRUCTURES AS SHOWN ARE BASED ON THE BEST INFORMATION AVAILABLE BUT NO GUARANTEE IS GIVEN THAT ALL EXISTING UTILITIES ARE SHOWN OR THAT THE GIVEN LOCATIONS ARE EXACT. CONFIRMATION OF EXISTENCE AND EXACT LOCATION OF ALL SERVICES MUST BE OBTAINED FROM THE INDIVIDUAL UTILITIES BEFORE PROCEEDING WITH CONSTRUCTION.

Manager Parks and Open Space Division
Released For Construction Date

DO NOT SCALE DRAWINGS

5		
4		
3		
2		
1	Junior Area Revisions	07-10-08
0	99% Submission	12-09-08
revisions	description	date

**FORT ROUGE PARK
PLAYGROUND RENOVATION**

approved by		
designed by	LLW	scale As Shown
drawn by	LLW	date 07 10 2008

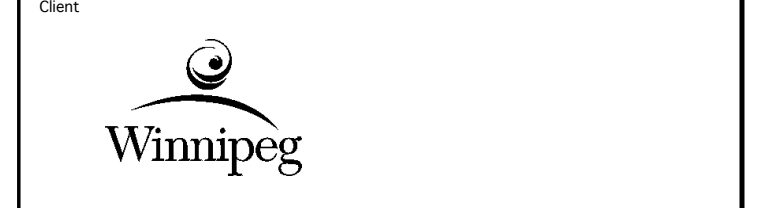

**Existing Conditions
and Removals**

project no.	sheet	revision no.
0812	L1	1