

MAIN FLOOR PLAN - DEMOLITION  
 SCALE: 1/16"=1'-0"

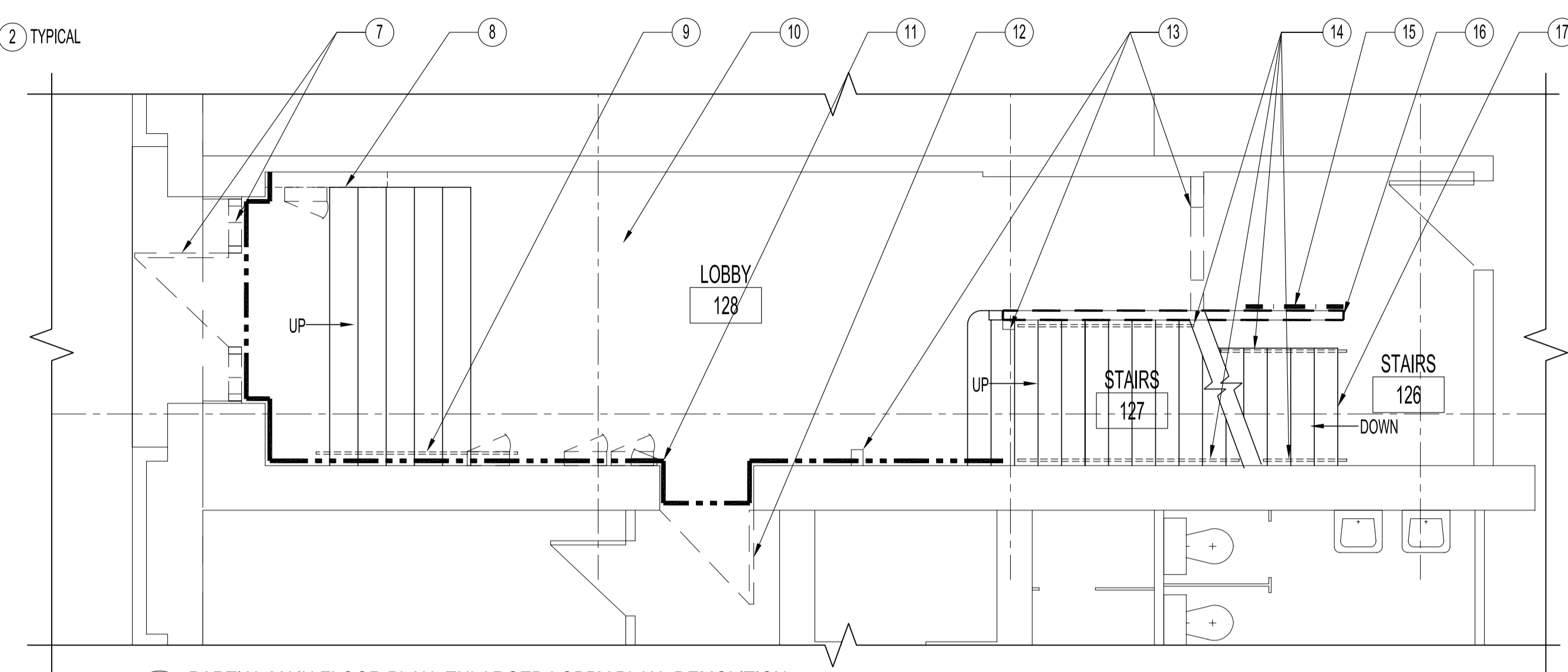

1 PARTIAL MAIN FLOOR PLAN: ENLARGED LOBBY PLAN - DEMOLITION  
 A2/A2 SCALE: 1/4"=1'-0"

LEGEND	
	DOORS TO BE REMOVED
	EXISTING DOORS TO REMAIN
	WINDOWS TO BE REMOVED
	AREAS OF FLOOR NOT IN CONTRACT
	WALLS, FLOORS, COLUMNS & CEILING TO HAVE EXISTING LOOSE & PEELING PAINT REMOVED UNLESS NOTED OTHERWISE-SEE NOTE (2)
	WALLS TO BE DEMOLISHED SEE NOTES (8) (13) (16)
	WALLS W/ PANELING, PLASTER, & FURRING TO BE REMOVED UNLESS NOTED OTHERWISE -SEE NOTES (3) (6) (11)

**GENERAL DEMOLITION NOTES**

ALL NEW ELECTRICAL CONDUIT, BOXES & OLD CONDUIT TO BE UNWIRED & RELOCATED AFTER DEMOLITION. SEE ARCHITECTURAL RENOVATION DRAWING FOR LOBBY & ELECTRICAL DRAWINGS FOR NEW ELECTRICAL LOCATIONS.

**ARCHITECTURAL DEMOLITION NOTES**

- (1) EXISTING STEEL PLATES ON FLOOR TO REMAIN.
- (2) ALL WALLS, FLOORS, WOOD & METAL COLUMNS, BEAMS & CEILING TO BE CLEANED OF LOOSE PAINT & DIRT IN AREA OF WORK ONLY, SEE LEGEND.
- (3) REMOVE EXISTING PLASTER & LATHE WALL DOWN TO EXISTING BRICK WALL. SEE LEGEND.
- (4) REMOVE ALL OLD FLOORING DOWN TO ORIGINAL HARDWOOD FLOOR FROM AREAS OF WORK UNLESS NOTED OTHERWISE. ORIGINAL HARDWOOD FLOORING TO BE SANDED OF ALL FINISH AND PREPARED FOR NEW FINISH. **PROVIDE SEPARATE PRICE FOR HARDWOOD SANDING & REFINISHING.**
- (5) REMOVE ANY LOOSE PLASTER & LATHE ON EXISTING EXTERIOR OF ROOMS & COLUMN. PREPARE FOR NEW PLASTER/GYPSUM BOARD.
- (6) REMOVE EXISTING PANELLING FROM PLASTER WALL.
- (7) REMOVE EXISTING DOOR, GLASS BLOCK IN SIDELIGHTS & GLASS BLOCK IN TRANSOM. PREPARE OPENINGS FOR NEW DOOR & FRAME SIDELIGHTS & FRAMES & TRANSOM & FRAMES. PREPARE WOOD FRAME FOR NEW PAINT. SEE ELEVATION ON A6 FOR OTHER DEMOLITIONS /RENOVATIONS FOR DOORWAY.
- (8) REMOVE EXISTING PANELLING & FRAME BOX DOWN TO EXISTING WALL. SEE ELECTRICAL DRAWING FOR RELOCATION OF EQUIPMENT.
- (9) REMOVE EXISTING STEEL HANDRAIL. SEE RENOVATION DRAWING FOR NEW RAILING.
- (10) REMOVE ALL OLD LAYERS OF FLOORING DOWN TO ORIGINAL HARDWOOD FLOORING IN LOBBY 128. PATCH EXISTING HOLES. REPLACE WOOD NOSING TRIM AT FRONT ENTRANCE STAIRS AS REQUIRED. CLEAN AND PREPARE FLOOR FOR NEW FLOORING. FOR CEILING DEMOLITION SEE REFLECTED CEILING DRAWING. SEE RENOVATION DRAWING.
- (11) REMOVE EXISTING PANELLING, PLASTER & LATHE DOWN TO FACE BRICK WALL.
- (12) REMOVE EXISTING METAL DOOR & METAL FRAME. PREPARE OPENING FOR NEW DOOR & FRAME.
- (13) REMOVE EXISTING WALL EXTENSIONS & DOORWAY & FRAME FLUSH W/ EXISTING WALLS.
- (14) REMOVE & SALVAGE EXISTING METAL RAILINGS FOR RENOVATION. RAILING SURFACES TO BE PREPARED & PAINTED W/ POWDER COAT FINISH. REMOVE ALL LOOSE PAINT FROM WALLS IN STAIRS 126 & 127. PREPARE SURFACES FOR NEW PAINT. SEE RENOVATION DRAWING.
- (15) REMOVE EXISTING STEEL PLATE ON WALL.
- (16) REMOVE EXISTING WALL BOARD DOWN TO WALL FRAMING. INCLUDING STAIRWELL 126. REMOVE T & G BOARDS IN STAIRWELL 127. PLUM WALL LEVEL PRIOR TO NEW GYPSUM BOARD INSTALLATION.
- (17) REMOVE EXISTING RUBBER TREADS FROM BASEMENT STAIRS 126. PREPARE STAIRS FOR NEW TREADS AND PAINT. SEE RENOVATION DRAWING.
- (18) REMOVE EXISTING METAL DOOR, FRAME & THRESHOLD. PREPARE OPENING FOR NEW DOOR, FRAME & THRESHOLD. SEE RENOVATION DRAWING & DOOR SCHEDULE.
- (19) EXISTING STEEL PLATES ON FLOOR TO REMAIN.
- (20) REMOVE EXISTING WOOD WINDOW FRAMES & ALL TRIMS. PREPARE OPENINGS FOR NEW WINDOWS. SEE RENOVATION DRAWING.
- (21) REMOVE ALL DAMAGED FLOOR BOARDS. APPROXIMATELY 75 SQUARE FEET. PREPARE FLOOR FOR NEW BOARDS. SEE RENOVATION DRAWING.

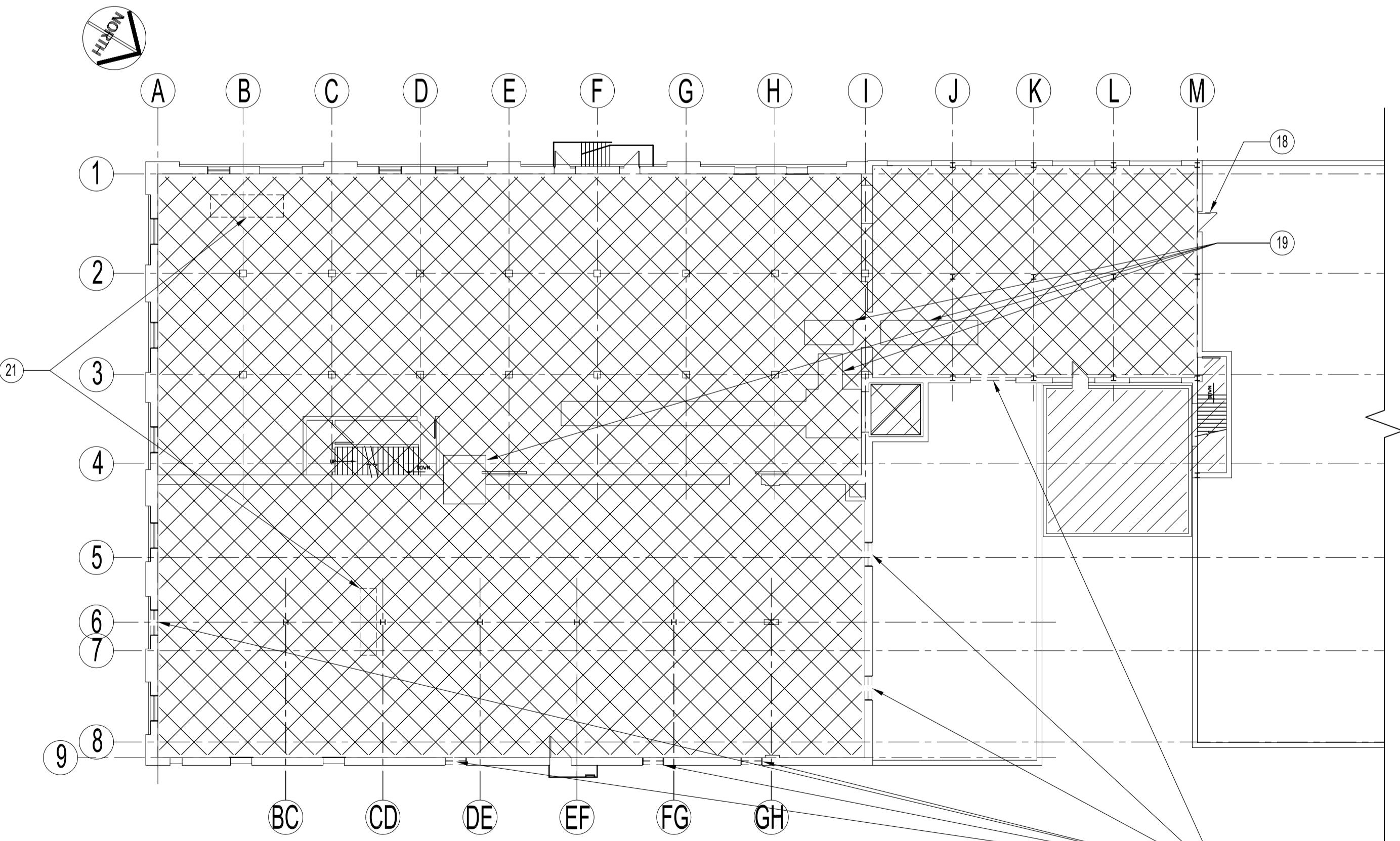

THIRD FLOOR PLAN - DEMOLITION  
 SCALE: 1/8"=1'-0"

ORIGINAL STAMPED BY: R.K.FOK LI Arch.  
 DATE: 2006.12.01

NO.	REVISION/DESCRIPTION	BY	DATE
SEALS			

DRAWN BY: MKK  
 DATE: 2006.12.01  
 CHECKED BY: USER APPROVAL  
 APPROVED

CITY OF WINNIPEG  
 PLANNING, PROPERTY &  
 DEVELOPMENT DEPARTMENT  
 CIVIC ACCOMMODATIONS DIVISION  
 300 - 65 GARRY ST. R3C 4K4

PROJECT  
 SURPLUS STORAGE FACILITY  
 REDEVELOPMENT OF MAIN FLOOR  
 AND THIRD FLOOR  
 311 ROSS AVENUE

SHEET TITLE  
 MAIN & THIRD FLOOR PLANS  
 DEMOLITION

SCALE	PROJECT NO.	SHEET NO.
AS SHOWN	2006-069	A4