

File Name: P:\Projects\2006\06-0107-08\Elect\Drawings\06-0107-08E03.dwg - Tab: E3 Plotted By: GNelson 10/23/2006 [Mon 1:46pm]
 24x36 / PLOT SCALE: 1"=1"

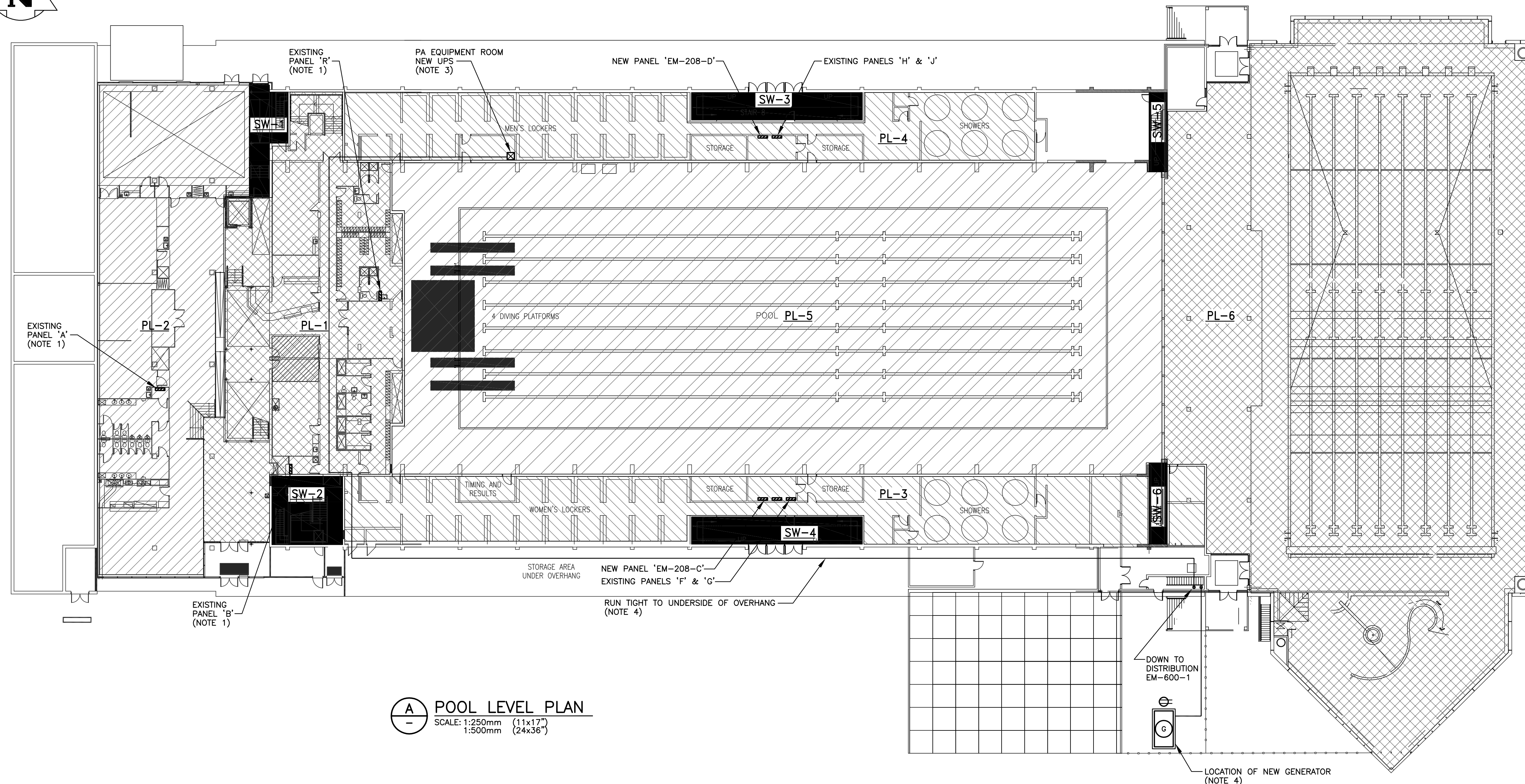
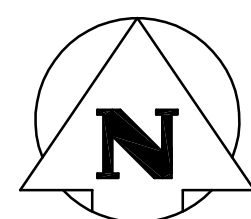

A POOL LEVEL PLAN
 SCALE: 1:250mm (11x17")
 1:500mm (24x36")

SEE NOTE 7 ON DRAWING E2

AREA No.	DESCRIPTION	FIXTURES / CIRCUITS	EM PANEL	NO. OF CIRCUITS
PL-1	POOL LEVEL	EXISTING - CORRIDOR LIGHTING CIRCUITS	EM-208-B	6
PL-2	POOL LEVEL	EXISTING - CORRIDOR LTG. & ONE ROOM LTG. CCT.	EM-208-B	6
PL-3	POOL LEVEL WOMEN'S LOCKERS & SHOWERS	EXISTING - CORRIDOR LIGHTING	EM-208-C	3
PL-4	POOL LEVEL MEN'S LOCKERS & SHOWERS	EXISTING - CORRIDOR LIGHTING	EM-208-D	3
PL-5	POOL LEVEL - MAIN POOL	SEE DRAWING E4		
PL-6	POOL LEVEL - LAP POOL	SEE DRAWING E4		
SW-1	STAIRWELL No.1 (NORTHWEST)	NOTE 2		1
SW-2	STAIRWELL No.2 (SOUTHWEST)	NOTE 2		1
SW-3	STAIRWELL No.3 (NORTH CENTRAL)	ALL LIGHTING CIRCUITS IN STAIRWELL		3
SW-4	STAIRWELL No.4 (SOUTH CENTRAL)	ALL LIGHTING CIRCUITS IN STAIRWELL		3
SW-5	STAIRWELL No.5 (NORTHEAST)	ALL LIGHTING CIRCUITS IN STAIRWELL		1
SW-6	STAIRWELL No.6 (SOUTHEAST)	ALL LIGHTING CIRCUITS IN STAIRWELL		1

- NOTES:**
1. PROVIDE A JUNCTION BOX WITH ONE, TWO OR THREE CIRCUITS FROM PANEL EM-208-B. LOCATE ABOVE PANEL SHOWN. SEE DETAIL 1-B.
 2. THE INTENT IS TO PROVIDE HALF OF THE LIGHTING IN THE STAIRWELLS WITH NEW CIRCUITS. IT IS UNKNOWN IF CIRCUITING IS ON A RISER OR HORIZONTAL FEED. INCLUDE FOR ONE CIRCUIT PER FLOOR IN STAIR.
 3. LOCATE UPS IN THIS ROOM. RUN 600V FEEDER TO NEW EM-600-1 DISTRIBUTION UP AND UNDER BLEACHERS IN VOID SPACE AND THROUGH CEILING OF PL-1 AREA AND OUTSIDE TO NEW DISTRIBUTION. RUN FEEDER FOR NEW PANEL. PROVIDE SIGNAL TO METASYS TO INDICATE UPS ON BATTERY POWER.
 4. PROVIDE NEW PAD MOUNTED W.P. GENSET. PROVIDE 2438x3048 [8' x 10'] REINFORCED CONCRETE PAD. RUN FEEDER FROM GENERATOR UNDERGROUND IN A TRENCH TO NEW STAIRWELL AND THROUGH WALL, THEN DOWN TO NEW DISTRIBUTION. PROVIDE WATER-TIGHT SEAL AT WALL, PENETRATE ABOVE GRADE. PROVIDE TWO 25mm [1"] PVC CONDUITS WITH FEED. ONE FOR BLOCK HEATER & BATTERY CHARGING CIRCUITS (PANEL EM-208-1) AND ONE FOR GENSET ALARM/CONTROL. PROVIDE A LOCAL DUPLEX RECEPTACLE NEAR THE GENSET.

0 23/10/06	ISSUED FOR TENDER	
NO.	D / M / Y	DESCRIPTION
		BY

REVISIONS / ISSUE	
A	A. SECTION LETTER OR DETAIL NUMBER IS DRAWN
B	B. DRAWING WHERE SECTION OR DETAIL WAS INDICATED
	OR DRAWING WHERE SECTION OR DETAIL WAS INDICATED
	- SECTION OR DETAIL SHOWN ON SAME DRAWING

KGS GROUP CONSULTING ENGINEERS & PROJECT MANAGERS
 WINNIPEG (204) 896-1209
 THUNDER BAY (807) 345-2233

CLIENT: **CITY OF WINNIPEG**
 PUBLIC WORKS DEPARTMENT

PROJECT: **INSTALLATION OF EMERGENCY GENERATOR AT PAN-AM POOL - 25 POSEIDON BAY**
 TENDER No. 663-2006

DWG. DESCRIPTION: **ELECTRICAL POOL LEVEL**

ENG. STAMP	DESIGNED BY: AP	DRAWN BY: GCN
	CHECKED:	CHECKED:
APPROVED:		
SCALE: AS NOTED	DATE: OCT/2006	
KGS DWG. NO. 06-0107-08	E3	

CLIENT DWG. NO. 663-P-E03
 REV: 0

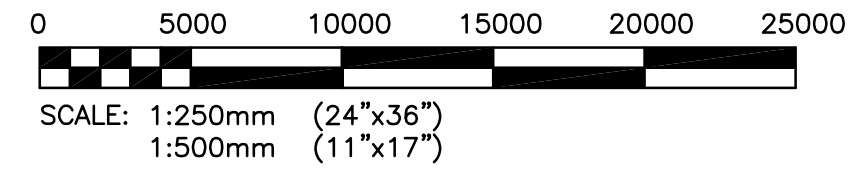

APEGM
 Certificate of Authorization
 KGS Group
 No. 245 Expiry: April 30, 2007

