

NOTES:
 1. CONTRACTOR TO VERIFY LIMITS OF SEWER REPAIRS PRIOR TO EXCAVATION BY MEANS OF VIDEO INSPECTION.
 2. CONTRACTOR TO PROVIDE VIDEO INSPECTION OF SEWER SERVICES WITHIN LIMITS OF REPAIR IN PRESENCE OF CONTRACT ADMINISTRATOR TO DETERMINE IF SERVICE RENEWAL IS REQUIRED.

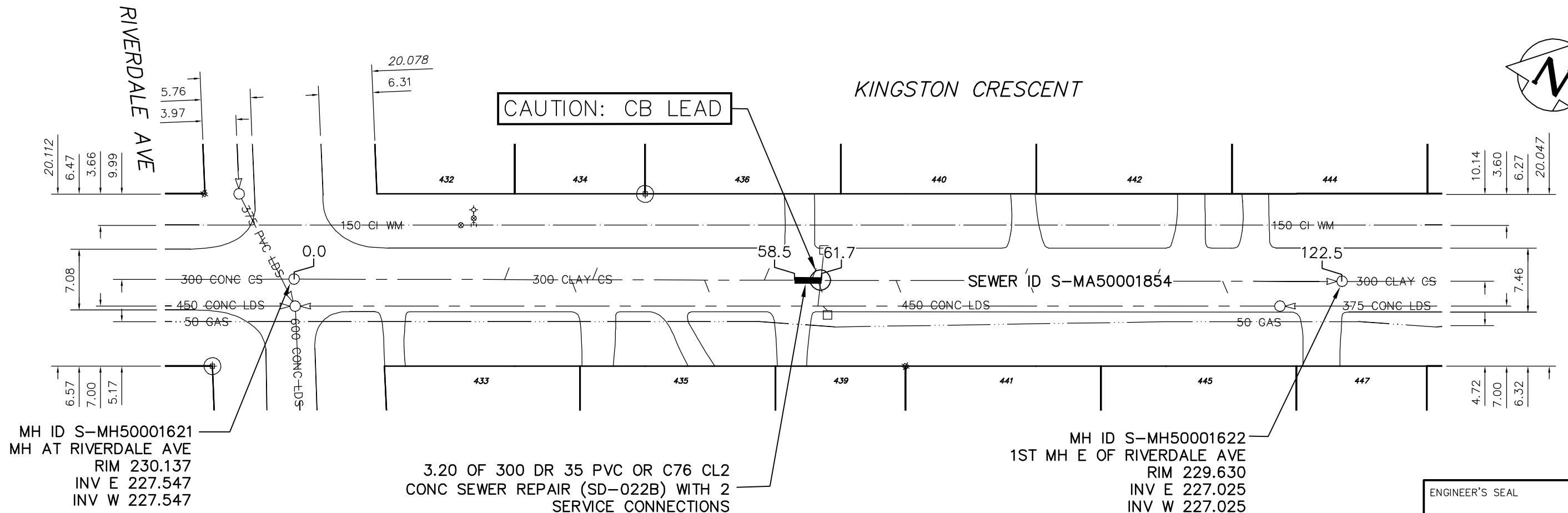

MH ID S-MH50001621
 MH AT RIVERDALE AVE
 RIM 230.137
 INV E 227.547
 INV W 227.547

3.20 OF 300 DR 35 PVC OR C76 CL2
 CONC SEWER REPAIR (SD-022B) WITH 2
 SERVICE CONNECTIONS

MH ID S-MH50001622
 1ST MH E OF RIVERDALE AVE
 RIM 229.630
 INV E 227.025
 INV W 227.025

SEWER JUNCTION INFORMATION FROM SEWER VIDEO INSPECTION S-MA50001854				
DISTANCE FROM MH ID S-MH50001621				
60.50	E	150Ø	NORTH	CB LEAD?
61.20	E	150Ø	SOUTH	CB LEAD?

SEWER SERVICE INFORMATION		
ADDRESS	SIZE	PT. DIST. JUNCTION TIE
- KINGSTON CR RESIDENTIAL	-	-

ENGINEER'S SEAL

ORIGINAL SIGNED BY
 K.R. ZUREK
 10/20/06

BID OPPORTUNITY No: 638-2006
 FILENAME : 05976.dwg
 PLOT DATE : 2006 10 23

LEGEND:
 52.0 | MEASUREMENT TO REPAIR FROM REFERENCE MH SHOWN THUS...

METRIC
 WHOLE NUMBERS INDICATE MILLIMETRES
 DECIMALIZED NUMBERS INDICATE METRES

B.M. ELEV.	FIELD BOOK #:	CITY OF WINNIPEG WATER AND WASTE ENGINEERING DIVISION		THE CITY OF WINNIPEG WATER AND WASTE DEPARTMENT	
POSTED TO LIS		DESIGNED BY: NC	CHECKED BY: TW	2006 COMBINED SEWER RENEWALS AND SEWER REPAIRS	
		DRAWN BY: CJH	APPROVED BY: KZ	KINGSTON CRESCENT (S LEG)	
		HOR. SCALE: 1:500	RELEASED FOR CONSTRUCTION	MH AT RIVERDALE AVENUE TO 1ST MH E OF RIVERDALE AVENUE	
NO.	REVISIONS	DATE	BY	DATE	2006 10 20
				SHEET 10 OF 17	
				CITY DRAWING NUMBER 05976	