

SEWER JUNCTION INFORMATION FROM SEWER VIDEO INSPECTION S-MA60008818

DISTANCE FROM MH S-MH60007231		
15.30	E	150
16.60	E	150
17.10	E	150
24.10	E	150
24.60	E	150
32.40	E	150
33.00	E	150
39.80	E	150
40.40	E	150
47.40	E	150
48.00	E	150
54.30	E	150
54.90	E	150
55.60	E	150
62.40	E	150
63.00	E	150
70.00	E	150
70.60	E	150
77.70	E	150
78.20	E	150
83.50	E	150
84.10	E	150

SEWER SERVICE INFORMATION

ADDRESS	SIZE	€ DIST	JUNCTION TIE
171 MORLEY AVE RESIDENTIAL	150	-	3.34 E OF WL
173 MORLEY AVE RESIDENTIAL	150	-	6.80 E 1ST MH E OF HAY
174 MORLEY AVE RESIDENTIAL	150	-	1.93 E OF WL #71
175 MORLEY AVE RESIDENTIAL	150	-	2.91 W 1ST MH E OF HAY
176 MORLEY AVE RESIDENTIAL	150	-	2.63 W OF EL
177 MORLEY AVE RESIDENTIAL	150	-	7.50 E 1ST MH E OF HAY
178 MORLEY AVE RESIDENTIAL	150	-	1.0 W OF EL
179 MORLEY AVE RESIDENTIAL	150	-	8.71 W 1ST MH E OF HAY
180 MORLEY AVE RESIDENTIAL	150	-	4.29 E OF WL
181 MORLEY AVE RESIDENTIAL	150	-	8.12 W 1ST MH E OF HAY
182 MORLEY AVE RESIDENTIAL	150	-	5.50 W OF EL
183 MORLEY AVE RESIDENTIAL	150	-	16.41 W 1ST MH E OF HAY
184 MORLEY AVE RESIDENTIAL	150	-	0.62 W OF EL
185 MORLEY AVE RESIDENTIAL	150	-	15.81 W 1ST MH E OF HAY
186 MORLEY AVE RESIDENTIAL	150	-	1.15 E OF WL #83
187 MORLEY AVE RESIDENTIAL	150	-	24.01 W 1ST MH E OF HAY
188 MORLEY AVE RESIDENTIAL	150	-	0.83 W OF EL
189 MORLEY AVE RESIDENTIAL	150	-	23.41 W 1ST MH E OF HAY
190 MORLEY AVE RESIDENTIAL	150	-	0.31 W OF EL
191 MORLEY AVE RESIDENTIAL	150	-	31.51 W 1ST MH E OF HAY
192 MORLEY AVE RESIDENTIAL	150	-	2.17 W OF EL
193 MORLEY AVE RESIDENTIAL	150	-	32.11 W 1ST MH E OF HAY
194 MORLEY AVE RESIDENTIAL	150	-	3.29 W OF EL
195 MORLEY AVE RESIDENTIAL	150	-	48.00 E MH AT HAY
196 MORLEY AVE RESIDENTIAL	150	-	3.59 W OF EL
197 MORLEY AVE RESIDENTIAL	150	-	40.40 E MH AT HAY
198 MORLEY AVE RESIDENTIAL	150	-	4.32 W OF EL
199 MORLEY AVE RESIDENTIAL	150	-	47.40 E MH AT HAY
200 MORLEY AVE RESIDENTIAL	150	-	2.83 W OF EL
201 MORLEY AVE RESIDENTIAL	150	-	33.00 E MH AT HAY
202 MORLEY AVE RESIDENTIAL	150	-	3.00 W OF EL
203 MORLEY AVE RESIDENTIAL	150	-	39.80 E MH AT HAY
204 MORLEY AVE RESIDENTIAL	150	-	2.00 W OF EL
205 MORLEY AVE RESIDENTIAL	150	-	24.80 E OF MH AT HAY
206 MORLEY AVE RESIDENTIAL	150	-	3.76 W OF EL
207 MORLEY AVE RESIDENTIAL	150	-	32.40 E OF MH AT HAY
208 MORLEY AVE RESIDENTIAL	150	-	2.49 W OF EL
209 MORLEY AVE RESIDENTIAL	150	-	17.10 E OF MH AT HAY
210 MORLEY AVE RESIDENTIAL	150	-	2.32 E OF WL
211 MORLEY AVE RESIDENTIAL	150	-	24.10 E MH AT HAY
212 MORLEY AVE RESIDENTIAL	150	-	3.57 E OF WL
213 MORLEY AVE RESIDENTIAL	150	-	16.60 E MH AT HAY

- CONSTRUCTION NOTES:**
- SEWER TO BE RENEWED BY TRENCHLESS METHODS.
 - CONFIRM THE LOCATION OF ALL SEWER SERVICES WITHIN LIMITS OF RENEWAL.
 - RENEW SEWER SERVICES TO R.
 - BACKFILL UNDER PAVEMENT, IN SIDEWALKS, & WITHIN 1.0 m OF PAVEMENT TO BE CLASS 3.
 - BACKFILL IN BOULEVARD TO BE CLASS 5.
 - SEWER SERVICES TO BE INSTALLED AT A MINIMUM 1.0% SLOPE.
 - SEWER SERVICE RISERS TO BE INSTALLED WHEN COMBINED SEWER EXCEEDS 4.25 m IN DEPTH.
 - INSTALL TEE, INCLUDING, RISERS AND PLUG, FOR FUTURE SERVICE CONNECTIONS OF EXISTING WYE'D SERVICES AS SHOWN ON DRAWINGS OR AS DIRECTED BY THE CONTRACT ADMINISTRATOR.

NOTE: CHAINAGES SHOWN ARE ALONG N R OF BARTLET AVE.

WATER SERVICE INFORMATION

ADDRESS	SIZE(mm) & TYPE (STREET) (PROP)	SHORT & LONG MEASUREMENT	CORP. LOCATION	REMARKS
171 MORLEY AVE RESIDENTIAL	16 LEAD	77.80 EEL HAY	1.2 E OF S/C	DBL W/173
173 MORLEY AVE RESIDENTIAL	16 LEAD	77.80 EEL HAY	1.2 E OF S/C	DBL W/171
174 MORLEY AVE RESIDENTIAL	20 COPPER	81.56 EEL HAY	OPP S/C	-
175 MORLEY AVE RESIDENTIAL	20 COPPER	68.88 EEL HAY	0.75 W OF S/C	-
176 MORLEY AVE RESIDENTIAL	20 COPPER	64.68 EEL HAY	0.6 W OF S/C	-
177 MORLEY AVE RESIDENTIAL	16 COPPER	54.95 EEL HAY	OPP S/C	DBL W/183
178 MORLEY AVE RESIDENTIAL	12 LEAD	59.44 EEL HAY	1.2 W OF S/C	-
179 MORLEY AVE RESIDENTIAL	16 LEAD	54.95 EEL HAY	OPP S/C	DBL W/181
180 MORLEY AVE RESIDENTIAL	12 COPPER	51.93 EEL HAY	0.3 W OF S/C	-
181 MORLEY AVE RESIDENTIAL	20 COPPER	44.82 EEL HAY	0.3 W OF S/C	-
182 MORLEY AVE RESIDENTIAL	12 LEAD	42.40 EEL HAY	OPP S/C	-
183 MORLEY AVE RESIDENTIAL	20 COPPER	34.48 EEL HAY	OPP S/C	-
184 MORLEY AVE RESIDENTIAL	12 LEAD	26.37 EEL HAY	0.6 W OF S/C	-
185 MORLEY AVE RESIDENTIAL	20 COPPER	33.26 EEL HAY	0.6 E OF S/C	-
186 MORLEY AVE RESIDENTIAL	12 LEAD	19.35 EEL HAY	1.8 E OF S/C	-
187 MORLEY AVE RESIDENTIAL	20 COPPER	12.56 EEL HAY	OPP S/C	-
188 MORLEY AVE RESIDENTIAL	20 COPPER	18.90 EEL HAY	OPP S/C	-
189 MORLEY AVE RESIDENTIAL	20 COPPER	4.51 EEL HAY	1.7 W OF S/C	-
190 MORLEY AVE RESIDENTIAL	20 COPPER	9.70 EEL HAY	1.2 E OF S/C	-
191 MORLEY AVE RESIDENTIAL	20 COPPER	3.05 EEL HAY	0.3 E OF S/C	-

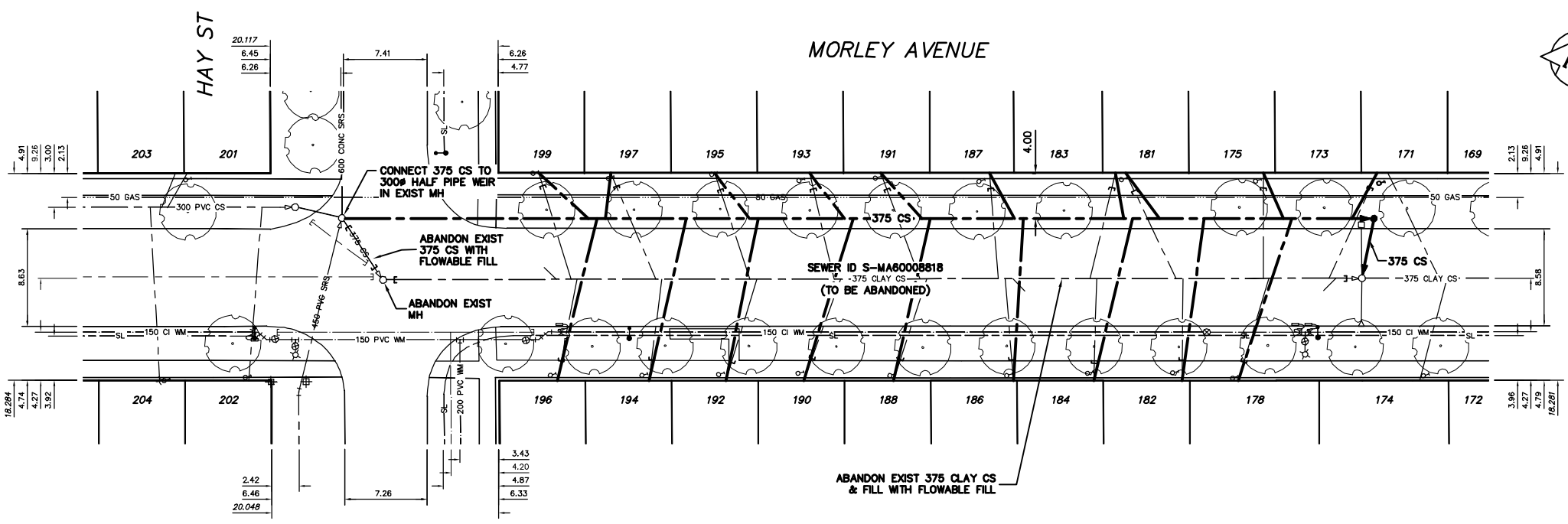

METRIC
WHOLE NUMBERS INDICATE MILLIMETRES
DECIMALIZED NUMBERS INDICATE METRES

WARNING
IF POWER EQUIPMENT OR EXPLOSIVES ARE TO BE USED FOR EXCAVATION ON THIS PROJECT THE CONTRACTOR MUST:
1) NOTIFY THE GAS COMPANY OF THE PROPOSED LOCATION OF EXCAVATION.
2) TAKE PRECAUTION TO AVOID DAMAGE TO GAS COMPANY INSTALLATIONS.
SEE PROVINCIAL REGULATION 210/72 FOR DETAILS

<table border="1"> <tr><td>200 WM</td><td>WATERMAIN</td><td>200 WM</td><td>SL, HYDRO</td><td>150 WM</td><td>WATERMAIN</td><td>150 WM</td></tr> <tr><td>⊕</td><td>HYDRANT</td><td>⊕</td><td>MTS</td><td>⊕</td><td>HYDRANT</td><td>⊕</td></tr> <tr><td>⊙</td><td>VALVE</td><td>⊙</td><td>TRAFFIC SIGNALS</td><td>⊙</td><td>VALVE</td><td>⊙</td></tr> <tr><td>525 LDS</td><td>LAND DRAINAGE SEWER</td><td>525 LDS</td><td>GAS</td><td>50 GAS</td><td>300 LDS</td><td>LAND DRAINAGE SEWER</td></tr> <tr><td>375 WWS</td><td>WASTEWATER SEWER</td><td>375 WWS</td><td>SURVEY BAR</td><td>250 WWS</td><td>250 WWS</td><td>WASTEWATER SEWER</td></tr> <tr><td>○</td><td>MANHOLE</td><td>○</td><td>FENCE</td><td>⊕</td><td>PROFILE</td><td>⊕</td></tr> <tr><td>□</td><td>CATCH BASIN</td><td>□</td><td>POLE - HYDRO, MTS</td><td>⊕</td><td>GROUND ABOVE PIPE</td><td>⊕</td></tr> <tr><td>▽</td><td>CURB INLET</td><td>▽</td><td>CURB STOP</td><td>⊕</td><td>? DITCH (NORTH & WEST)</td><td>⊕</td></tr> <tr><td>⊕</td><td>JUNCTIONS</td><td>⊕</td><td>GUY ANCHOR</td><td>⊕</td><td>? DITCH (SOUTH & EAST)</td><td>⊕</td></tr> <tr><td>⊕</td><td>CULVERT</td><td>⊕</td><td>LIGHT STANDARD</td><td>⊕</td><td>GUTTER (NORTH & WEST)</td><td>⊕</td></tr> <tr><td>⊕</td><td>ANODE</td><td>⊕</td><td>TREE</td><td>⊕</td><td>GUTTER (SOUTH & EAST)</td><td>⊕</td></tr> <tr><td>EXISTING</td><td>LEGEND-PLAN</td><td>PROPOSED</td><td>EXISTING</td><td>LEGEND-PLAN</td><td>PROPOSED</td><td>EXISTING</td></tr> </table>	200 WM	WATERMAIN	200 WM	SL, HYDRO	150 WM	WATERMAIN	150 WM	⊕	HYDRANT	⊕	MTS	⊕	HYDRANT	⊕	⊙	VALVE	⊙	TRAFFIC SIGNALS	⊙	VALVE	⊙	525 LDS	LAND DRAINAGE SEWER	525 LDS	GAS	50 GAS	300 LDS	LAND DRAINAGE SEWER	375 WWS	WASTEWATER SEWER	375 WWS	SURVEY BAR	250 WWS	250 WWS	WASTEWATER SEWER	○	MANHOLE	○	FENCE	⊕	PROFILE	⊕	□	CATCH BASIN	□	POLE - HYDRO, MTS	⊕	GROUND ABOVE PIPE	⊕	▽	CURB INLET	▽	CURB STOP	⊕	? DITCH (NORTH & WEST)	⊕	⊕	JUNCTIONS	⊕	GUY ANCHOR	⊕	? DITCH (SOUTH & EAST)	⊕	⊕	CULVERT	⊕	LIGHT STANDARD	⊕	GUTTER (NORTH & WEST)	⊕	⊕	ANODE	⊕	TREE	⊕	GUTTER (SOUTH & EAST)	⊕	EXISTING	LEGEND-PLAN	PROPOSED	EXISTING	LEGEND-PLAN	PROPOSED	EXISTING	<p>LOCATION APPROVED UNDERGROUND STRUCTURES</p> <p>DATE: _____</p> <p>NOTE: LOCATION OF UNDERGROUND STRUCTURES AS SHOWN ARE BASED ON THE BEST INFORMATION AVAILABLE BUT NO GUARANTEE IS GIVEN THAT ALL EXISTING UTILITIES ARE SHOWN OR THAT THE GIVEN LOCATIONS ARE EXACT. CONFIRMATION OF EXISTENCE AND EXACT LOCATION OF ALL SERVICES MUST BE OBTAINED FROM THE INDIVIDUAL UTILITIES BEFORE PROCEEDING WITH CONSTRUCTION.</p>	<p>B.M. ELEV. _____</p> <p>FIELD BOOK # _____</p> <p>POSTED TO LBS _____</p>	<p>CITY OF WINNIPEG WATER AND WASTE ENGINEERING DIVISION</p> <p>DESIGNED BY: SC CHECKED BY: TW</p> <p>DRAWN BY: CJH APPROVED BY: KZ</p> <p>HOR. SCALE: 1:250 VERTICAL: 1:50</p> <p>RELEASED FOR CONSTRUCTION: _____</p> <p>NO. REVISIONS _____ DATE BY DATE</p>	<p>ENGINEER'S SEAL</p> <p>ORIGINAL SIGNED BY S.R.J. COURNOYER 06/08/31</p> <p>BID OPPORTUNITY: 540-2006 FILENAME: 05928.dwg PLOT DATE: 2006 08 31</p>	<p>THE CITY OF WINNIPEG WATER AND WASTE DEPARTMENT</p> <p>2006 COMBINED SEWER RENEWALS AND SEWER REPAIRS MORLEY AVENUE MH AT Q HAY STREET TO 1ST MH E OF HAY STREET</p> <p>SHEET 5 OF 11 CITY DRAWING NUMBER 05928</p>
200 WM	WATERMAIN	200 WM	SL, HYDRO	150 WM	WATERMAIN	150 WM																																																																																			
⊕	HYDRANT	⊕	MTS	⊕	HYDRANT	⊕																																																																																			
⊙	VALVE	⊙	TRAFFIC SIGNALS	⊙	VALVE	⊙																																																																																			
525 LDS	LAND DRAINAGE SEWER	525 LDS	GAS	50 GAS	300 LDS	LAND DRAINAGE SEWER																																																																																			
375 WWS	WASTEWATER SEWER	375 WWS	SURVEY BAR	250 WWS	250 WWS	WASTEWATER SEWER																																																																																			
○	MANHOLE	○	FENCE	⊕	PROFILE	⊕																																																																																			
□	CATCH BASIN	□	POLE - HYDRO, MTS	⊕	GROUND ABOVE PIPE	⊕																																																																																			
▽	CURB INLET	▽	CURB STOP	⊕	? DITCH (NORTH & WEST)	⊕																																																																																			
⊕	JUNCTIONS	⊕	GUY ANCHOR	⊕	? DITCH (SOUTH & EAST)	⊕																																																																																			
⊕	CULVERT	⊕	LIGHT STANDARD	⊕	GUTTER (NORTH & WEST)	⊕																																																																																			
⊕	ANODE	⊕	TREE	⊕	GUTTER (SOUTH & EAST)	⊕																																																																																			
EXISTING	LEGEND-PLAN	PROPOSED	EXISTING	LEGEND-PLAN	PROPOSED	EXISTING																																																																																			