

L = 370m W = 7.2m A = 2664m²
TYPE - RECONSTRUCTION

CONSTRUCTION NOTES:

1. CONTRACTOR SHALL TAKE PRECAUTIONARY STEPS TO AVOID DAMAGE FROM CONSTRUCTION ACTIVITIES TO EXISTING BOULEVARDS AND TREES WITHIN THE LIMITS OF CONSTRUCTION.
2. LOCATION OF EXISTING SERVICES ARE TO BE CONFIRMED IN THE FIELD BY THE CONTRACTOR.
3. TIE-INS TO BE VERIFIED IN THE FIELD BY THE CONTRACT ADMINISTRATOR.
4. REPLACE ALL 1.2m WIDE SIDEWALK WITH 1.5m SIDEWALK AS PER SD-228A.
5. BOULEVARD REPLACEMENT TO BE FINALIZED IN THE FIELD AS DIRECTED BY THE CONTRACT ADMINISTRATOR.
6. 300mm SUB BASE TO BE ADDED WHERE OVER EXCAVATION IS REQUIRED AS DIRECTED IN THE FIELD BY THE CONTRACT ADMINISTRATOR.
7. CONTRACTOR SHALL BE RESPONSIBLE TO ENSURE RESIDENTS HAVE REMOVED ALL VEHICLES, TRAILERS, ETC. FROM GARAGES/DRIVEWAYS PRIOR TO REMOVAL OF STREET IN FRONT OF RESPECTIVE PROPERTIES.

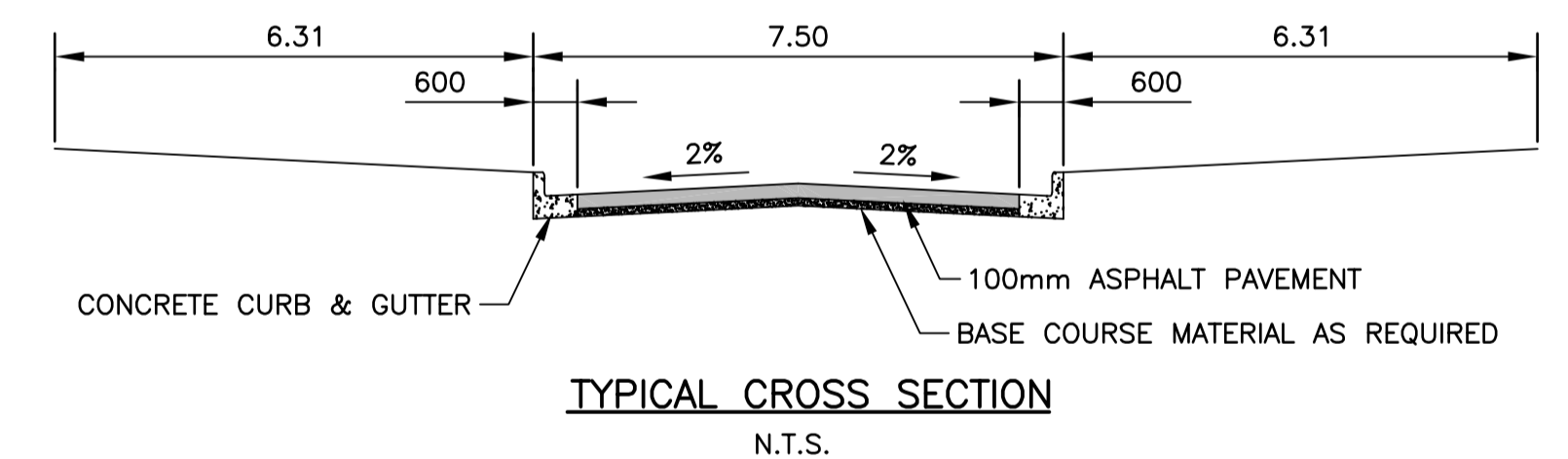
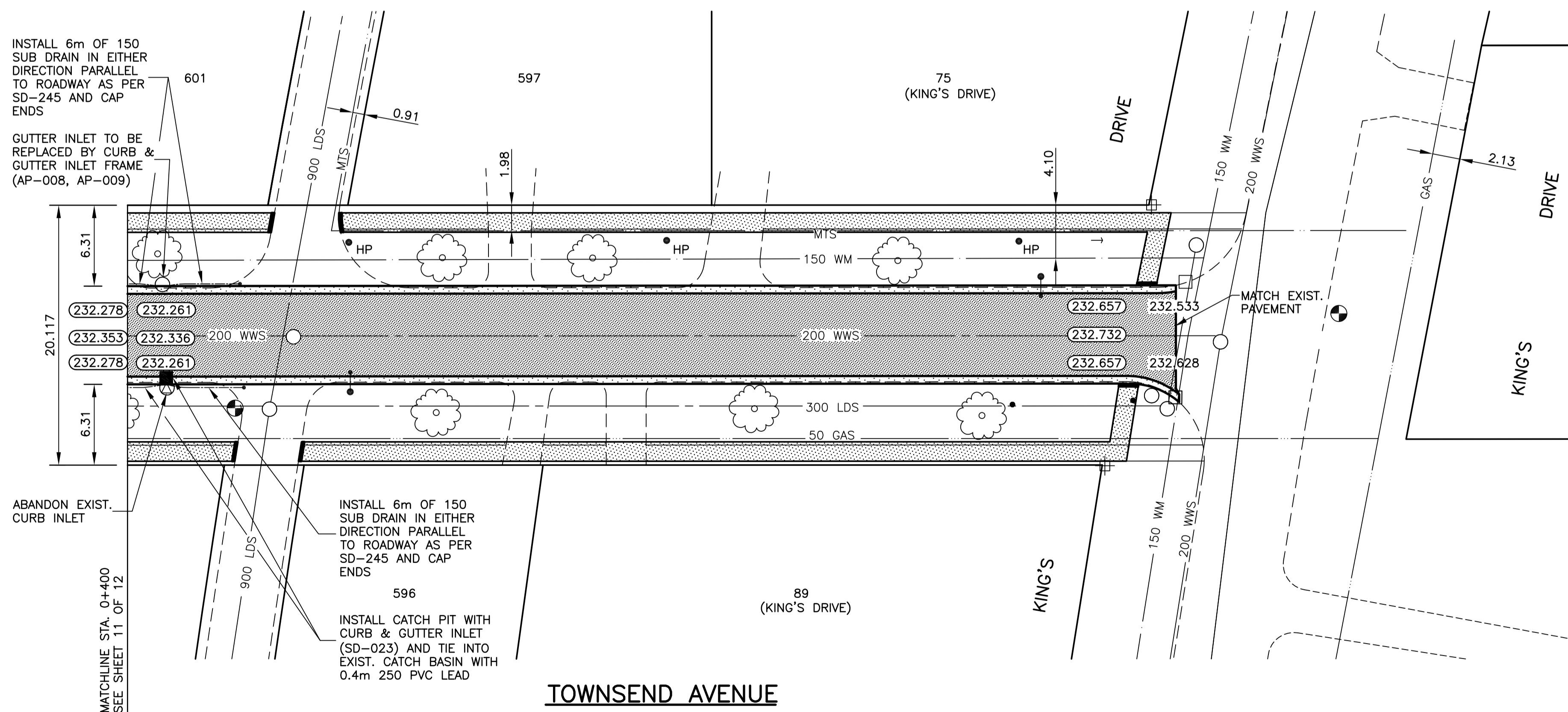

METRIC
WHOLE NUMBERS INDICATE MILLIMETRES
DECIMALIZED NUMBERS INDICATE METRES

WARNING

- IF POWER EQUIPMENT OR EXPLOSIVES ARE TO BE USED FOR EXCAVATION ON THIS PROJECT THE CONTRACTOR MUST:
1. NOTIFY THE GAS COMPANY OF THE PROPOSED LOCATION OF EXCAVATION.
 2. TAKE PRECAUTION TO AVOID DAMAGE TO GAS COMPANY INSTALLATIONS SEE PROVINCIAL REGULATION 210/72 FOR DETAILS

| | | | | | | |
|---------------|--------------------------|---------------|--------------------------|---------------|--------------------------|---------------|
| 150 mm W.M. | WATERMAIN | 150 mm W.M. | HYDRO | 150 mm W.M. | WATERMAIN | 150 mm W.M. |
| Hydrant Valve | CONCRETE ASPHALT PLANING | Hydrant Valve | CONCRETE ASPHALT PLANING | Hydrant Valve | CONCRETE ASPHALT PLANING | Hydrant Valve |
| 300 mm L.D.S. | LAND DRAINAGE SEWER | 300 mm L.D.S. | LAND DRAINAGE SEWER | 300 mm L.D.S. | LAND DRAINAGE SEWER | 300 mm L.D.S. |
| 250 mm W.W.S. | WASTE WATER SEWER | 250 mm W.W.S. | WASTE WATER SEWER | 250 mm W.W.S. | WASTE WATER SEWER | 250 mm W.W.S. |
| Manhole | MANHOLE | Manhole | MANHOLE | Manhole | MANHOLE | Manhole |
| Catch Basin | CATCH BASIN | Catch Basin | CATCH BASIN | Catch Basin | CATCH BASIN | Catch Basin |
| Curb Inlet | CURB INLET | Curb Inlet | CATCH BASIN | Curb Inlet | CATCH BASIN | Curb Inlet |
| Junctions | JUNCTIONS | Junctions | PROPERTY LINE | Junctions | PROPERTY LINE | Junctions |
| Culvert | CULVERT | Culvert | SURVEY BAR | Culvert | SURVEY BAR | Culvert |
| Gas | GAS | Gas | PARAPLEGIC RAMP | Gas | PARAPLEGIC RAMP | Gas |
| EXISTING | LEGEND-PLAN | PROPOSED | LEGEND-PLAN | PROPOSED | LEGEND-PROFILE | PROPOSED |

UNDERGROUND STRUCTURES
ORIGINAL SIGNED BY DERRICK A SAEDA 04/5/06
SUPPLY U/G STRUCTURES COMMITTEE DATE

NOTE:
LOCATION OF UNDERGROUND STRUCTURES AS SHOWN ARE BASED ON THE BEST INFORMATION AVAILABLE. BUT NO GUARANTEE IS GIVEN THAT ALL EXISTING UTILITIES ARE SHOWN OR THAT THE GIVEN LOCATIONS ARE EXACT. CONFIRMATION OF EXISTENCE AND EXACT LOCATION OF ALL SERVICES MUST BE OBTAINED FROM THE INDIVIDUAL UTILITIES BEFORE PROCEEDING WITH CONSTRUCTION.

| | |
|----------------------------|--------------------------------------|
| B.M. ELEV. | 77-027 232.144 |
| DESIGNED BY | T. PETERS |
| DRAWN BY | J. MORRIS |
| CHECKED BY | D. KRAHN |
| APPROVED BY | ORIGINAL SIGNED BY D. KRAHN, P.Eng. |
| HOR. SCALE | 1:250 |
| VERTICAL | 1:10 |
| RELEASSED FOR CONSTRUCTION | ORIGINAL SIGNED BY KEN TURKO, C.E.T. |
| DATE | APRIL 12, 2006 |

| | | | |
|-----|-------------------|----------|--------|
| NO. | REVISIONS | DATE | BY |
| 2 | ISSUED FOR TENDER | 04/12/06 | T.J.P. |
| 1 | ISSUED FOR REVIEW | 01/31/06 | T.J.P. |

DILLON CONSULTING

ENGINEER'S SEAL
PROVINCE OF MANITOBA
ORIGINAL STAMPED BY
T.J. PETERS
04/12/06
REGISTERED PROFESSIONAL ENGINEER

THE CITY OF WINNIPEG
PUBLIC WORKS DEPARTMENT

2006 RESIDENTIAL STREET RENEWAL PROGRAM

TOWNSEND AVENUE
AURORA ST. TO KING'S DR.
STA. 0+400 TO KING'S DR.

CITY DRAWING NUMBER
SHEET 12 OF 12

CONSULTANT PROJECT NO.
05-5439-2000