

FILE NAME:

DATE:

DESCRIPTION:

PROJECT No:

ADDRESS:

NOTES :

### HELIFIX INSTALLATION PROCEDURES

INSTALL HELIFIX STAINLESS STEEL TIES INTO EXTERIOR STONE CLADDING. (DRYFIX TECHNIQUE) AT SPECIFIED SPACING. PATCH ALL PENETRATIONS TO MATCH EXISTING SURFACE USING DOW CORNING 790 SEALANT.

- A 8.0mm ENTRY HOLE SHALL BE PREDRILLED THROUGH THE EXISTING STONE PANEL AND CONTINUOUSLY DRILLED INTO THE PRE-CAST CONCRETE STRUCTURAL BACK-UP TO A HORIZONTAL PENETRATION DEPTH OF NOT LESS THAN 3.00". THIS DRILL PROCEDURE IS TO BE CARRIED OUT BY MEANS OF A HIGH SPEED ELECTRIC HAMMER DRILL (3 JAW CHUCK TYPE).
- NOTE: A DRYFIX SUPPORT TOOL MAY BE REQUIRED WHEN INSTALLING LONGER LENGTHS OF HELIFIX TIE INTO DENSE CONCRETE UNITS.
- THE 10mm HELIFIX 304 STAINLESS STEEL ANCHOR SHALL THEN BE DRIVEN INTO POSITION WITH A HELIFIX 'DRYFIX' POWER TOOL MOUNTED ON AN S.D.S. TYPE CONCRETE HAMMER DRILL AND RECESSED 1/4" FROM THE SURFACE. THE STONE SHALL THEN BE PATCHED AT THE LOCATIONS OF THE PENETRATIONS TO MATCH EXISTING ADJACENT STONE SURFACE AS PER SPECIFICATIONS.
- CONTRACTOR TO OBTAIN ALL RELEVANT DRILL BITS AND SETTING TOOLS FROM HELIFIX CORPORATION OF NORTH AMERICA LIMITED.
- SEE SPECIFICATION REGARDING FURTHER INFORMATION WITH RESPECT TO METHODS AND MATERIALS.

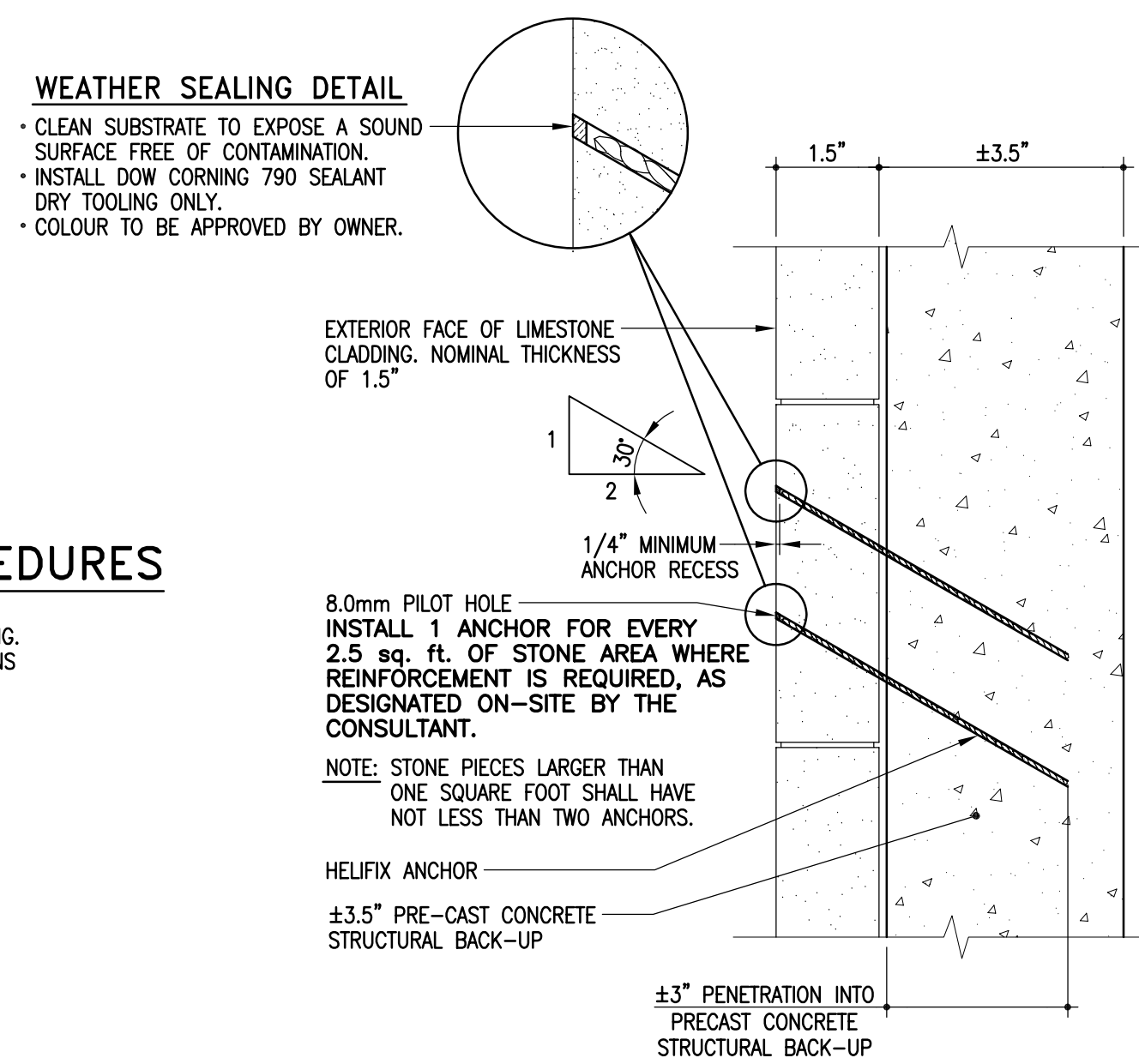

**A** HELIFIX ANCHOR DETAIL  
SK-2 N.T.S. UNIT PRICE

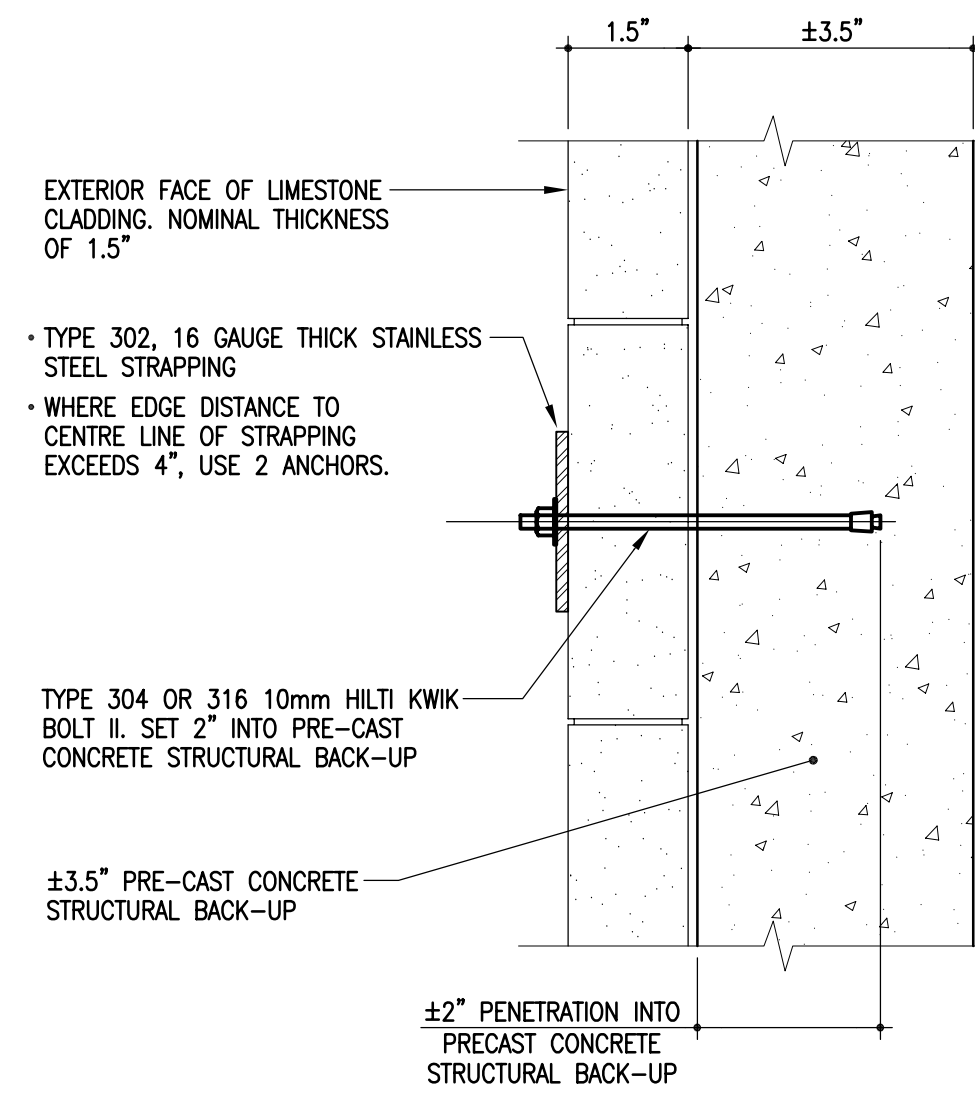

**B** HILTI KWIK BOLT II STRAPPING DETAIL  
SK-2 N.T.S. UNIT PRICE

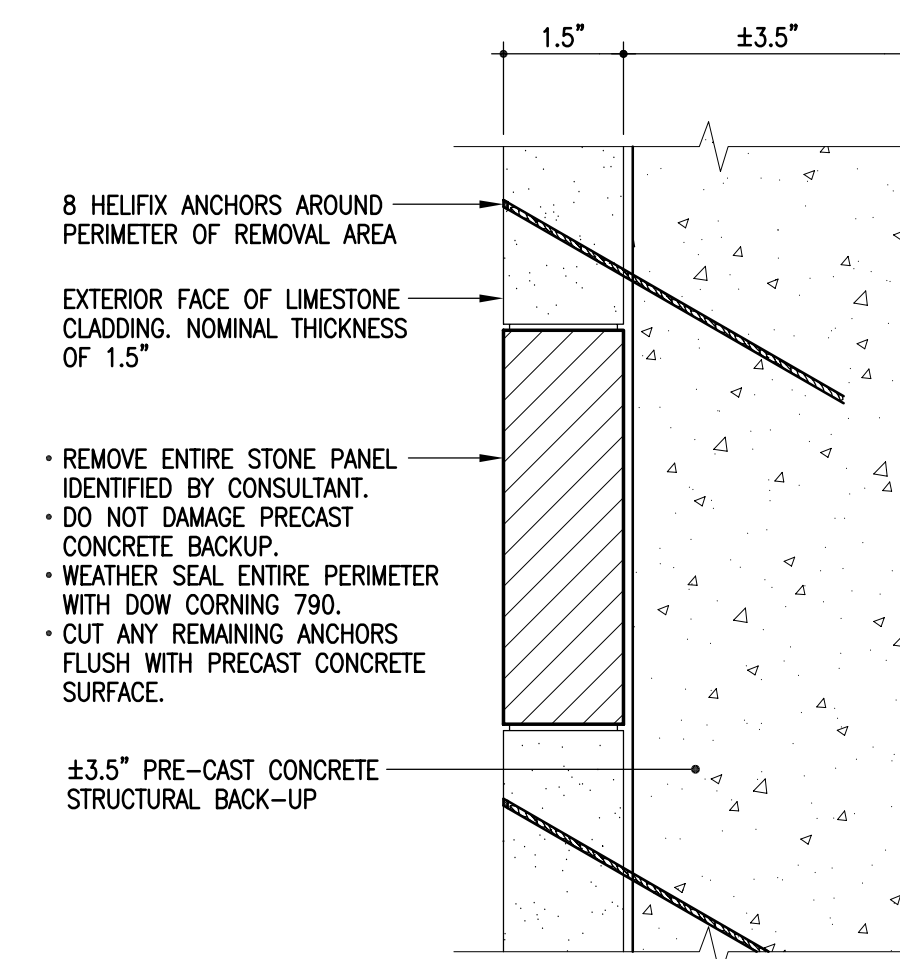

**C** STONE PANEL REMOVAL  
SK-2 N.T.S. UNIT PRICE

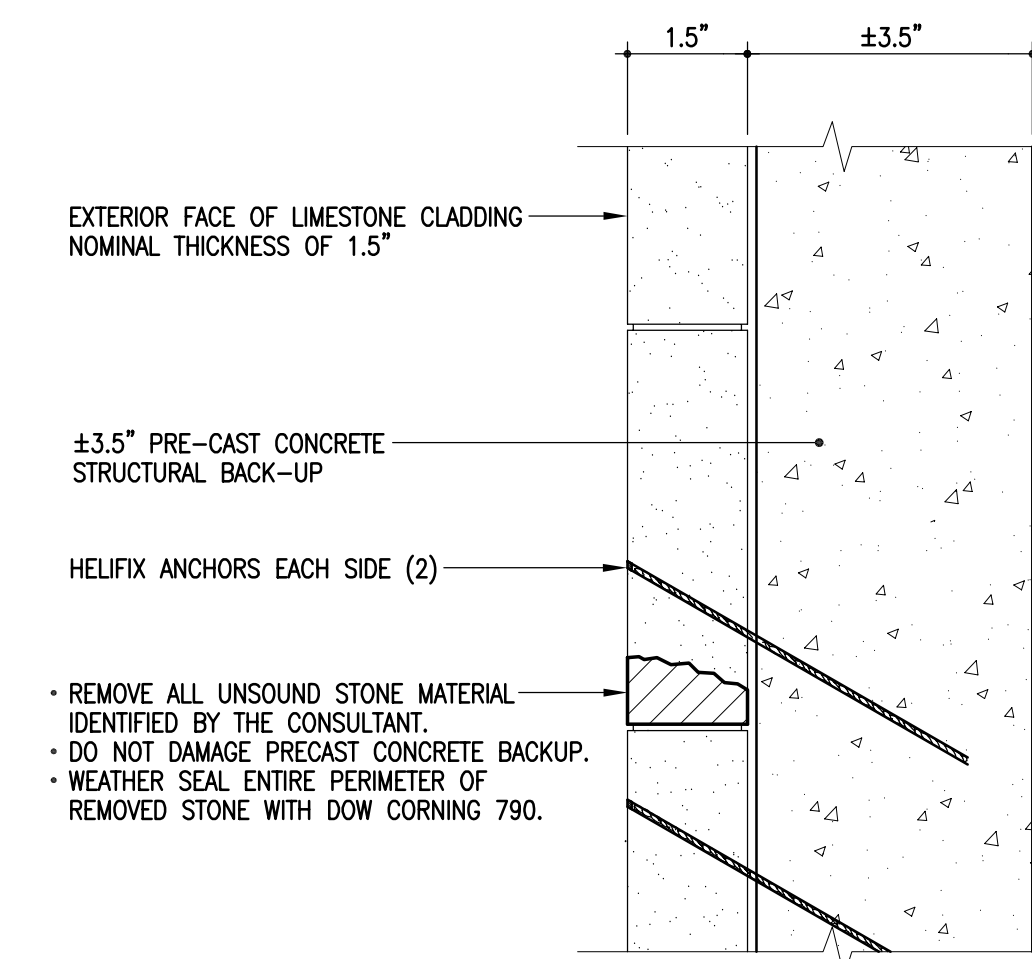

**D** REMOVAL OF SECTIONS OF STONE PANEL  
SK-2 N.T.S. UNIT PRICE

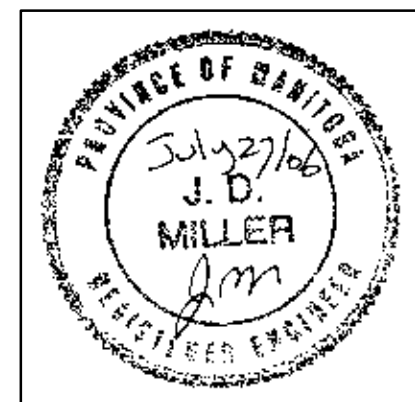

NO.	REVISION/DESCRIPTION	BY	DATE
SEALS			

DRAWN BY	TW	CHECKED BY	APPROVED
DATE	2006.06.20	USER APPROVAL	

**CITY OF WINNIPEG**  
 PLANNING, PROPERTY &  
 DEVELOPMENT DEPARTMENT  
 CIVIC ACCOMMODATIONS DIVISION  
 300 - 65 GARRY ST. R3C 4K4

PROJECT  
**PUBLIC SAFETY BUILDING**  
 151 PRINCESS STREET  
 2006 CLADDING STABILIZATION  
 WINNIPEG, MANITOBA

SHEET TITLE  
**DETAILS AND NOTES**

SCALE	PROJECT NO.	SHEET NO.
AS NOTED	2006-439	SK-2