

1 MAIN FLOOR PLAN - POWER & SYSTEMS
SCALE: 1/4" = 1'-0"

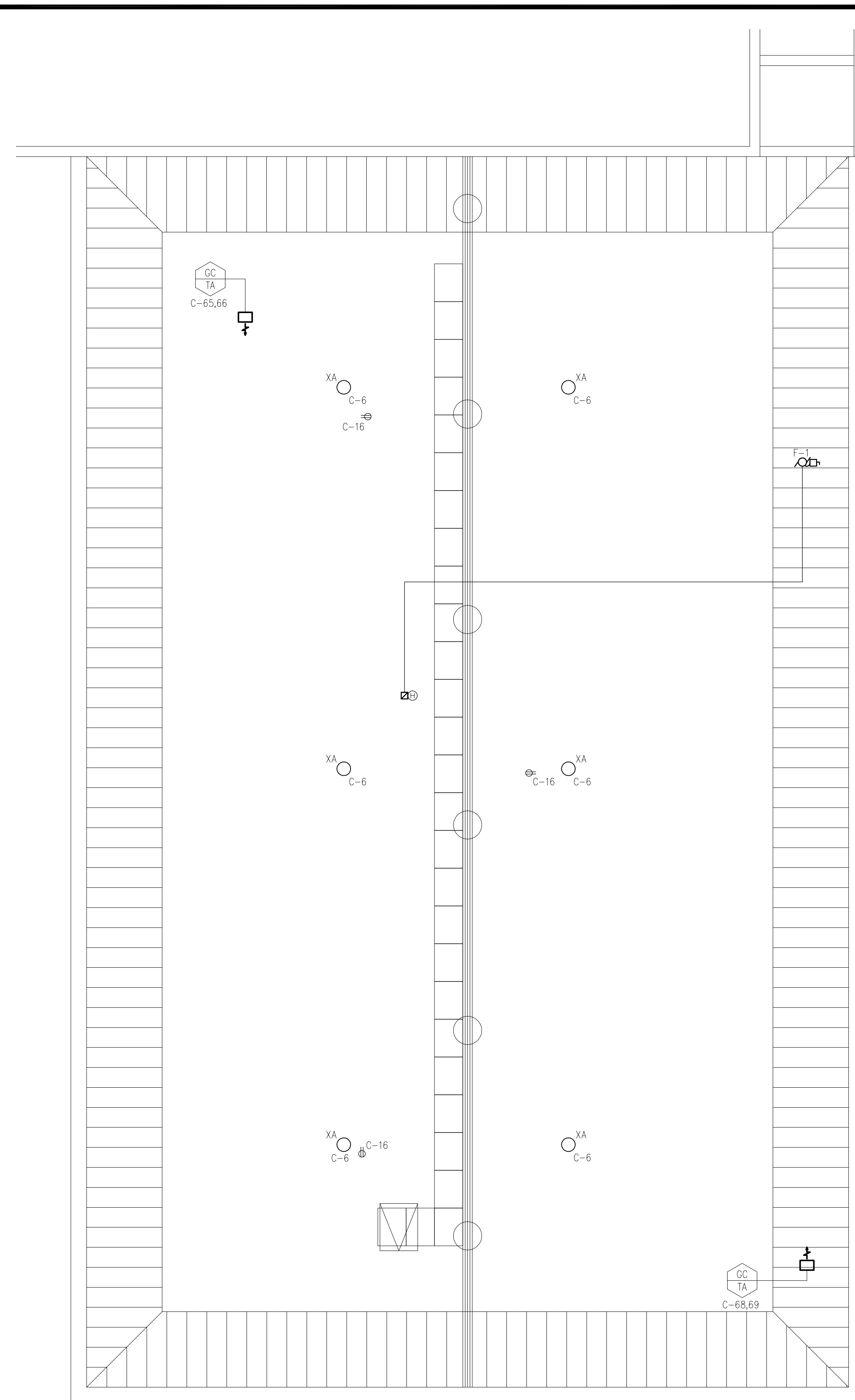

2 CRAWLSPACE PLAN - ELECTRICAL
SCALE: 1/4" = 1'-0"

DRAWING NOTES: ##

- INSTALL NEW WIREMOLD AF1 SERIES RAISED FLOOR BOX C/W DUPLEX PLATE RECEPTACLES, DATA JACKS, MOUNTING STRAPS, ETC. AS REQUIRED. CONFIRM EXACT LOCATION ON SITE WITH CONTRACT ADMINISTRATOR.
- RELOCATE EXISTING ENTRANCE HEATER. EXTEND FEEDER AS REQUIRED.



REV	DESCRIPTION	DATE	BY
2	REVISED FOR TENDER	Jul 26, 2006	LK
1	ISSUED FOR TENDER	May 10, 2006	CM
0	ISSUED FOR 99% REVIEW	May 03, 2006	CM

 Certificate of Authorization SMS Engineering Ltd. No. 166 Expiry: April 30, 2007	ORIGINAL CONTRACT DRAWING SIGNED AND SEALED BY B.D. LESKO, P. ENG MAY 10, 2006
--	--

THIS DRAWING MUST NOT BE SCALED.
 THE CONTRACTOR SHALL VERIFY ALL DIMENSIONS, DATUMS AND LEVELS PRIOR TO COMMENCEMENT OF WORK AND IS HELD RESPONSIBLE FOR REPORTING ANY DISCREPANCY OR OMISSION TO CONTRACT ADMINISTRATOR IMMEDIATELY.
 THIS DRAWING IS THE EXCLUSIVE PROPERTY OF NEIL COOPER ARCHITECT INC. AND CAN BE REPRODUCED ONLY WITH THE PERMISSION OF NEIL COOPER ARCHITECT INC. IN WHICH CASE THE REPRODUCTION MUST BEAR THEIR NAME AS THE ARCHITECTURAL FIRM.

**MAIN FLOOR PLAN
POWER & SYSTEMS &
CRAWLSPACE - ELECTRICAL**

PROJECT:
**ADDITION TO
770 ROSS AVENUE**

Winnipeg, Manitoba

Neil Cooper Architect Inc.
 10-395 Berry Street, Winnipeg, Manitoba R3J 1N6

SMS ENGINEERING
 SMS Engineering Consulting Engineers
 770 Bradford Street Winnipeg MB Canada R3H 1N3
 Telephone 204.775.0291 Fax 204.772.2153
 06-520-01 sms@smseng.com

DRAWN BY: CM	CHECKED BY: BDL	SHEET NO: E3.0R2	REV NO:
DATE: APRIL 18, 2006	FILE: G:\PROJECTS\2006_SP\06520NCA.COW\cadd\M\6520H1.dwg		