

- NOTES:
- REFER TO DWG WY-S0453 FOR CONSTRUCTION SEQUENCE NOTES.
 - CONTRACTOR SHALL NOT CROSS OVER EXISTING 1200Ø OUTLET PIPE WITH HEAVY EQUIPMENT (EXCAVATORS, PILING RIGS, CRANES, ETC). EXCAVATION, SHORING AND PILING TO BE COMPLETED WITH EQUIPMENT LOCATED ON EITHER SIDE OF EXISTING 1200Ø OUTLET PIPE.

EXCAVATION PLAN
1:200

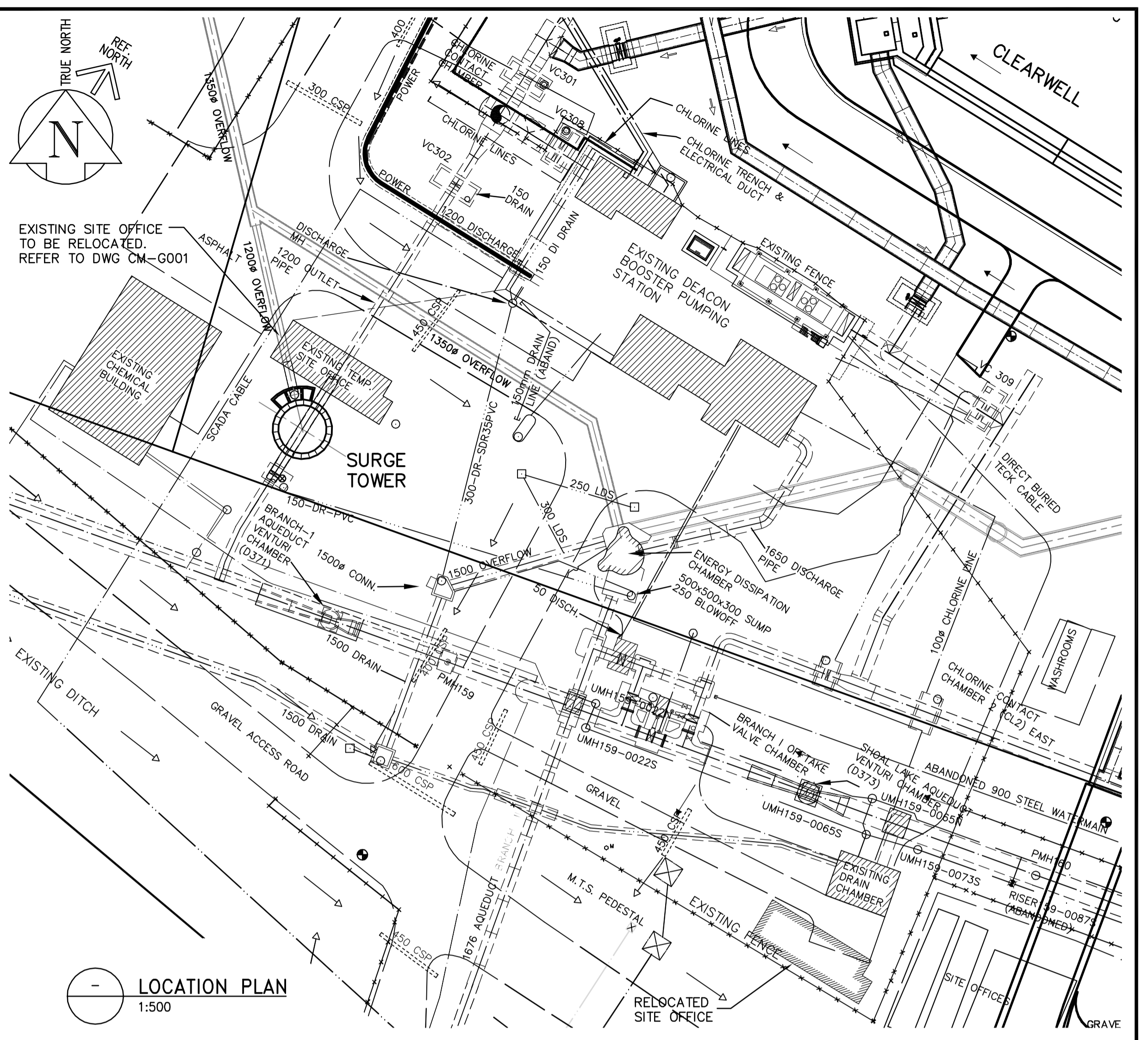

LOCATION PLAN
1:500

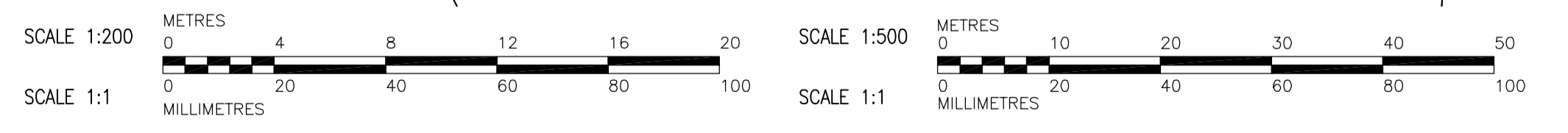

	150 mm W.M. WATERMAIN HYDRANT				LIGHT STANDARD
	300mm L.D.S. LAND DRAINAGE SEWER				POLE
	MANHOLE				RAIL X-ING SIGNAL
	CATCH BASIN				RAILWAY TRACK
	CURB INLET				DITCH
	JUNCTIONS				
	CULVERT				
	GAS				
	EXISTING LEGEND - PLAN		PROPOSED LEGEND - PLAN		EXISTING LEGEND - PLAN
	PROPOSED LEGEND - PLAN		EXISTING LEGEND - PLAN		PROPOSED LEGEND - PLAN

APEGM
Certificate of Authorization
Earth Tech Canada Inc.
No. 730 Expiry: April 30, 2007

B.M. ELEV.					
DESIGNED BY	GGP	CHECKED BY	SRB		
DRAWN BY	LAE/JBC	APPROVED BY	AHL		
SCALE:	AS NOTED	RELEASED FOR CONSTRUCTION BY:	R. SOROKOWSKI		
DATE	2005/11/21	DATE	2006/05/03		
NO. REVISIONS		DATE		BY	
00	ISSUED FOR TENDER	06/05/03		JBC	

CH2M HILL
Frederickson Cooper ARCHITECTS

EarthTech
A Tec International Ltd. Company

ENGINEER'S SEAL
ORIGINAL SIGNED BY
S.R. BILEVICIUS
2006/05/03
CONSULTANT DRAWING NO.
WY-C0100

THE CITY OF WINNIPEG
WATER AND WASTE DEPARTMENT
ENGINEERING DIVISION

WATER TREATMENT PLANT
YARD PIPING AND VALVE CHAMBERS
SURGE TOWER CONSTRUCTION

CIVIL
SITE LOCATION AND
EXCAVATION PLAN

CITY FILE NUMBER
SHEET OF
CITY DRAWING NUMBER
1-0607-A-C0100-001-00D