

1+00 1+25 1+50 1+75 2+00 2+25
NESS AVENUE

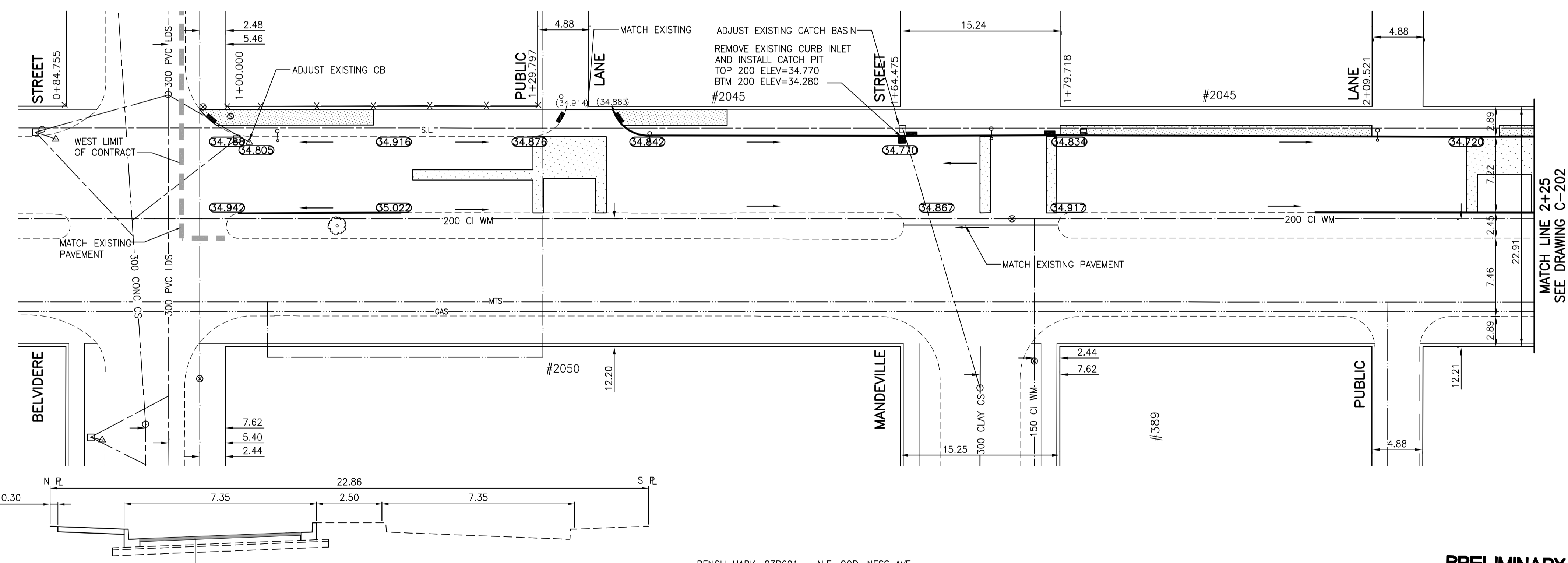

NOTE:
STATIONING ALONG NORTH BACK
OF CURB OF NESS AVENUE



WARNING

IF POWER EQUIPMENT OR EXPLOSIVES ARE TO BE USED FOR EXCAVATION ON THIS PROJECT THE CONTRACTOR MUST:
1) NOTIFY THE GAS COMPANY OF THE PROPOSED LOCATION OF EXCAVATION.
2) TAKE PRECAUTION TO AVOID DAMAGE TO GAS COMPANY INSTALLATIONS.
SEE PROVINCIAL REGULATION 140/92 FOR DETAILS

METRIC

WHOLE NUMBERS INDICATE MILLIMETRES
DECIMALIZED NUMBERS INDICATE METRES

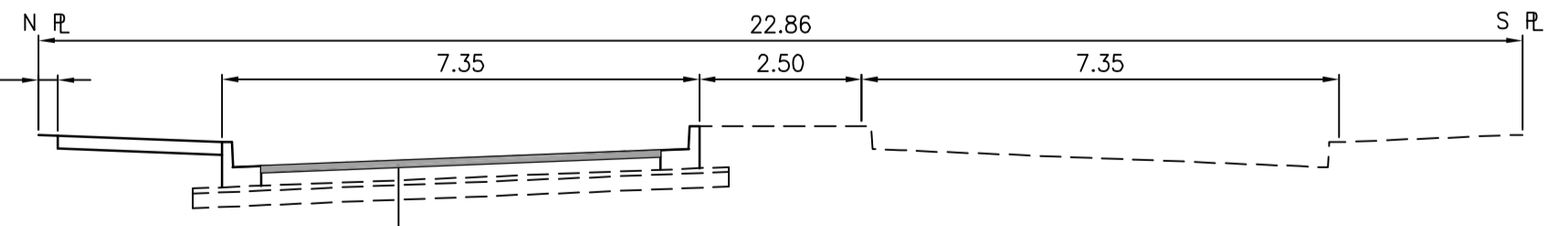

TYPICAL CROSS SECTION

BENCH MARK: 83R621 - N.E. COR. NESS AVE. & WOODLAWN ST., TBLT. ON TOP OF 0.05m DIA. x 2.4m IRON PIPE, ON N.L. OF NESS AVE. & 1.2m W. OF E.L. OF WOODLAWN ST.

PRELIMINARY
NOT FOR CONSTRUCTION

APEGM
Certificate of Authorization
Stantec Consulting Ltd.
No. 1301 Expiry: April 30, 2007

EXISTING	LEGEND-PLAN	PROPOSED	EXISTING	LEGEND-PLAN	PROPOSED	EXISTING	LEGEND-PROFILE	PROPOSED
150 WM	WATERMAIN	150 WM	HYDRO	HYDRO	150 WM	WATERMAIN	150 WM	WATERMAIN
+	HYDRANT	+	M.T.S.	M.T.S.	+	HYDRANT, VALVE	+	HYDRANT, VALVE
○	VALVE	○	CONCRETE	CONCRETE	○	LAND DRAINAGE SEWER	○	LAND DRAINAGE SEWER
300 LDS	LAND DRAINAGE SEWER	300 LDS	ASPHALT	ASPHALT	250 WWS	WASTE WATER SEWER	250 WWS	WASTE WATER SEWER
250 WWS	WASTE WATER SEWER	250 WWS	SIDEWALK	SIDEWALK	○	C PROFILE	○	C PROFILE
○	MANHOLE	○	PROPERTY LINE	PROPERTY LINE	○	NORTH OR WEST GUTTER	○	NORTH OR WEST GUTTER
□	CATCH BASIN	□	SURVEY BAR	SURVEY BAR	○	SOUTH OR EAST GUTTER	○	SOUTH OR EAST GUTTER
▽	CURB INLET	▽	DITCH	DITCH	○	NORTH OR WEST P	○	NORTH OR WEST P
+	JUNCTIONS	+	ELEVATION	ELEVATION	○	SOUTH OR EAST P	○	SOUTH OR EAST P
+	CULVERT	+	SIDEWALK RAMP	SIDEWALK RAMP	○	NORTH OR WEST DITCH	○	NORTH OR WEST DITCH
+	GAS	+			○	SOUTH OR EAST DITCH	○	SOUTH OR EAST DITCH

LOCATION APPROVED UNDERGROUND STRUCTURES

SUPV. U/G STRUCTURES COMMITTEE DATE
NOTE:
LOCATION OF UNDERGROUND STRUCTURES AS SHOWN ARE BASED ON THE BEST INFORMATION AVAILABLE BUT NO GUARANTEE IS GIVEN THAT THE GIVEN LOCATIONS ARE EXACT. CONFIRMATION OF EXISTENCE AND EXACT LOCATION OF ALL SERVICES MUST BE OBTAINED FROM THE INDIVIDUAL UTILITIES BEFORE PROCEEDING WITH CONSTRUCTION.

NO.	REVISIONS	DATE	BY
A	ISSUED FOR CLIENT REVIEW	06.06.07	A.M.

Stantec Consulting Ltd.
905 Waverly Street, Winnipeg, Manitoba
Tel 204-489-5900 Fax 204-453-9012

DESIGNED BY: A.M.	CHECKED BY: V.M.M.
DRAWN BY: T.G.	APPROVED BY: A.M.

HOR. SCALE: 1:250
VERTICAL: 1:10

RELEASED FOR CONSTRUCTION: _____

ENGINEER'S SEAL
PROVINCE OF MANITOBA
REGISTERED PROFESSIONAL ENGINEER
A. MALBASA
MEMBER 23212
CONSULTANT DRAWING NO. C-201

THE CITY OF WINNIPEG
Winnipeg ENGINEERING DIVISION
NESS AVENUE
BELVIDERE STREET TO FERRY ROAD
BELVIDERE STREET TO STA. 2+25
2006 ASPHALT RESURFACING

SHEET 1 OF 7
CAD FILE DRAWING NUMBER 04400C-201675.dwg
CITY DRAWING NUMBER P3270