

Notes:
 .01 Contractor is responsible for the site verification of all dimensions
 .02 Drawings are not to be scaled for estimating purposes
 .03 All areas given are approximate

Stated scale is when in 11x17 format

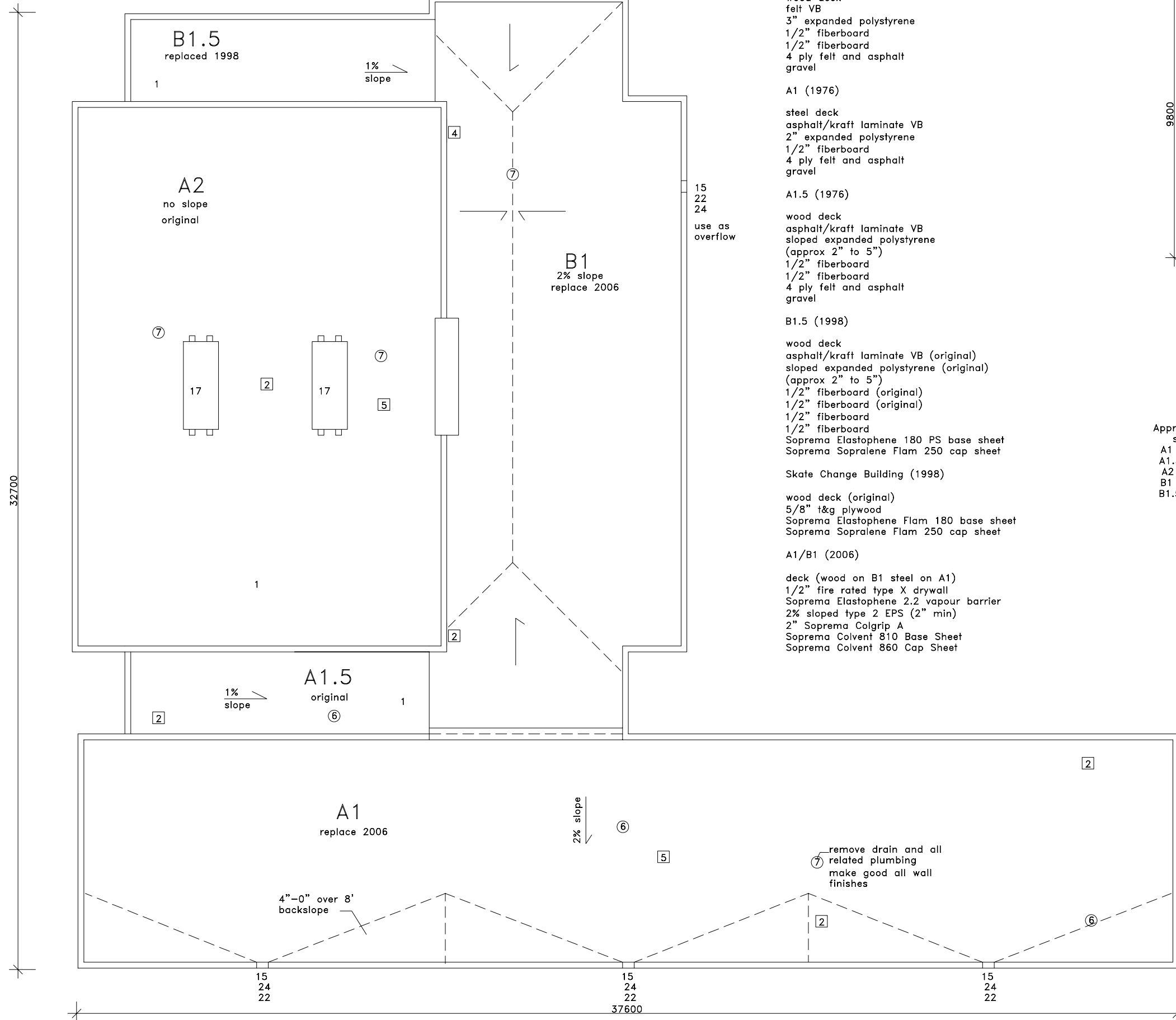

Existing Roof Construction

A2/B1 (1966)
 wood deck
 felt VB
 3" expanded polystyrene
 1/2" fiberboard
 1/2" fiberboard
 4 ply felt and asphalt
 gravel

A1 (1976)
 steel deck
 asphalt/kraft laminate VB
 2" expanded polystyrene
 1/2" fiberboard
 4 ply felt and asphalt
 gravel

A1.5 (1976)
 wood deck
 asphalt/kraft laminate VB
 sloped expanded polystyrene
 (approx 2" to 5")
 1/2" fiberboard
 1/2" fiberboard
 4 ply felt and asphalt
 gravel

B1.5 (1998)
 wood deck
 asphalt/kraft laminate VB (original)
 sloped expanded polystyrene (original)
 (approx 2" to 5")
 1/2" fiberboard (original)
 1/2" fiberboard (original)
 1/2" fiberboard
 Soprema Elastophene 180 PS base sheet
 Soprema Sopralene Flam 250 cap sheet

Skate Change Building (1998)
 wood deck (original)
 5/8" t&g plywood
 Soprema Elastophene Flam 180 base sheet
 Soprema Sopralene Flam 250 cap sheet

A1/B1 (2006)
 deck (wood on B1 steel on A1)
 1/2" fire rated type X drywall
 Soprema Elastophene 2.2 vapour barrier
 2% sloped type 2 EPS (2" min)
 2" Soprema Colgrip A
 Soprema Colvent 810 Base Sheet
 Soprema Colvent 860 Cap Sheet

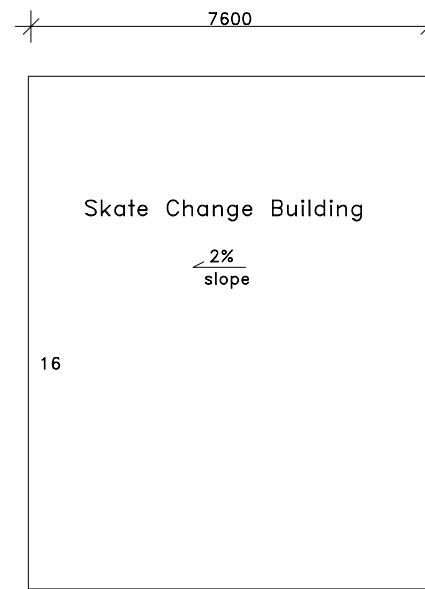

Approx. Area
 sq.m.
 A1 = 198
 A1.5 = 29
 A2 = 241
 B1 = 198
 B1.5 = 29

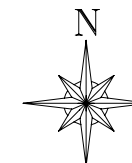

1966
 1976

GRAPHIC LEGEND

- Parapet
- Gravel stop
- Control joint
- Expansion joint
- New insulated drain pipe
- Photo vantage point
- Area Label

X = leak

= attic vent

KEYNOTE LEGEND

- 1 core sample
- 2 chimney
- 3 AC unit
- 4 goose neck vent
- 5 ventilator
- 6 vent pipe
- 7 roof drain
- 8 skylight
- 9 eavestrough
- 10 firewall
- 11 antenna
- 12 ladder
- 13 stub column
- 14 roof hatch
- 15 scupper
- 16 pitch box
- 17 HVAC unit
- 18 capped curb
- 19 flag pole
- 20 electrical mast
- 21 cooling tower
- 22 splash pad
- 23 splash pan
- 24 downspout/rainwater leader
- 25 back slope
- 26 cant
- 27 increase slope to drain
- 28 cricket
- 29 parapet/wide flashing
- 30 life line anchor

AGASSIZ CONSULTING GROUP

809 Pipeline Road, Winnipeg, Manitoba
 Phone: 697-8091 Fax: 697-8039

Project: Sir John Franklin CC
 1 Sir John Franklin
 Winnipeg, MB

Date: May 5, 2006

Drawing No. R-1

File no: 3132-06 Scale: 1:150