

CHAINAGE ALONG NORTH PROPERTY LINE OF NEWMAN AV. W

NEWMAN AV. WEST

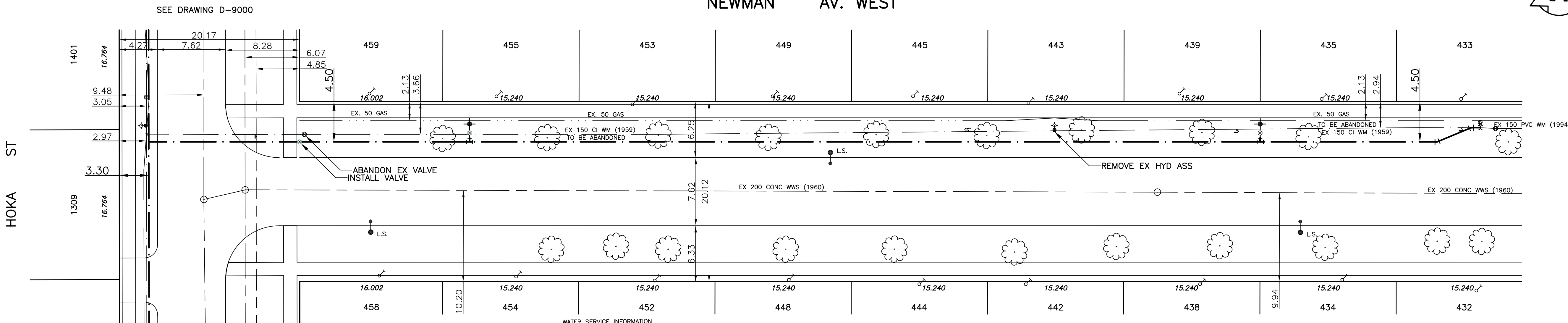
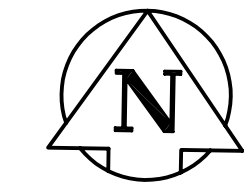

WATER SERVICE INFORMATION ADDRESS & NATURE OF SERVICE	SIZE(mm) & TYPE (STREET)	SIZE(mm) & TYPE (PROP)	SHORT & LONG MEASUREMENT	CORP	REMARKS
433 Newman Ave West	19 Residential Copper	19	6.2 W.E. HSE LINE 8.9 FROM HSE FRONT	HOKA & NEWMAN	SEE SKETCH, SWR JCT TEE 36.3 E FROM 1ST MH OFF
434 Newman Ave West	19 Residential Copper	19	5.6 W.E. HSE LINE 8.0 FROM HSE FRONT	HOKA & NEWMAN	SEE SKETCH, SWR JCT TEE 22.6 E FROM 1ST MH OFF
435 Newman Ave West	19 Residential Copper	19	3.8 E.W. HSE LINE 7.6 FROM HSE FRONT	HOKA & NEWMAN	SEE SKETCH, SWR JCT TEE 21.0 E FROM 1ST MH OFF
438 Newman Ave West	19 Residential Copper	19	5.6 W.E. HSE LINE 7.9 FROM HSE FRONT	HOKA & NEWMAN	SEE SKETCH, SWR JCT TEE 7.0 E FROM 1ST MH OFF
439 Newman Ave West	19 Residential Copper	19	4.3 E.W. HSE LINE 7.4 FROM HSE FRONT	HOKA & NEWMAN	SEE SKETCH, SWR JCT TEE 5.5 E FROM 1ST MH OFF
442 Newman Ave West	19 Residential Copper	19	2.4 E.W. HSE LINE 8.7 FROM HSE FRONT	HOKA & NEWMAN	SEE SKETCH, SWR JCT TEE 94.2 E FROM MH AT
443 Newman Ave West	19 Residential Copper	19	2.7 E.W. HSE LINE 8.8 OUT	HOKA & NEWMAN	SEE SKETCH, SWR JCT TEE 92.7 E FROM MH AT

WATER SERVICE INFORMATION ADDRESS & NATURE OF SERVICE	SIZE(mm) & TYPE (STREET)	SIZE(mm) & TYPE (PROP)	SHORT & LONG MEASUREMENT	CORP	REMARKS
444 Newman Ave West	19 Residential Copper	19	5.7 E.W. HSE LINE 10.4 FROM HSE FRONT	HOKA & NEWMAN	SEE SKETCH, SWR JCT TEE 79.2 E FROM MH AT
445 Newman Ave West	19 Residential Copper	19	4.6 E.W. HSE LINE 8.2 FROM HSE FRONT	HOKA & NEWMAN	SEE SKETCH, SWR JCT TEE 77.7 E FROM MH AT
448 Newman Ave West	19 Residential Copper	19	5.9 W.E. HSE LINE 7.9 FROM HSE FRONT	HOKA & NEWMAN	SEE SKETCH, SWR JCT TEE 63.7 E FROM MH AT
449 Newman Ave West	19 Residential Copper	19	7.3 E.W. HSE LINE 4.8 FROM HSE FRONT	HOKA & NEWMAN	SEE SKETCH, SWR JCT TEE 62.2 E FROM MH AT
452 Newman Ave West	19 Residential Copper	19	5.0 W.E. HSE LINE 8.1 FROM HSE FRONT	HOKA & NEWMAN	SEE SKETCH, SWR JCT TEE 48.5 E FROM MH AT
453 Newman Ave West	19 Residential Copper	19	4.3 E.W. HSE LINE 8.5 OUT	HOKA & NEWMAN	SEE SKETCH, SWR JCT TEE 46.9 E FROM MH AT
454 Newman Ave West	19 Residential Copper	19	4.9 E.W. HSE LINE 2.7 FROM HSE FRONT	HOKA & NEWMAN	SEE SKETCH, SWR JCT TEE 32.9 E FROM MH AT
455 Newman Ave West	19 Residential Copper	19	4.6 E.W. HSE LINE 8.0 FROM HSE FRONT	HOKA & NEWMAN	SEE SKETCH, SWR JCT TEE 31.4 E FROM MH AT
458 Newman Ave West	19 Residential Copper	19	2.7 E.W. HSE LINE 9.1 FROM HSE FRONT	HOKA & NEWMAN	SEE SKETCH, SWR JCT TEE 17.7 E FROM MH AT

- NOTES:**
- ALL GATE VALVES ARE TO BE COUNTER-CLOCKWISE TO OPEN WITH A BLACK OPERATING NUT.
 - WATERMAIN TO BE INSTALLED BY TRENCHLESS METHODS.
 - BACKFILL IS CLASS 5 WITHIN BOULEVARD AND CLASS 3 WHEN WITHIN PAVEMENT/SIDEWALK OR WHEN WITHIN 1.0m OF PAVEMENT OR SIDEWALK.
 - WATER SERVICES ARE 19mm COPPER UNLESS OTHERWISE NOTED.
 - MINIMUM COVER TO TOP OF WATERMAIN SHALL BE 2.4m.
 - LOCATION OF ALL SERVICES TO BE CONFIRMED IN FIELD.
 - EXPOSE EXISTING WATERMAIN TO CONFIRM DEPTH PRIOR TO CONSTRUCTION.
 - ALL LEAD SERVICES TO BE RENEWED.
 - SERVICES TO BE RENEWED SHALL BE REPLACED FROM WATERMAIN TO PROPERTY LINE. ALL OTHERS TO BE RECONNECTED.

METRIC
WHOLE NUMBERS INDICATE MILLIMETRES
DECIMALIZED NUMBERS INDICATE METRES

APEGM
Certificate of Authorization
SEG Engineering Inc.
No. 252 Expiry: April 30, 2007

EXISTING	LEGEND - PLAN	PROPOSED	EXISTING	LEGEND - PLAN	PROPOSED	EXISTING	LEGEND - PROFILE	PROPOSED
---	WATERMAIN	---	---	HYDRO	---	---	WATERMAIN VALVE	---
---	HYDRANT VALVE	---	---	M.T.S.	---	---	LAND DRAINAGE SEWER	---
---	LAND DRAINAGE SEWER	---	---	CONCRETE ASPHALT	---	---	WASTE WATER SEWER	---
---	WASTE WATER SEWER	---	---	PROPERTY LINE	---	---	JUNCTIONS	---
---	MANHOLE	---	---	SURVEY BAR	---	---	CULVERT	---
---	CATCH BASIN	---	---	CURB STOP	---	---		
---	CURB INLET	---	---	C.B. LEAD	---	---		
---	TRAFFIC SIGNAL	---	---	SIDEWALK	---	---		
---	GAS	---	---		---	---		

LOCATION APPROVED

SUPV. U/G STRUCTURES COMMITTEE DATE

NOTE:
LOCATION OF UNDERGROUND STRUCTURES AS SHOWN ARE BASED ON THE BEST INFORMATION AVAILABLE BUT NO GUARANTEE IS GIVEN THAT ALL EXISTING UTILITIES ARE SHOWN OR THAT THE GIVEN LOCATIONS ARE EXACT. CONFIRMATION OF EXISTENCE AND EXACT LOCATION OF ALL SERVICES MUST BE OBTAINED FROM THE INDIVIDUAL UTILITIES BEFORE PROCEEDING WITH CONSTRUCTION.

B.M. 010-012 ELEV. 232.469

CWMB: ELEV

SEG ENGINEERING INC.
200 TACHE AVENUE WINNIPEG, MANITOBA (204)-233-2113

DESIGNED BY: DJ
CHECKED BY: SM

DRAWN BY: RH
APPROVED BY: IMck

HOR. SCALE: 1:250
VERT. SCALE: 1:50

RELEASED FOR CONSTRUCTION
K. ZUREK P. ENG
DATE: MAY 15, 2006

ENGINEERS SEAL
I. G. MCKINNON
REGISTERED PROFESSIONAL ENGINEER

THE CITY OF WINNIPEG
WATER AND WASTE DEPARTMENT

2006 CAPITAL WORKS
WATERMAIN RENEWALS - CONTRACT 18
NEWMAN AVENUE WEST

CITY DRAWING NO.
SHEET 4 OF 4

HOKA STREET
TO 130 M EAST OF HOKA STREET

D-9003