

NOTE: CHAINAGES SHOWN ARE ALONG S R L OF CORYDON AVE.

WATER SERVICE INFORMATION

ADDRESS	SIZE(mm) & TYPE (STREET)	SIZE(mm) & TYPE (PROP)	SHORT & LONG MEASUREMENT	CORP. LOCATION
217 GUELPH ST	25 COPPER	25 COPPER	0.30 WEL HSE	OPP S/C
220 GUELPH ST	25 COPPER	25 COPPER	11.75 EEL GUELPH	SERV. OFF CORYDON
1056 CORYDON AVE	20 COPPER	20 COPPER	1.80 WEL HSE	ALSO FOR 211, 213, 215
1068 CORYDON AVE	20 COPPER	20 COPPER	3.23 WEL GUELPH	SERV. OFF CORYDON
1074 CORYDON AVE	20 COPPER	20 COPPER	3.81 WEL HSE	0.30 E OF S/C
1077 CORYDON AVE	13 COPPER	13 COPPER	6.56 EEL GUELPH	REV. TAPPED
1079 CORYDON AVE	20 COPPER	20 COPPER	2.92 WEL HSE	0.30 W OF S/C
1084 CORYDON AVE	20 COPPER	20 COPPER	4.94 WEL GUELPH	0.30 W OF S/C
1087 CORYDON AVE	13 COPPER	13 COPPER	1.83 WEL HSE	OPP S/C
1070 CORYDON AVE	20 COPPER	20 COPPER	17.61 WEL GUELPH	OPP S/C
1071 CORYDON AVE	20 COPPER	20 COPPER	3.88 WEL HSE	0.61 W OF S/C
1074 CORYDON AVE	20 COPPER	20 COPPER	19.50 WEL GUELPH	0.61 W OF S/C
1077 CORYDON AVE	20 COPPER	20 COPPER	32.72 WEL GUELPH	OPP S/C
1079 CORYDON AVE	20 COPPER	20 COPPER	4.0 WEL HSE	0.61 W OF S/C
1078 CORYDON AVE	20 COPPER	20 COPPER	40.67 WEL GUELPH	OPP S/C
1079 CORYDON AVE	20 COPPER	20 COPPER	1.13 WEL HSE	0.30 W OF S/C
1080 CORYDON AVE	20 COPPER	20 COPPER	41.17 WEL GUELPH	OPP S/C
1081 CORYDON AVE	20 COPPER	20 COPPER	57.20 WEL GUELPH	OPP S/C
1084 CORYDON AVE	20 COPPER	20 COPPER	2.72 WEL HSE	0.30 W OF S/C
1087 CORYDON AVE	20 COPPER	20 COPPER	65.18 WEL GUELPH	OPP S/C
1088 CORYDON AVE	20 COPPER	20 COPPER	3.81 WEL HSE	MULT. METERING W/ 1083
1084 CORYDON AVE	20 COPPER	20 COPPER	81.69 EEL WILTON	OPP S/C
1084 CORYDON AVE	20 COPPER	20 COPPER	2.59 WEL HSE	1.37 W OF S/C
1084 CORYDON AVE	20 COPPER	20 COPPER	70.09 WEL GUELPH	OPP S/C

* SERVICES TO BE RENEWED TO R ALL OTHERS TO BE RECONNECTED

CONSTRUCTION NOTES

1. EXPOSE EXISTING WATERMAIN & CONFIRM INVERTS PRIOR TO CONSTRUCTION.
2. CONFIRM LOCATION OF ALL SERVICES IN THE FIELD.
3. INSTALL WATERMAIN BY TRENCHLESS METHODS.
4. TRENCHES AND EXCAVATIONS WITHIN 1 METRE OF A PAVED AREA INCLUDING SIDEWALKS SHALL BE CLASS 3 BACKFILL.
5. ALL MATERIALS SHALL CONFORM TO THE CITY OF WINNIPEG STANDARD CONSTRUCTION SPECIFICATIONS.
6. MINIMUM COVER TO TOP OF WATERMAIN SHALL BE 2.4 m.
7. REPLACE ALL EXISTING LEAD SERVICES FROM PROPOSED WATERMAIN TO R.
8. NOTIFY ALL AFFECTED RESIDENTS AND BUSINESSES 24 HOURS IN ADVANCE OF ANY WATER SHUTDOWNS OR DISRUPTION OF SERVICE.

METRIC
WHOLE NUMBERS INDICATE MILLIMETRES
DECIMAL NUMBERS INDICATE METRES

NOTE: ALL VALVES TO BE INSTALLED COUNTERCLOCKWISE TO CLOSE

WARNING

IF POWER EQUIPMENT OR EXPLOSIVES ARE TO BE USED FOR EXCAVATION ON THIS PROJECT THE CONTRACTOR MUST:
1) NOTIFY THE GAS COMPANY OF THE PROPOSED LOCATION OF EXCAVATION.
2) TAKE PRECAUTION TO AVOID DAMAGE TO GAS COMPANY INSTALLATIONS.
SEE PROVINCIAL REGULATION 210/72 FOR DETAILS

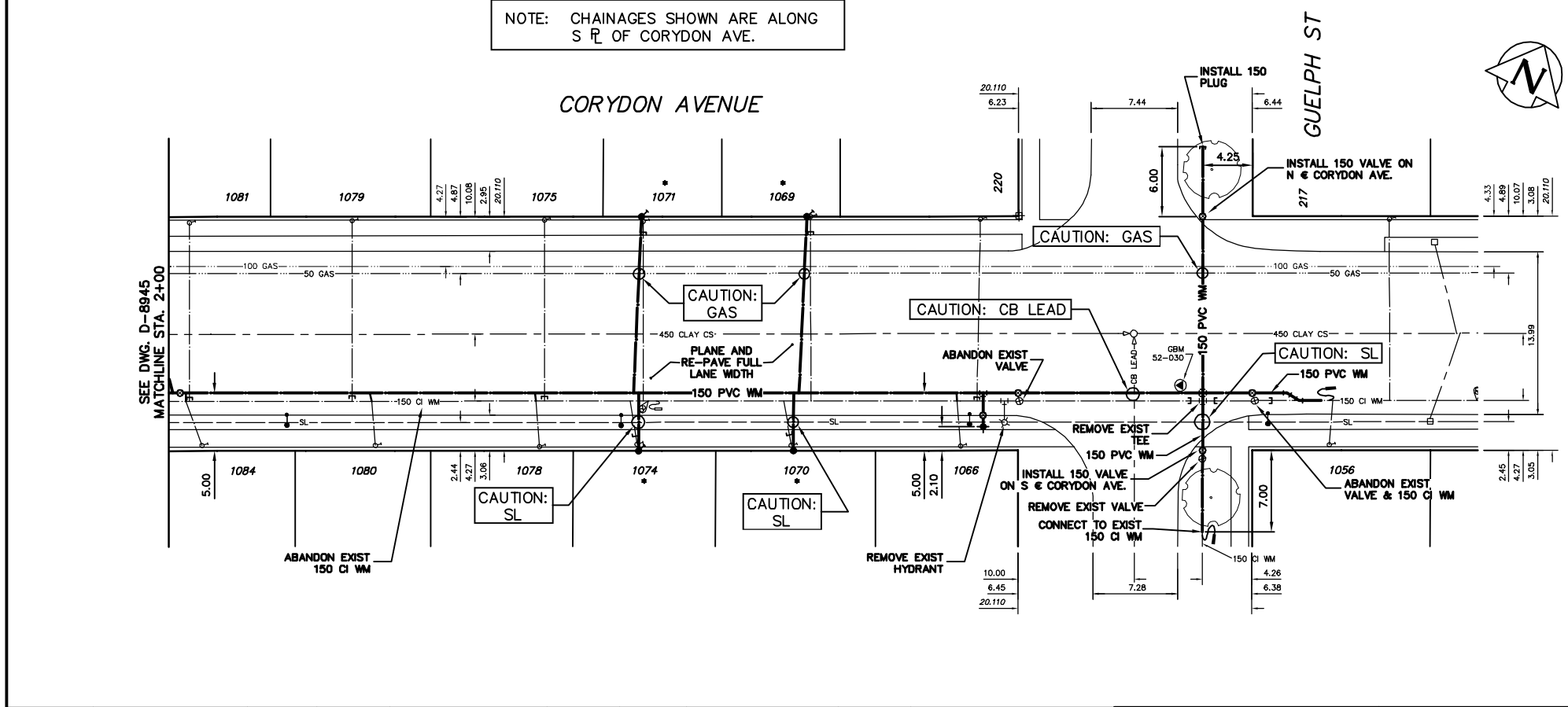
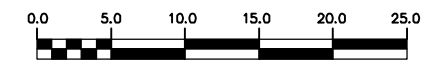

200 WM	WATERMAIN	200 WM	SL, HYDRO	150 WM	WATERMAIN	150 WM
⊕	HYDRANT	⊕	MTS	⊕	HYDRANT	⊕
⊙	VALVE	⊙	TRAFFIC SIGNALS	⊙	VALVE	⊙
525 LDS	LAND DRAINAGE SEWER	525 LDS	GAS	300 LDS	LAND DRAINAGE SEWER	300 LDS
375 WWS	WASTEWATER SEWER	375 WWS	SURVEY BAR	250 WWS	WASTEWATER SEWER	250 WWS
○	MANHOLE	○	FENCE	⊕	PROFILE	⊕
□	CATCH BASIN	□	POLE - HYDRO, MTS	⊕	GROUND ABOVE PIPE	⊕
▽	CURB INLET	▽	CURB STOP	⊕	? DITCH (NORTH & WEST)	⊕
◁	REDUCER	◁	GUY ANCHOR	⊕	? DITCH (SOUTH & EAST)	⊕
×	COUPLER	×	LIGHT STANDARD	⊕	GUTTER (NORTH & WEST)	⊕
⊕	ANODE	⊕	TREE	⊕	GUTTER (SOUTH & EAST)	⊕
EXISTING	LEGEND-PLAN	PROPOSED	EXISTING	LEGEND-PLAN	PROPOSED	EXISTING

LOCATION APPROVED	B.M. ELEV.	FIELD BOOK #:
UNDERGROUND STRUCTURES	POSTED TO LBS	
SUPV. U/G STRUCTURES COMMITTEE	DATE	
NOTE:		
LOCATION OF UNDERGROUND STRUCTURES AS SHOWN ARE BASED ON THE BEST INFORMATION AVAILABLE BUT NO GUARANTEE IS GIVEN THAT ALL EXISTING UTILITIES ARE SHOWN OR THAT THE GIVEN LOCATIONS ARE EXACT. CONFIRMATION OF EXISTENCE AND EXACT LOCATION OF ALL SERVICES MUST BE OBTAINED FROM THE INDIVIDUAL UTILITIES BEFORE PROCEEDING WITH CONSTRUCTION.		
NO. REVISIONS	DATE	BY

CITY OF WINNIPEG
WATER AND WASTE
ENGINEERING DIVISION

DESIGNED BY: SC
CHECKED BY: TW
DRAWN BY: CJH
APPROVED BY: KZ
HOR. SCALE: 1:250
VERTICAL: 1:50
RELEASED FOR CONSTRUCTION: 2006 08 04

ENGINEER'S SEAL
ORIGINAL SIGNED BY S.R.J. COURNOYER 06/08/04

THE CITY OF WINNIPEG
WATER AND WASTE DEPARTMENT

2006 WATERMAIN RENEWALS
CORYDON AVENUE
88 E OF WILTON STREET TO GUELPH STREET

SHEET 2 OF 10
CITY DRAWING NUMBER
D-8946

BID OPPORTUNITY: 303-2006
FILENAME: D-8946.dwg
PLOT DATE: 2006 08 04