

B SIZE 11" x 17" (279mm x 432mm)
 PLOT: 06/05/21 10:13:59 AM
 UMA FILE NAME: 0265-379-00_01-C-1001_RX.dwg Saved By: kberard

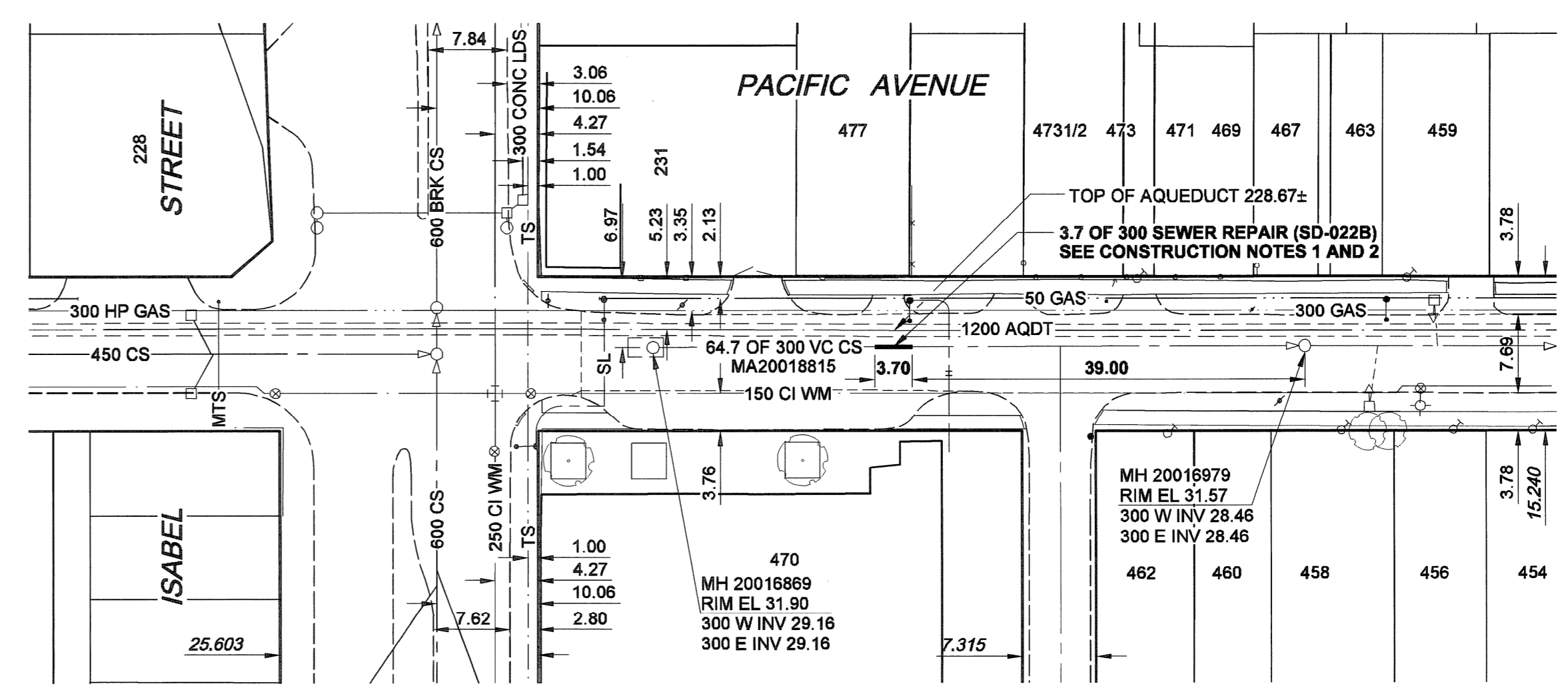

WARNING

IF POWER EQUIPMENT OR EXPLOSIVES ARE TO BE USED FOR EXCAVATION ON THIS PROJECT, THE CONTRACTOR MUST:

- 1) NOTIFY THE GAS COMPANY OF THE PROPOSED LOCATION OF EXCAVATION.
- 2) TAKE PRECAUTION TO AVOID DAMAGE TO GAS COMPANY INSTALLATIONS. SEE PROVINCIAL REGULATION 140/92 FOR DETAILS

CONSTRUCTION NOTES

1. CONTACT THE WATER AND WASTE DEPARTMENT CONSTRUCTION SERVICES CO-ORDINATOR, ANDY VINCENT, AT 986-3823 A MINIMUM OF 7 DAYS PRIOR TO WORKING ADJACENT TO AQUEDUCT TO ARRANGE FOR INSPECTION.
2. DO NOT REMOVE EXISTING TIMBER SHORING IF ENCOUNTERED DURING SEWER REPAIR EXCAVATION. THE TIMBERS MUST ONLY BE CUT TO AVOID DISTURBANCE TO THE AQUEDUCT.

LOCATION APPROVED UNDERGROUND STRUCTURES

SUPR. U/G STRUCTURES COMMITTEE	DATE

NOTES:
 LOCATION OF UNDERGROUND STRUCTURES AS SHOWN ARE BASED ON THE BEST INFORMATION AVAILABLE. BUT NO GUARANTEE IS GIVEN THAT ALL EXISTING UTILITIES ARE SHOWN OR THAT THE GIVEN LOCATIONS ARE EXACT. CONFIRMATION OF EXISTENCE AND EXACT LOCATION OF ALL SERVICES MUST BE OBTAINED FROM THE INDIVIDUAL UTILITIES BEFORE PROCEEDING WITH CONSTRUCTION.

NO.	REVISIONS	DATE	BY
0	ISSUED FOR CONSTRUCTION	06/05/21	KMB

METRIC
 WHOLE NUMBERS INDICATE MILLIMETRES
 DECIMALIZED NUMBERS INDICATE METRES

UMA | AECOM

DESIGNED BY: MJR
 DRAWN BY: KMB
 HOR. SCALE: 1:500
 VERT. SCALE:

CHECKED BY: A. Delamaria
 APPROVED BY: C.C. MACEY
 RELEASED FOR CONSTRUCTION:

APFCM
 Certificate of Authorization
 UMA Engineering Ltd.
 No. 256 Expiry: April 30, 2007

PROFESSIONAL'S SEAL
 PROVINCE OF MANITOBA
 C.C. MACEY
 REGISTERED ENGINEER

CONSULTANT DRAWINGS NO. 11
 0265-379-00

THE CITY OF WINNIPEG WATER AND WASTE DEPARTMENT

PACIFIC AVENUE
 ISABEL ST TO ELLEN ST
 SEWER REPAIRS

151 MH E OF ISABEL STREET
 TO 2ND MH E OF ISABEL STREET

SHEET 11 OF 14
 CITY DRAWING NUMBER
 04407
 REV 0

BID OPPORTUNITY NO. 299-2006