

A1 SIZE 23.4" x 33.1" (594mm x 841mm)

PLOT: 06/06/20 3:26:08 PM

UMA FILE NAME: 0285-384-00_01-CT1024_RX.dwg Saved By: dtdspood

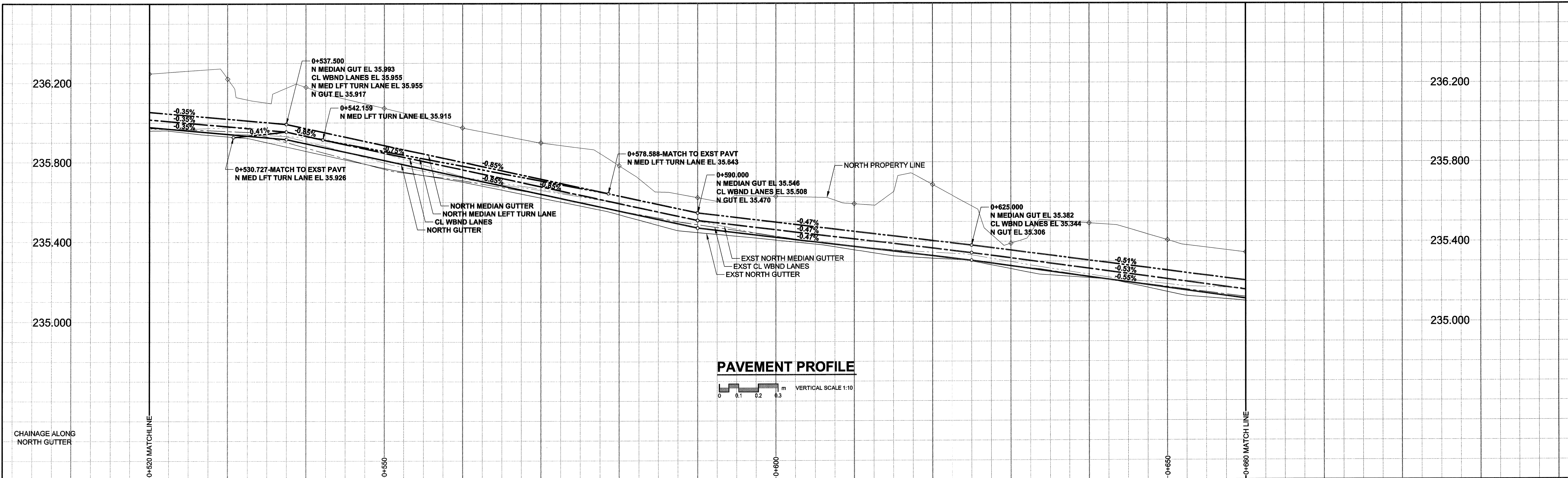

PAVEMENT PROFILE
 0 0.1 0.2 0.3 m VERTICAL SCALE 1:10

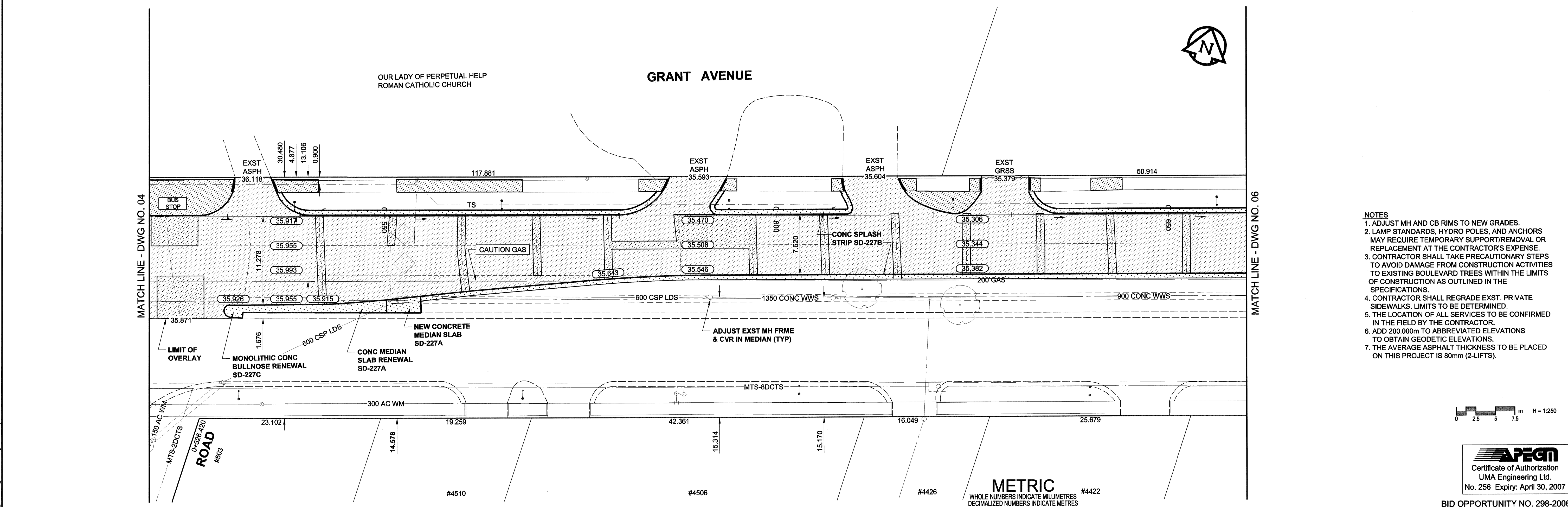

- NOTES**
1. ADJUST MH AND CB RIMS TO NEW GRADES.
 2. LAMP STANDARDS, HYDRO POLES, AND ANCHORS MAY REQUIRE TEMPORARY SUPPORT/REMOVAL OR REPLACEMENT AT THE CONTRACTOR'S EXPENSE.
 3. CONTRACTOR SHALL TAKE PRECAUTIONARY STEPS TO AVOID DAMAGE FROM CONSTRUCTION ACTIVITIES TO EXISTING BOULEVARD TREES WITHIN THE LIMITS OF CONSTRUCTION AS OUTLINED IN THE SPECIFICATIONS.
 4. CONTRACTOR SHALL REGRADE EXST. PRIVATE SIDEWALKS. LIMITS TO BE DETERMINED.
 5. THE LOCATION OF ALL SERVICES TO BE CONFIRMED IN THE FIELD BY THE CONTRACTOR.
 6. ADD 200.000m TO ABBREVIATED ELEVATIONS TO OBTAIN GEODETIC ELEVATIONS.
 7. THE AVERAGE ASPHALT THICKNESS TO BE PLACED ON THIS PROJECT IS 80mm (2-LIFTS).

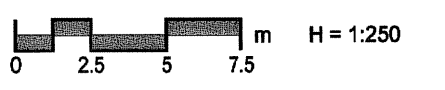

APCM
 Certificate of Authorization
 UMA Engineering Ltd.
 No. 256 Expiry: April 30, 2007

BID OPPORTUNITY NO. 298-2006

---	NATURAL GAS	○	MANHOLE	●	CONCRETE PAVEMENT	▨	LOCATION APPROVED	BM 49-015
---	COMMUNICATION	□	CATCH BASIN / CATCH PIT	■	ASPHALT PAVEMENT	▩	UNDERGROUND STRUCTURES	ELEV 238.012m
---	HYDRO	△	C & G INLET WITH BOX	■	CONC. SIDEWALK/MEDIAN	▨		
---	CATV	+	TREE	○	PAVING STONE	▨		
---	TRAFFIC SIGNALS	TH-12	TEST HOLE	○	GRAVEL	▨		
---	LAND DRAINAGE SEWER	+	PROPERTY LINE	---	CURB RAMP	▨		
---	SANITARY/COMBINED SEWER	+	SURVEY BAR	---	PLANING	▨		
---	CATCHBASIN LEAD	+	FENCE	---				
---	WATERMAIN	+	BOC/EOPAVT	---				
---	SUBDRAIN	+	ELEVATION	(33.100)				
---	DITCH	---						
---	EXISTING	---	LEGEND - PLAN	---	EXISTING	---		
---	NEW	---	LEGEND - PLAN	---	NEW	---		

LOCATION APPROVED UNDERGROUND STRUCTURES

DATE COMMITTEE

NOTE: LOCATION OF UNDERGROUND STRUCTURES AS SHOWN ARE BASED ON THE BEST INFORMATION AVAILABLE. BUT NO GUARANTEE IS GIVEN THAT ALL EXISTING UTILITIES ARE SHOWN OR THAT THE GIVEN LOCATIONS ARE EXACT. CONFIRMATION OF EXISTENCE AND EXACT LOCATION OF ALL SERVICES MUST BE OBTAINED FROM THE INDIVIDUAL UTILITIES BEFORE PROCEEDING WITH CONSTRUCTION.

NO.	ISSUED FOR CONSTRUCTION	06/08/20	BY	DID
NO.	REVISIONS	YYMMDD	BY	

METRIC
 WHOLE NUMBERS INDICATE MILLIMETRES
 DECIMALIZED NUMBERS INDICATE METRES

DESIGNED BY	RPB	CHECKED BY	URS
DRAWN BY	DID	APPROVED BY	PURB
HOR. SCALE	AS SHOWN	RELEASED FOR CONSTRUCTION	Steve
VERT. SCALE	1:250	DATE	JUNE 20/2006
DATE	06/08/20		

PROFESSIONAL'S SEAL
 PROVINCE OF MANITOBA
 REGISTERED PROFESSIONAL ENGINEER
 R. P. BRUCE
 CONSULTANT DRAWING NO. 0285-384-00_01-CT1024_RX.dwg

THE CITY OF WINNIPEG
 PUBLIC WORKS DEPARTMENT
 ENGINEERING DIVISION

**ROBLIN BOULEVARD/GRANT AVENUE
 DIEPPE ROAD TO
 FAIRMONT ROAD
 STREET RENEWAL**
 HORIZONTAL AND VERTICAL ALIGNMENT
 FROM STA 0+520 TO STA 0+660

CITY DRAWING NUMBER P-3269-05
 SHEET 5 OF 6
 DRAWING No. 05
 REV 0