

A1 SIZE 23.4" x 33.1" (594mm x 841mm)

PLOT: 06/06/20 11:25:14 AM

UMA FILE NAME: 0265-384-00_01-CT1005_RX.dwg Saved By: droszpod

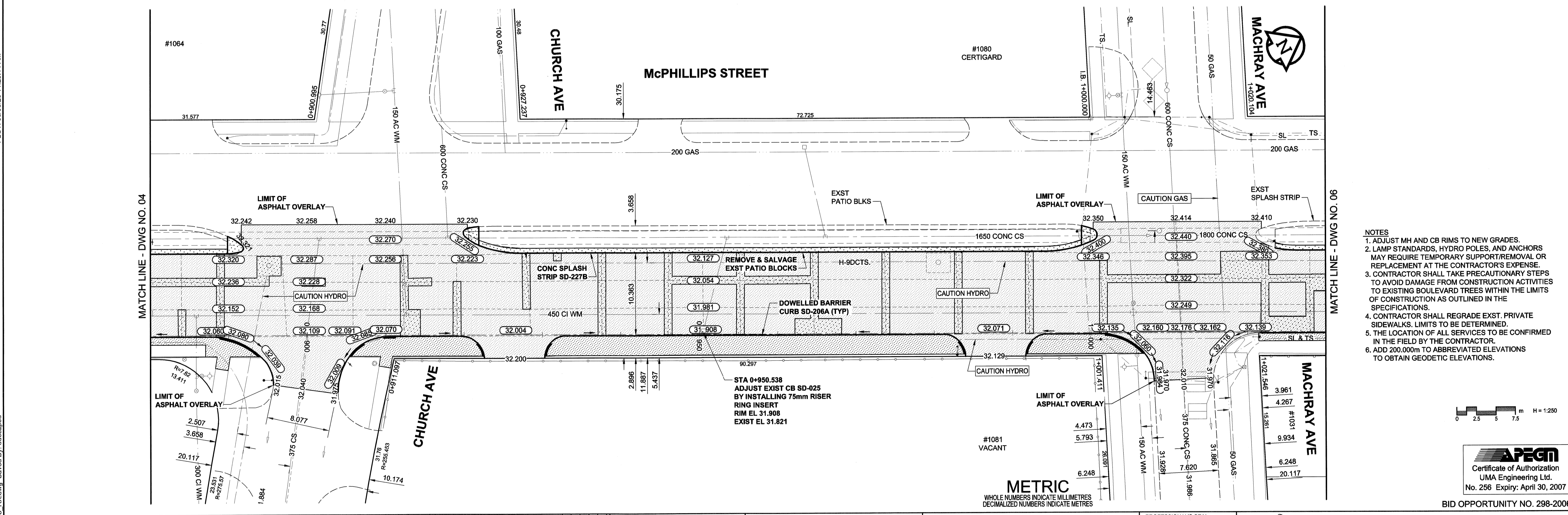
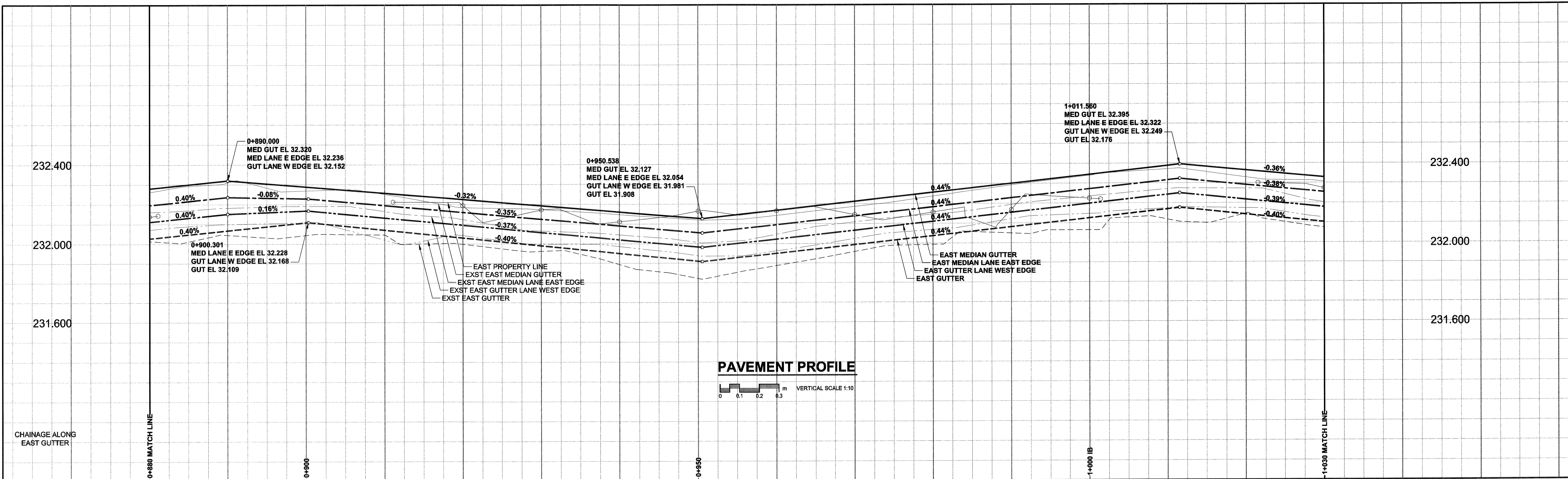

- NOTES**
1. ADJUST MH AND CB RIMS TO NEW GRADES.
 2. LAMP STANDARDS, HYDRO POLES, AND ANCHORS MAY REQUIRE TEMPORARY SUPPORT/REMOVAL OR REPLACEMENT AT THE CONTRACTOR'S EXPENSE.
 3. CONTRACTOR SHALL TAKE PRECAUTIONARY STEPS TO AVOID DAMAGE FROM CONSTRUCTION ACTIVITIES TO EXISTING BOULEVARD TREES WITHIN THE LIMITS OF CONSTRUCTION AS OUTLINED IN THE SPECIFICATIONS.
 4. CONTRACTOR SHALL REGRADE EXST. PRIVATE SIDEWALKS. LIMITS TO BE DETERMINED.
 5. THE LOCATION OF ALL SERVICES TO BE CONFIRMED IN THE FIELD BY THE CONTRACTOR.
 6. ADD 200.000m TO ABBREVIATED ELEVATIONS TO OBTAIN GEODETIC ELEVATIONS.

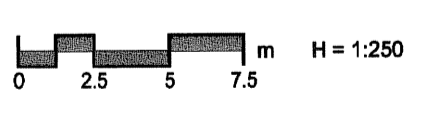

APGM
Certificate of Authorization
UMA Engineering Ltd.
No. 256 Expiry: April 30, 2007

BID OPPORTUNITY NO. 298-2006

NATURAL GAS	○	MANHOLE	●
COMMUNICATION	□	CATCH BASIN / CATCH PIT	■
HYDRO	△	C & G INLET WITH BOX	◻
CATV	○	TREE	○
TRAFFIC SIGNALS	⊕	TEST HOLE	⊕
LAND DRAINAGE SEWER	—	PROPERTY LINE	—
SANITARY/COMBINED SEWER	—	SURVEY BAR	—
CATCHBASIN LEAD	—	FENCE	—
WATERMAIN	—	BOC/EOPAVT	—
SUBDRAIN	—	ELEVATION	33.000
DITCH	—		
EXISTING	LEGEND - PLAN	NEW	LEGEND - PLAN

LOCATION APPROVED
UNDERGROUND STRUCTURES

BM 24-036
ELEV 232.215m

DESIGNED BY: WRJ
DRAWN BY: DID, KLC

CHECKED BY: RPB
APPROVED BY: RPB

ISSUED FOR CONSTRUCTION: 06/06/20
NO. REVISIONS: YMMDD BY

DATE: 06/06/20

UMA | AECOM

© 2006 UMA ENGINEERING LTD. ALL RIGHTS RESERVED.

DESIGNED BY: WRJ
DRAWN BY: DID, KLC

CHECKED BY: RPB
APPROVED BY: RPB

RELEASED FOR CONSTRUCTION: [Signature]
DATE: 06/20/2006

PROFESSIONAL'S SEAL
R. P. BRUCE
REGISTERED PROFESSIONAL ENGINEER
CONSULTANT DRAWING NO.
0265-384-00_01-CT1005_RX.dwg

THE CITY OF WINNIPEG
PUBLIC WORKS DEPARTMENT
ENGINEERING DIVISION

McPHILLIPS STREET NORTHBOUND
COLLEGE AVENUE TO
MAPLEGLLEN DRIVE
STREET RENEWAL
HORIZONTAL AND VERTICAL ALIGNMENT
FROM STA 0+880 TO STA 1+030

CITY DRAWING NUMBER: P-3288-05
SHEET 5 OF 11
DRAWING No. 05
REV 0