

D SIZE 22" x 34" (595mm x 864mm)

PLOT: 06/07/06 2:37:35 PM

UMA FILE NAME: D265-207-01_01-C-1017_RX.dwg Saved By: lberard

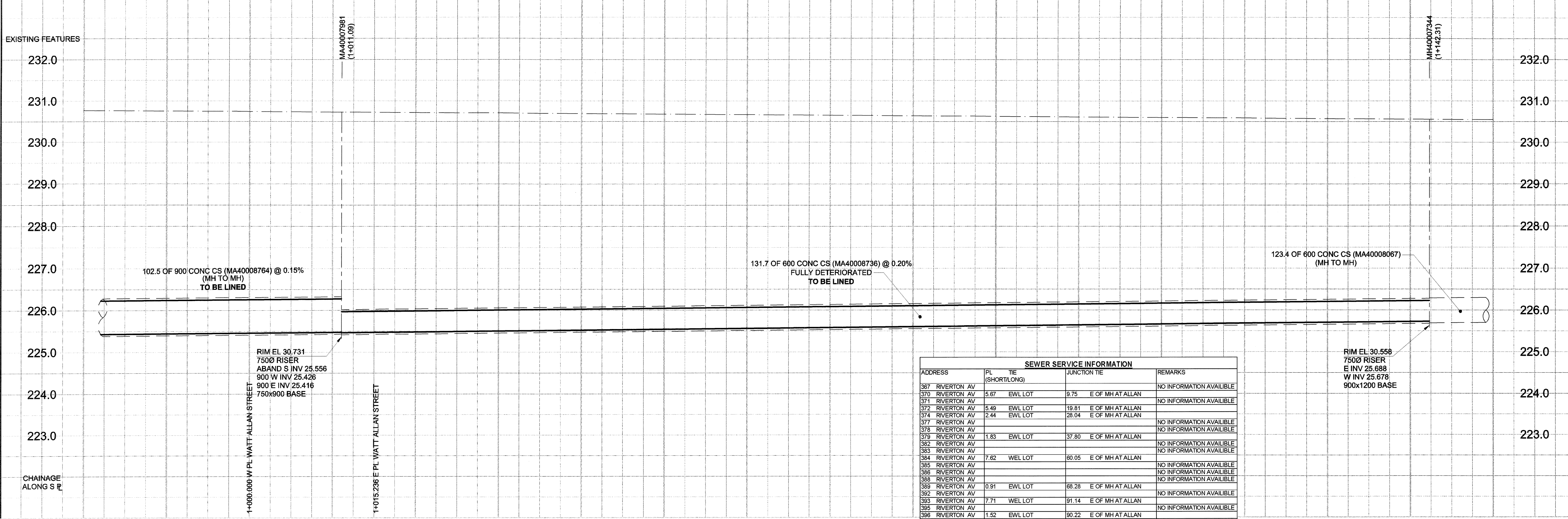

ADDRESS	PL TIE (SHORT/LONG)	JUNCTION TIE	REMARKS
367 RIVERTON AV			NO INFORMATION AVAILABLE
370 RIVERTON AV	5.67 EWL LOT	9.75 E OF MH AT ALLAN	NO INFORMATION AVAILABLE
371 RIVERTON AV			NO INFORMATION AVAILABLE
372 RIVERTON AV	5.49 EWL LOT	19.81 E OF MH AT ALLAN	NO INFORMATION AVAILABLE
374 RIVERTON AV	2.44 EWL LOT	28.04 E OF MH AT ALLAN	NO INFORMATION AVAILABLE
377 RIVERTON AV			NO INFORMATION AVAILABLE
378 RIVERTON AV			NO INFORMATION AVAILABLE
379 RIVERTON AV	1.83 EWL LOT	37.80 E OF MH AT ALLAN	NO INFORMATION AVAILABLE
382 RIVERTON AV			NO INFORMATION AVAILABLE
383 RIVERTON AV			NO INFORMATION AVAILABLE
384 RIVERTON AV	7.62 WEL LOT	60.05 E OF MH AT ALLAN	NO INFORMATION AVAILABLE
385 RIVERTON AV			NO INFORMATION AVAILABLE
386 RIVERTON AV			NO INFORMATION AVAILABLE
388 RIVERTON AV			NO INFORMATION AVAILABLE
389 RIVERTON AV	0.91 EWL LOT	68.28 E OF MH AT ALLAN	NO INFORMATION AVAILABLE
392 RIVERTON AV			NO INFORMATION AVAILABLE
393 RIVERTON AV	7.71 WEL LOT	91.14 E OF MH AT ALLAN	NO INFORMATION AVAILABLE
395 RIVERTON AV			NO INFORMATION AVAILABLE
396 RIVERTON AV	1.52 EWL LOT	90.22 E OF MH AT ALLAN	NO INFORMATION AVAILABLE
397 RIVERTON AV			NO INFORMATION AVAILABLE
398 RIVERTON AV			NO INFORMATION AVAILABLE
400 RIVERTON AV	2.71 EWL LOT	110.34 E OF MH AT ALLAN	NO INFORMATION AVAILABLE
401 RIVERTON AV			NO INFORMATION AVAILABLE
403 RIVERTON AV			NO INFORMATION AVAILABLE
404 RIVERTON AV	2.44 EWL LOT	120.40 E OF MH AT ALLAN	NO INFORMATION AVAILABLE
405 RIVERTON AV			NO INFORMATION AVAILABLE
406 RIVERTON AV			NO INFORMATION AVAILABLE
407 RIVERTON AV			NO INFORMATION AVAILABLE

RIVERTON AVENUE

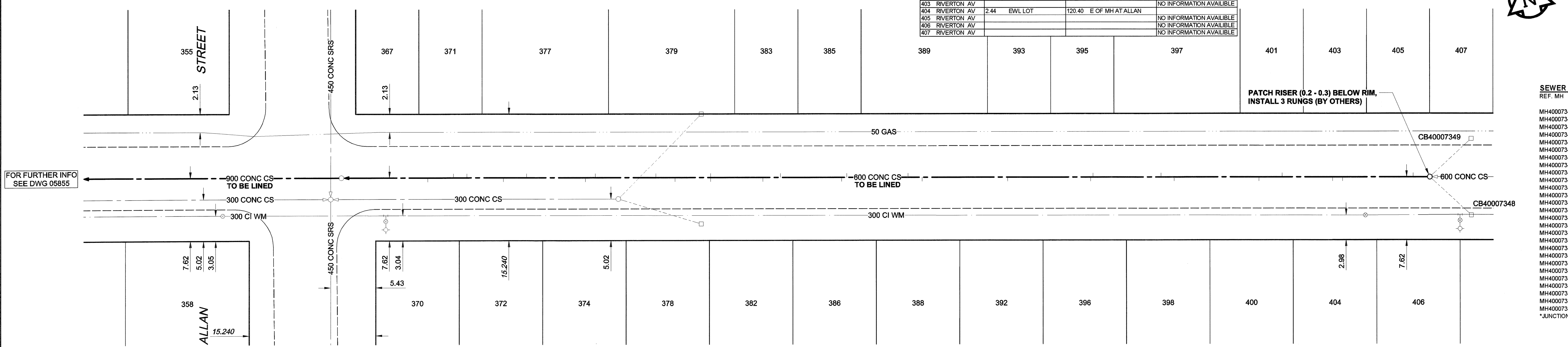

REF. MH	DIST FROM REF. MH	SIZE	CLOCK AT
MH40007344	2.00	1500	02
MH40007344	10.50	1500	11
MH40007344	11.70	1500	10
MH40007344	17.80	1500	02
MH40007344	20.60	1500	11
MH40007344	30.80	1500	10
MH40007344	32.40	1500	03
MH40007344	40.80	1500	02
MH40007344	40.90	1500	10
MH40007344	50.90	1500	10
MH40007344	61.20	1500	10
MH40007344	62.90	1500	02
MH40007344	70.30	1500	02
MH40007344	70.90	1500	10
MH40007344	78.30	1500	02
MH40007344	80.40	1500	10
MH40007344	86.70	1500	01
MH40007344	86.70	1500	10
MH40007344	91.00	1500	10
MH40007344	93.30	1500	02
MH40007344	100.60	1500	02
MH40007344	101.80	1500	10
MH40007344	108.90	1500	02
MH40007344	111.70	1500	10
MH40007344	116.10	1500	01
MH40007344	117.70	1500	03
MH40007344	120.80	1500	11

WARNING
 IF POWER EQUIPMENT OR EXPLOSIVES ARE TO BE USED FOR EXCAVATION ON THIS PROJECT, THE CONTRACTOR MUST:
 1) NOTIFY THE GAS COMPANY OF THE PROPOSED LOCATION OF EXCAVATION.
 2) TAKE PRECAUTION TO AVOID DAMAGE TO GAS COMPANY INSTALLATIONS.
 SEE PROVINCIAL REGULATION 140/92 FOR DETAILS

150 WM	WATERMAIN	150 WM	EXISTING	LEGEND - PLAN	NEW	EXISTING	LEGEND - PROFILE	NEW
○	HYDRANT	●	---	REDUCER	---	---	---	---
○	VALVE	●	---	COUPLING	---	---	---	---
○	LAND DRAINAGE SEWER	○	---	ANODE	---	---	---	---
○	WASTE WATER SEWER	○	---	HYDRO	---	---	---	---
○	MANHOLE	●	---	MTS	---	---	---	---
○	CATCH BASIN	■	---	GAS	---	---	---	---
○	CURB INLET	▲	---	TESTHOLE	---	---	---	---
○	CULVERT	◆	---	LAMP STANDARD	---	---	---	---
○	PIPE ABANDONMENTS	---	---	TREE	---	---	---	---
○	SURVEY BAR	---	---		---	---	---	---
○	EXISTING	---	---		---	---	---	---
○	LEGEND - PLAN	---	---		---	---	---	---

LOCATION APPROVED
 UNDERGROUND STRUCTURES
 SUPR. U/G STRUCTURES DATE COMMITTEE
 NOTE: LOCATION OF UNDERGROUND STRUCTURES AS SHOWN ARE BASED ON THE BEST INFORMATION AVAILABLE. BUT NO GUARANTEE IS GIVEN THAT ALL EXISTING UTILITIES ARE SHOWN OR THAT THE GIVEN LOCATIONS ARE EXACT. CONFIRMATION OF EXISTENCE AND EXACT LOCATION OF ALL SERVICES MUST BE OBTAINED FROM THE INDIVIDUAL UTILITIES BEFORE PROCEEDING WITH CONSTRUCTION.

NO.	ISSUED FOR CONSTRUCTION	DATE	BY
0	ISSUED FOR CONSTRUCTION	06/07/06	KMB
0	REVISIONS	YYMMDD	BY

UMA | AECOM
 © 2006 UMA ENGINEERING LTD. ALL RIGHTS RESERVED.
 DESIGNED BY: MJR
 DRAWN BY: KMB
 HOR. SCALE: 1:250
 VERT. SCALE: 1:50
 DATE: 06/07/07

APEGM
 Certificate of Authorization
 UMA Engineering Ltd.
 No. 256 Expiry: April 30, 2007

PROFESSIONAL'S SEAL
 PROVINCE OF MANITOBA
 09 July 2006
 C.C. MACEY
 REGISTERED ENGINEER
 CONSULTANT DRAWING NO. 27
 D265-207-01

THE CITY OF WINNIPEG
WATER AND WASTE DEPARTMENT
2006 COMBINED SEWER RENEWALS
BY CIPP LINING
CONTRACT 16
RIVERTON AVENUE
 1ST MH W OF WATT STREET TO MH AT ALLAN STREET

SHEET 27 OF 28
 CITY DRAWING NUMBER
05856
 REV 0

BID OPPORTUNITY NO. 273-2006