

D SIZE 22" x 34" (559mm x 864mm)

PLOT: 06/07/08 2:13:32 PM

UMA FILE NAME: D265-207-01_01-C-1007_RX.dwg Saved By: hobergard

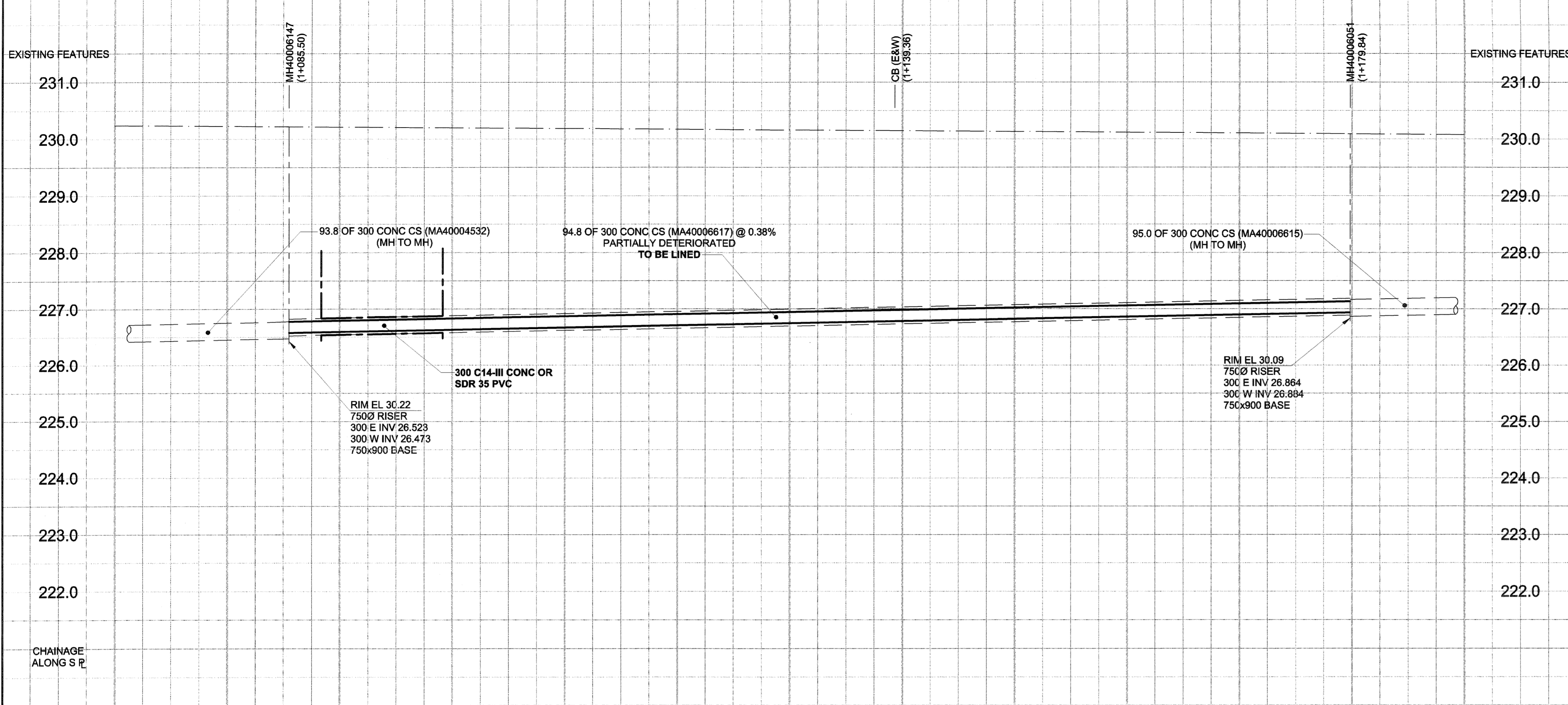

E PL BRAZIER STREET = 1+000,000

HAZEL DELL AVENUE

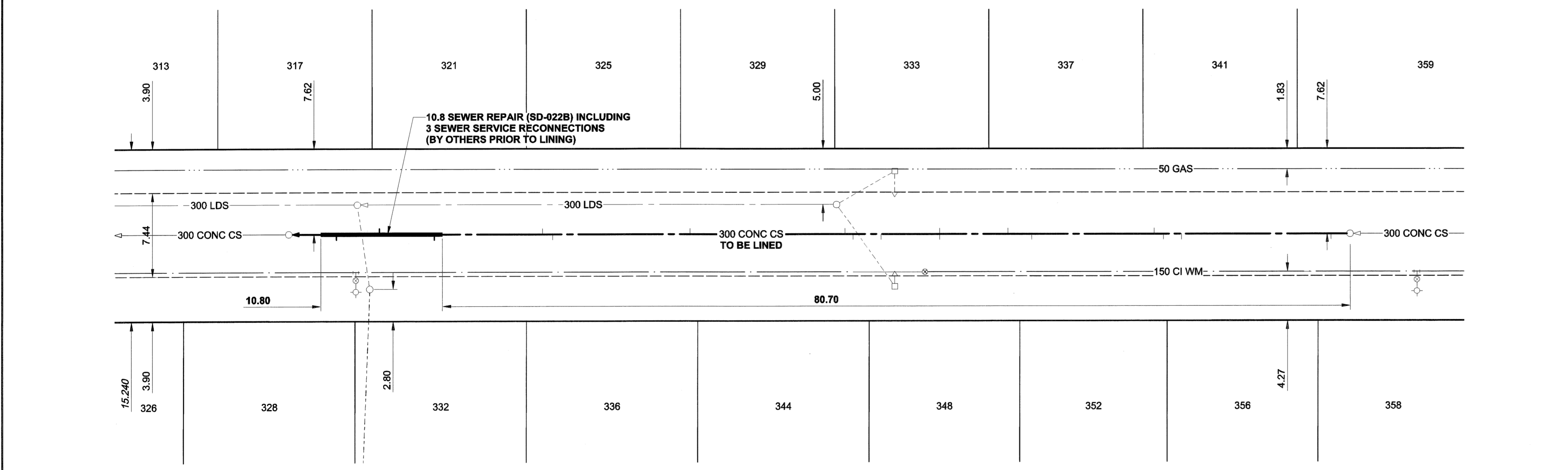

SEWER JUNCTION INFORMATION*

REF. MH	DIST FROM	SIZE	CLOCK AT
MH40006051	1.70	150Ø	10
MH40006051	15.00	150Ø	10
MH40006051	16.60	150Ø	11
MH40006051	17.40	150Ø	02
MH40006051	28.30	150Ø	10
MH40006051	30.40	150Ø	02
MH40006051	36.50	150Ø	02
MH40006051	36.50	150Ø	10
MH40006051	41.70	150Ø	09
MH40006051	44.20	150Ø	10
MH40006051	44.90	150Ø	02
MH40006051	58.70	150Ø	02
MH40006051	70.90	150Ø	10
MH40006051	71.80	150Ø	02
MH40006051	81.40	150Ø	10
MH40006051	86.30	150Ø	03
MH40006051	90.10	150Ø	11

*JUNCTION LOCATION FROM VIDEO INSPECTION

SEWER SERVICE INFORMATION

ADDRESS	PL TIE (SHORT/LONG)	JUNCTION TIE	REMARKS
317 HAZEL DELL AV			NO INFORMATION AVAILABLE
321 HAZEL DELL AV			NO INFORMATION AVAILABLE
325 HAZEL DELL AV			NO INFORMATION AVAILABLE
328 HAZEL DELL AV			NO INFORMATION AVAILABLE
329 HAZEL DELL AV			NO INFORMATION AVAILABLE
332 HAZEL DELL AV			NO INFORMATION AVAILABLE
333 HAZEL DELL AV			NO INFORMATION AVAILABLE
336 HAZEL DELL AV			NO INFORMATION AVAILABLE
337 HAZEL DELL AV			NO INFORMATION AVAILABLE
341 HAZEL DELL AV			NO INFORMATION AVAILABLE
344 HAZEL DELL AV			NO INFORMATION AVAILABLE
348 HAZEL DELL AV			NO INFORMATION AVAILABLE
352 HAZEL DELL AV			NO INFORMATION AVAILABLE
356 HAZEL DELL AV			NO INFORMATION AVAILABLE
358 HAZEL DELL AV			NO INFORMATION AVAILABLE

WARNING

IF POWER EQUIPMENT OR EXPLOSIVES ARE TO BE USED FOR EXCAVATION ON THIS PROJECT, THE CONTRACTOR MUST:

- 1) NOTIFY THE GAS COMPANY OF THE PROPOSED LOCATION OF EXCAVATION.
- 2) TAKE PRECAUTION TO AVOID DAMAGE TO GAS COMPANY INSTALLATIONS.

SEE PROVINCIAL REGULATION 140/92 FOR DETAILS

150 WM	WATERMAIN	150 WM	150 WM	CURB STOP	150 WM	WATERMAIN	150 WM
	HYDRANT		VALVE			HYDRANT	
	COUPLING		ANODE			VALVE	
	LAND DRAINAGE SEWER		HYDRO			LAND DRAINAGE SEWER	
	WASTE WATER SEWER		MTS			PAVEMENT CROWN	
	MANHOLE		GAS			N/W PROPERTY LINE	
	CATCH BASIN		TESTHOLE			S/E PROPERTY LINE	
	CURB INLET		LAMP STANDARD			N/W GUTTER	
	CULVERT		TREE			S/E GUTTER	
	PIPE ABANDONMENTS						
	SURVEY BAR						
	EXISTING		NEW			NEW	
	LEGEND - PLAN		LEGEND - PLAN			LEGEND - PROFILE	

LOCATION APPROVED
UNDERGROUND STRUCTURES

SUPR. U/G STRUCTURES DATE COMMITTEE

NOTE:
LOCATION OF UNDERGROUND STRUCTURES AS SHOWN ARE BASED ON THE BEST INFORMATION AVAILABLE. BUT NO GUARANTEE IS GIVEN THAT ALL EXISTING UTILITIES ARE SHOWN OR THAT THE GIVEN LOCATIONS ARE EXACT. CONFIRMATION OF EXISTENCE AND EXACT LOCATION OF ALL SERVICES MUST BE OBTAINED FROM THE INDIVIDUAL UTILITIES BEFORE PROCEEDING WITH CONSTRUCTION.

BM 12-057	N.W. Cor. Linden Ave. & Watt St., Tbl. on top of 0.05m dia. x 2.4m iron pipe, 1.5 m S. of N.L. of Linden Ave. & on W.L. of Watt St.
ELEV 230.475m	
0	ISSUED FOR CONSTRUCTION 06/07/08 KMB
NO.	REVISIONS YYMMDD BY

UMA | AECOM

© 2006 UMA ENGINEERING LTD. ALL RIGHTS RESERVED.

DESIGNED BY	MJR	CHECKED BY	A. Delaw
DRAWN BY	KMB	APPROVED BY	<i>[Signature]</i>
HOR. SCALE	1:250	RELEASED FOR CONSTRUCTION	<i>[Signature]</i>
VERT. SCALE	1:50	DATE	06/07/08

APEGM
Certificate of Authorization
UMA Engineering Ltd.
No. 256 Expiry: April 30, 2007

PROFESSIONAL'S SEAL
PROVINCE OF MANITOBA
07 July 2008
C. C. MACEY
REGISTERED ENGINEER
CONSULTANT DRAWING NO. 17
D265-207-01

THE CITY OF WINNIPEG
WATER AND WASTE DEPARTMENT

2006 COMBINED SEWER RENEWALS
BY CIPP LINING
CONTRACT 16
HAZEL DELL AVENUE
1ST MH W OF ROCH STREET
TO 2ND MH W OF ROCH STREET

SHEET 17 OF 28
CITY DRAWING NUMBER
05826

BID OPPORTUNITY NO. 273-2006