

D SIZE 22" x 34" (559mm x 864mm)

PLOT: 06/07/06 2:13:43 PM

UMA FILE NAME: D265-207-01\_01-C-1005\_RX.dwg Saved By: lbeard

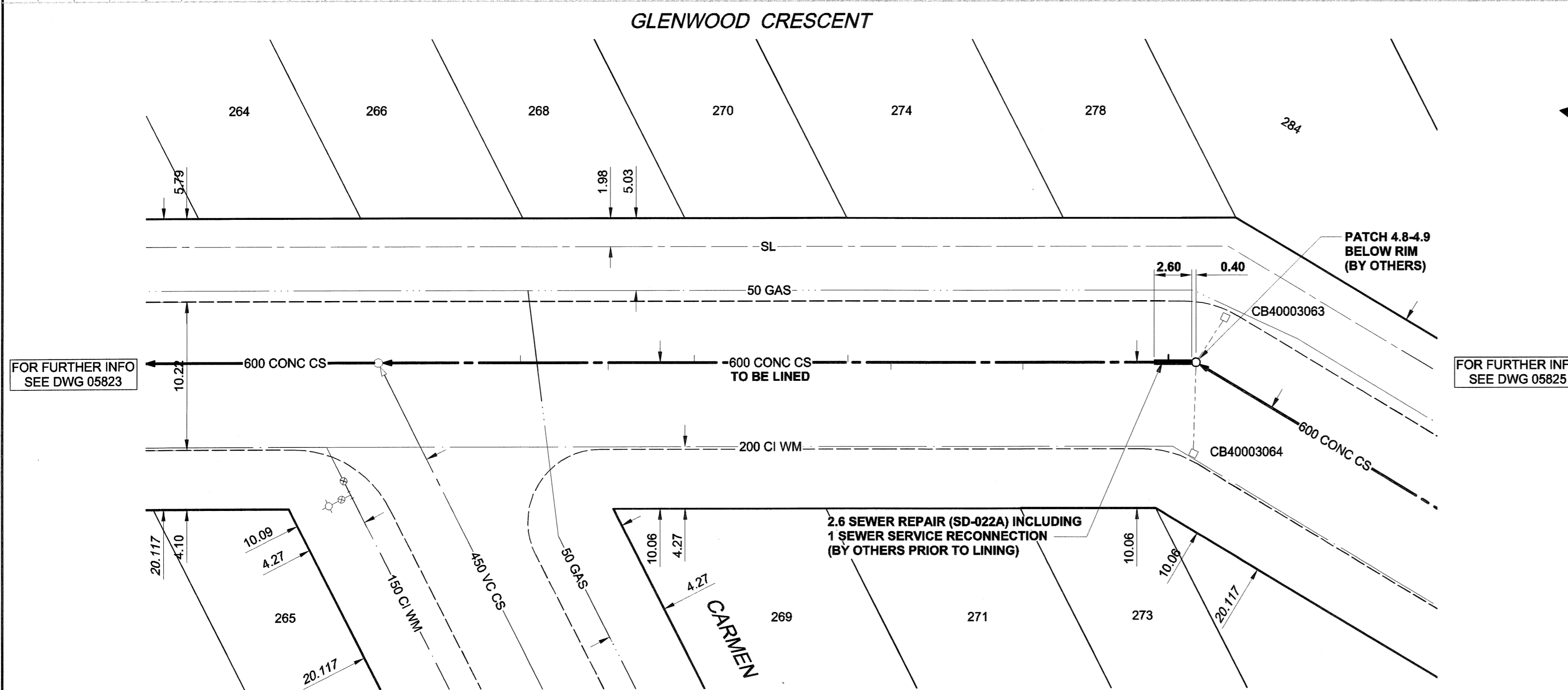
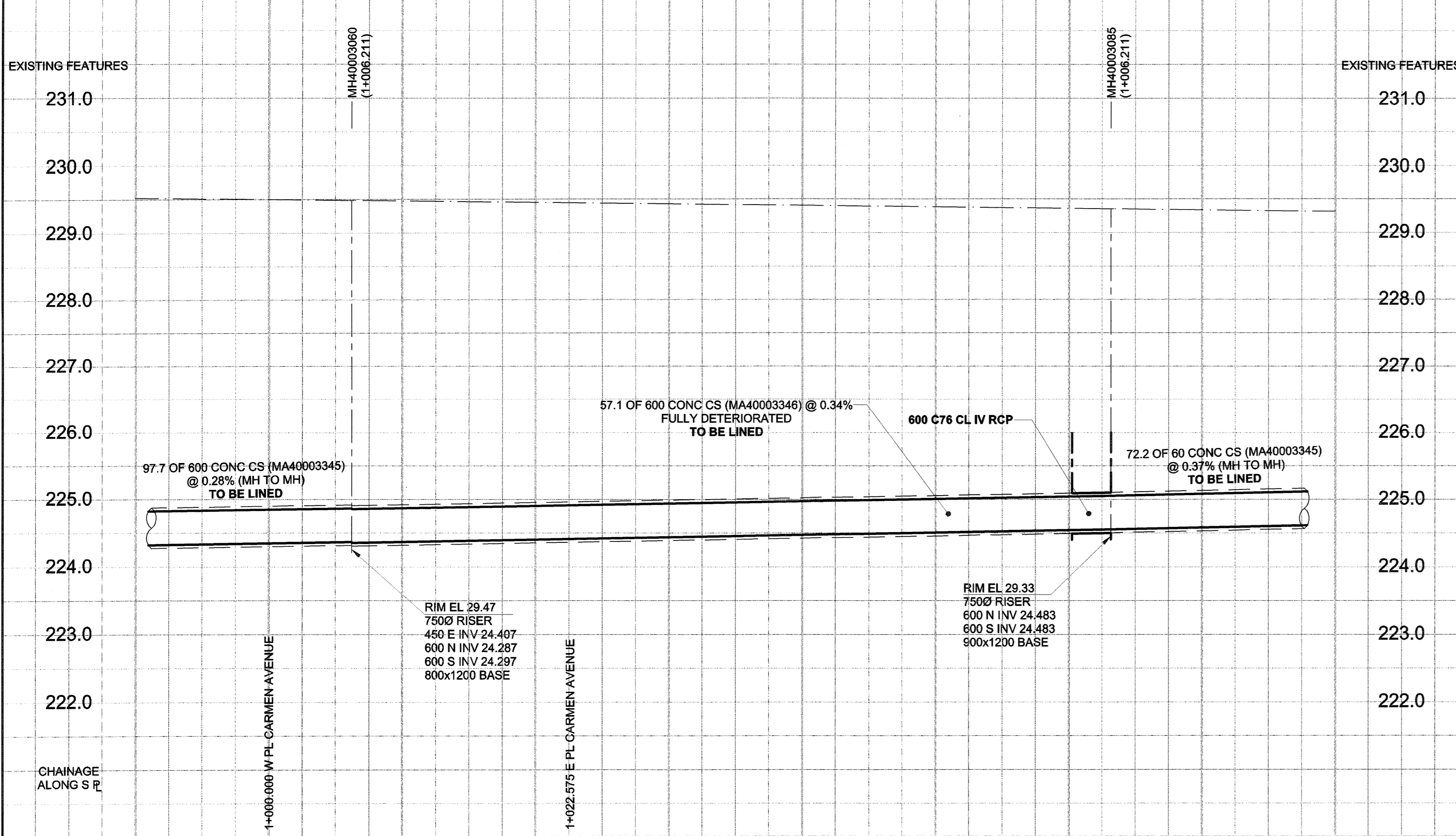

SEWER SERVICE INFORMATION			
ADDRESS	PL (SHORT/LONG)	TIE	JUNCTION TIE
288 GLENWOOD CR	2.13	NSL LOT	10.67 N OF MH AT CARMEN
289 GLENWOOD CR	118.90	EWL LOT	33.31 E OF MH AT GLENWOOD
270 GLENWOOD CR	1.83	NSL LOT	22.43 N OF MH AT CARMEN
271 GLENWOOD CR	4.27	NSL LOT	35.97 N OF MH AT CARMEN
273 GLENWOOD CR	2.74	NSL LOT	45.42 N OF MH AT CARMEN
274 GLENWOOD CR	10.61	NSL LOT	53.22 N OF MH AT CARMEN
278 GLENWOOD CR	5.79	NSL LOT	55.17 N OF MH AT CARMEN

SEWER JUNCTION INFORMATION*			
REF. MH	DIST FROM REF. MH	SIZE	CLOCK AT
MH40003065	1.90	1500	01
MH40003066	9.90	1500	11
MH40003066	16.00	1500	01
MH40003066	22.00	1500	11
MH40003066	32.70	1500	11
MH40003066	35.70	1500	01
MH40003066	44.90	1500	01

\*JUNCTION LOCATION FROM VIDEO INSPECTION

**WARNING**  
 IF POWER EQUIPMENT OR EXPLOSIVES ARE TO BE USED FOR EXCAVATION ON THIS PROJECT, THE CONTRACTOR MUST:  
 1) NOTIFY THE GAS COMPANY OF THE PROPOSED LOCATION OF EXCAVATION.  
 2) TAKE PRECAUTION TO AVOID DAMAGE TO GAS COMPANY INSTALLATIONS.  
 SEE PROVINCIAL REGULATION 140/92 FOR DETAILS.

EXISTING	LEGEND - PLAN	NEW	EXISTING	LEGEND - PLAN	NEW	EXISTING	LEGEND - PROFILE	NEW
150 WM	WATERMAIN	150 WM	○	CURB STOP	○	150 WM	WATERMAIN	150 WM
○	HYDRANT	○	○	REDUCER	○	○	HYDRANT	○
○	VALVE	○	○	COUPLING	○	○	VALVE	○
300 LDS	LAND DRAINAGE SEWER	300 LDS	○	ANODE	○	300 LDS	LAND DRAINAGE SEWER	300 LDS
250 WWS	WASTE WATER SEWER	250 WWS	○	HYDRO	○	250 WWS	WASTE WATER SEWER	250 WWS
○	MANHOLE	○	○	MTS	○	○	PAVEMENT CROWN	○
○	CATCH BASIN	○	○	GAS	○	○	N/W PROPERTY LINE	○
○	CURB INLET	○	○	TESTHOLE	○	○	S/E PROPERTY LINE	○
○	CULVERT	○	○	LAMP STANDARD	○	○	N/W GUTTER	○
○	PIPE ABANDONMENTS	○	○	TREE	○	○	S/E GUTTER	○
○	SURVEY BAR	○						

**LOCATION APPROVED**  
 UNDERGROUND STRUCTURES

DATE: \_\_\_\_\_

NOTE: LOCATION OF UNDERGROUND STRUCTURES AS SHOWN ARE BASED ON THE BEST INFORMATION AVAILABLE. BUT NO GUARANTEE IS GIVEN THAT ALL EXISTING UTILITIES ARE SHOWN OR THAT THE GIVEN LOCATIONS ARE EXACT. CONFIRMATION OF EXISTENCE AND EXACT LOCATION OF ALL SERVICES MUST BE OBTAINED FROM THE INDIVIDUAL UTILITIES BEFORE PROCEEDING WITH CONSTRUCTION.

BM 27-028	N.E. Cor. Beatrice St. & Carmen Ave., 10' on top of 0.05m dia. x 2.4m from pipe in Valve Box 2.7m W. of E.L. of Beatrice St. & 5.2m s. of N.L. of Carmen Ave.
ELEV 228.386m	
NO.	REVISIONS
0	ISSUED FOR CONSTRUCTION 06/07/06 KMB
	YYMMDD BY

UMA   AECOM	
© 2006 UMA ENGINEERING LTD. ALL RIGHTS RESERVED.	
DESIGNED BY: MJR	CHECKED BY: A. Delann
DRAWN BY: KMB	APPROVED BY: [Signature]
HOR. SCALE: 1:250	RELEASED FOR CONSTRUCTION: [Signature]
VERT. SCALE: 1:50	DATE: 06/07/07

**APGM**  
 Certificate of Authorization  
 UMA Engineering Ltd.  
 No. 256 Expiry: April 30, 2007

PROFESSIONAL'S SEAL  
 PROVINCE OF MANITOBA  
 07 July 2006  
 C. C. MACEY  
 REGISTERED ENGINEER  
 CONSULTANT DRAWING NO. 15  
 D265-207-01

**THE CITY OF WINNIPEG**  
 WATER AND WASTE DEPARTMENT

**2006 COMBINED SEWER RENEWALS**  
 BY CIPP LINING  
 CONTRACT 16

GLENWOOD CRESCENT  
 1ST MH S OF MARTIN AVENUE  
 TO MH AT CARMEN AVENUE

SHEET 15 OF 28  
 CITY DRAWING NUMBER 05824  
 REV 0

BID OPPORTUNITY NO. 273-2006