

CHAINAGE ALONG WEST PROPERTY LINE OF ST. JEAN BAPTISTE ST.
RUE ST. JEAN BAPTISTE

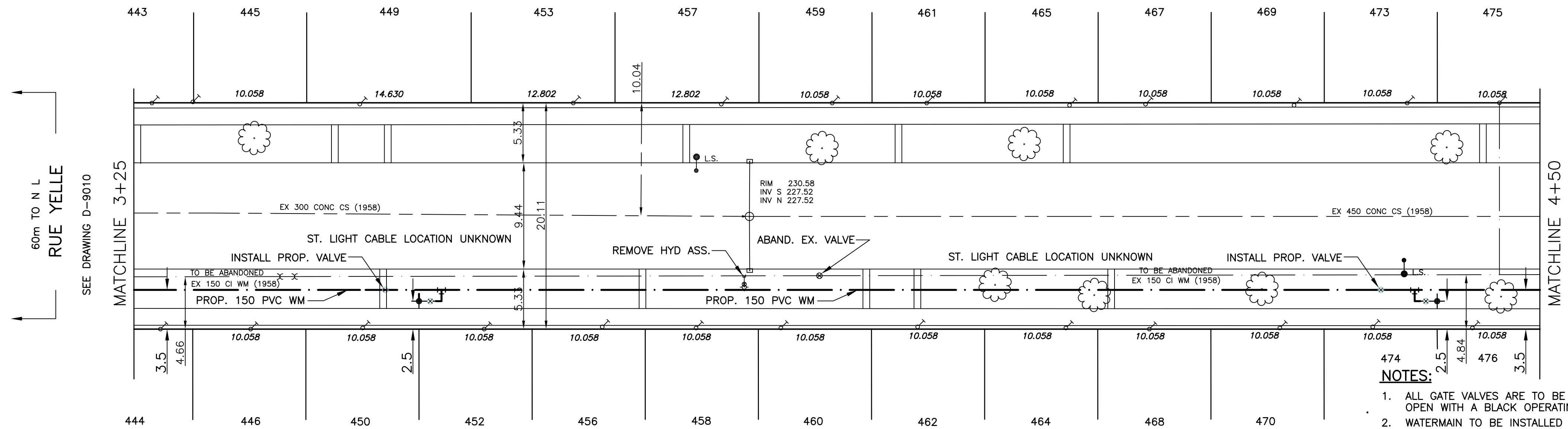
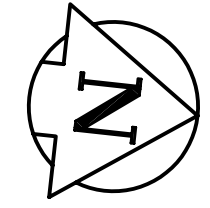

WATER SERVICE INFORMATION ADDRESS & NATURE OF SERVICE	SIZE(mm) & TYPE (STREET)	SIZE(mm) & TYPE (PROP)	SHORT & LONG MEASUREMENT	CORP LOCATION	REMARKS
474 St. Jean Baptiste St. Residential	19 Copper		3.6 RL CR OF HSE 57.0 N/2ND HYD N/BERTRAND		
475 St. Jean Baptiste St. Residential	19 Copper		4.6 S OF N 269 N OF DOLLARD	OPP S/C	
476 St. Jean Baptiste St. Residential	19 Copper		1.8 LR CR OF HSE 65.8 N/2ND HYD N/BERTRAND		
477 St. Jean Baptiste St. Residential	19 Copper		1.5 LR CR OF HSE 269.4 N OF DOLLARD		

- NOTES:**
- ALL GATE VALVES ARE TO BE COUNTER-CLOCKWISE TO OPEN WITH A BLACK OPERATING NUT.
 - WATERMAIN TO BE INSTALLED BY TRENCHLESS METHODS.
 - BACKFILL IS CLASS 5 WITHIN BOULEVARD AND CLASS 3 WHEN WITHIN PAVEMENT/SIDEWALK OR WHEN WITHIN 1.0m OF PAVEMENT OR SIDEWALK.
 - WATER SERVICES ARE 19mm COPPER UNLESS OTHERWISE NOTED.
 - MINIMUM COVER TO TOP OF WATERMAIN SHALL BE 2.4m.
 - LOCATION OF ALL SERVICES TO BE CONFIRMED IN FIELD.
 - EXPOSE EXISTING WATERMAIN TO CONFIRM DEPTH PRIOR TO CONSTRUCTION.
 - ALL LEAD SERVICES TO BE RENEWED.
 - SERVICES TO BE RENEWED SHALL BE REPLACED FROM WATERMAIN TO PROPERTY LINE. ALL OTHERS TO BE RECONNECTED.

BENCHMARK:
BM 034-011
ELEV. 231.413

METRIC
WHOLE NUMBERS INDICATE MILLIMETRES
DECIMALIZED NUMBERS INDICATE METRES



EXISTING	LEGEND - PLAN	PROPOSED	EXISTING	LEGEND - PROFILE	PROPOSED
	WATERMAIN			HYDRO	
	HYDRANT			M.T.S.	
	VALVE			CONCRETE	
	LAND DRAINAGE SEWER			ASPHALT	
	WASTE WATER SEWER			PROPERTY LINE	
	MANHOLE			SURVEY BAR	
	CATCH BASIN			CURB STOP	
	CURB INLET			C.B. LEAD	
	TRAFFIC SIGNAL			SIDEWALK	
	GAS				

LOCATION APPROVED	DATE
SUPV. U/G STRUCTURES	
DATE	

NOTE:
LOCATION OF UNDERGROUND STRUCTURES AS SHOWN ARE BASED ON THE BEST INFORMATION AVAILABLE BUT NO GUARANTEE IS GIVEN THAT ALL EXISTING UTILITIES ARE SHOWN OR THAT THE GIVEN LOCATIONS ARE EXACT. CONFIRMATION OF EXISTENCE AND EXACT LOCATION OF ALL SERVICES MUST BE OBTAINED FROM THE INDIVIDUAL UTILITIES BEFORE PROCEEDING WITH CONSTRUCTION.

SEG ENGINEERING INC.
200 TACHE AVENUE
WINNIPEG, MANITOBA
(204)-233-2113

DESIGNED BY: DJ
CHECKED BY: SM
DRAWN BY: RH
APPROVED BY: IMck
HOR. SCALE: 1:250
VERT. SCALE: 1:50
RELEASED FOR ORIGINAL CONSTRUCTION
SIGNED BY: K. ZUREK P. ENG
DATE: May 12, 2006



THE CITY OF WINNIPEG

2006 CAPITAL WORKS
WATERMAIN RENEWALS - CONTRACT 21
RUE ST. JEAN BAPTISTE
65 M NORTH OF RUE YELLE
TO 190 M NORTH OF RUE YELLE

CITY DRAWING NO.
SHEET 3 OF 4
D-9011