

**NOTES:**  
 1. CONTRACTOR TO VERIFY LIMITS OF SEWER REPAIRS PRIOR TO EXCAVATION BY MEANS OF VIDEO INSPECTION.  
 2. CONTRACTOR TO PROVIDE VIDEO INSPECTION OF SEWER SERVICES WITHIN LIMITS OF REPAIR IN PRESENCE OF CONTRACT ADMINISTRATOR TO DETERMINE IF SERVICE RENEWAL IS REQUIRED.

SEWER SERVICE INFORMATION		
ADDRESS	SIZE	R DIST JUNCTION TIE
473 TELFER ST RESIDENTIAL	-	98.8 N MH WOLSELEY
476 TELFER ST RESIDENTIAL	-	100.0 N MH WOLSELEY

SEWER JUNCTION INFORMATION			
DISTANCE FROM 2nd MH S OF PORTAGE AVE (ID S-MH20010484)			
3.8	S	-	WEST UNKNOWN LOCATION
5.1	S	-	EAST UNKNOWN LOCATION

INFORMATION FROM SEWER VIDEO INSPECTION

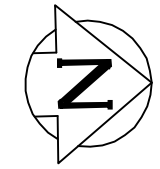
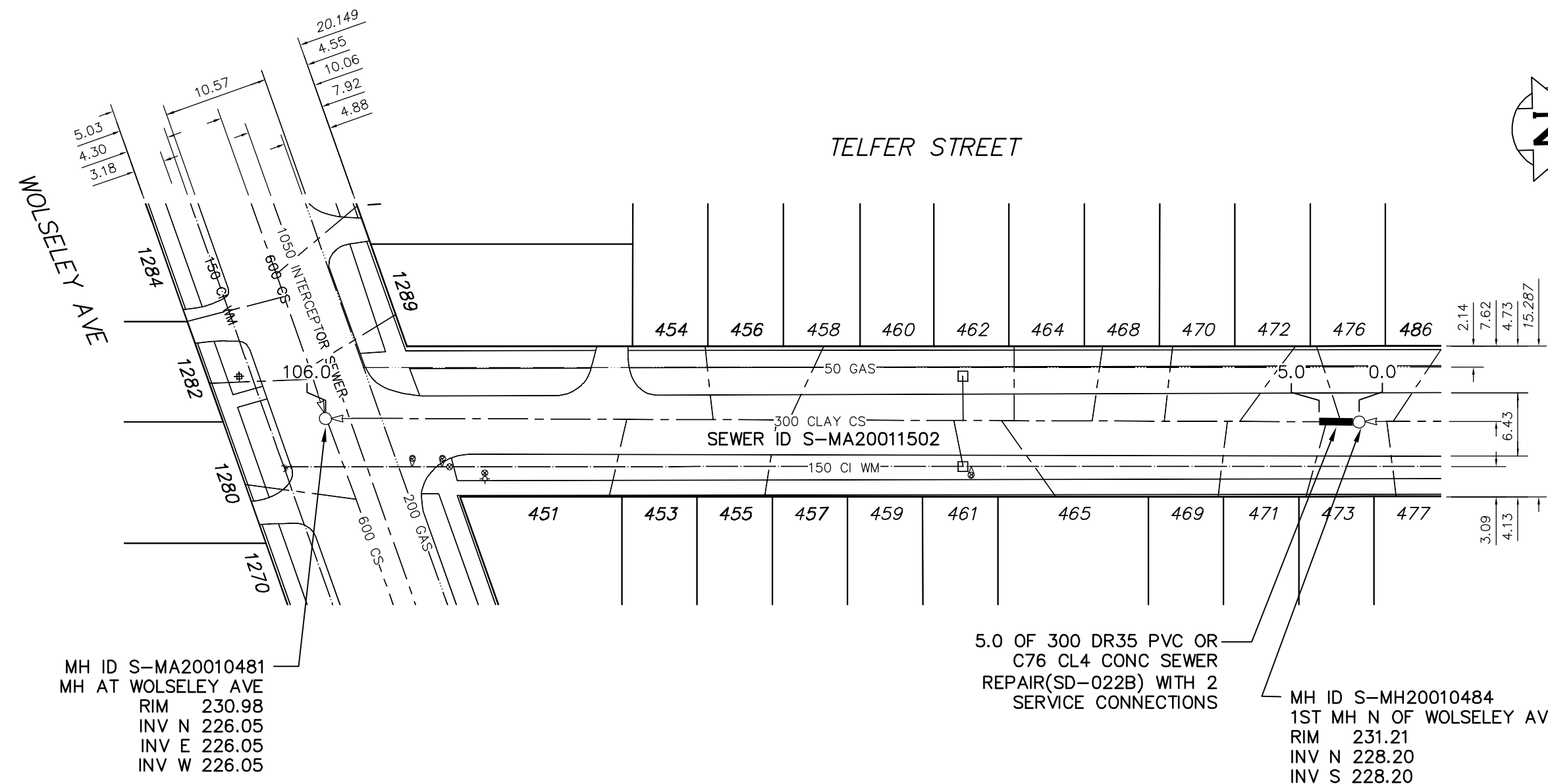

MH ID S-MA20010481  
 MH AT WOLSELEY AVE  
 RIM 230.98  
 INV N 226.05  
 INV E 226.05  
 INV W 226.05

5.0 OF 300 DR35 PVC OR  
 C76 CL4 CONC SEWER  
 REPAIR(SD-022B) WITH 2  
 SERVICE CONNECTIONS

MH ID S-MH20010484  
 1ST MH N OF WOLSELEY AVE  
 RIM 231.21  
 INV N 228.20  
 INV S 228.20

ENGINEER'S SEAL

ORIGINAL SIGNED  
 BY S.R.J.  
 COURNOYER  
 06/01/27

BID OPPORTUNITY No: 25-2006  
 FILENAME : Telfer\_EPR.dwg  
 PLOT DATE : 2006 01 27

**LEGEND:**  
 52.0 | MEASUREMENT TO REPAIR FROM REFERENCE MH SHOWN THUS...

**METRIC**  
 WHOLE NUMBERS INDICATE MILLIMETRES  
 DECIMALIZED NUMBERS INDICATE METRES

B.M. ELEV.	FIELD BOOK #:	<b>CITY OF WINNIPEG WATER AND WASTE ENGINEERING DIVISION</b>			<b>THE CITY OF WINNIPEG WATER AND WASTE DEPARTMENT</b>
POSTED TO LBIS		DESIGNED BY SC	CHECKED BY TW/KZ		
		DRAWN BY C.JH/PB	APPROVED BY KZ	2005 COMBINED SEWER RENEWALS AND SEWER REPAIRS	
		HOR. SCALE 1:500	RELEASED FOR CONSTRUCTION	<b>TELFER STREET</b>	
		VERTICAL		1ST MH N OF WOLSELEY AVENUE TO MH AT WOLSELEY AVENUE	
NO. REVISIONS	DATE	BY	DATE 2006 01 27	DATE	SHEET 14 OF 14 CITY DRAWING NUMBER 05750