

SECTION B
L5
SCALE 1:10
TYPICAL THROUGH RETAINING WALL

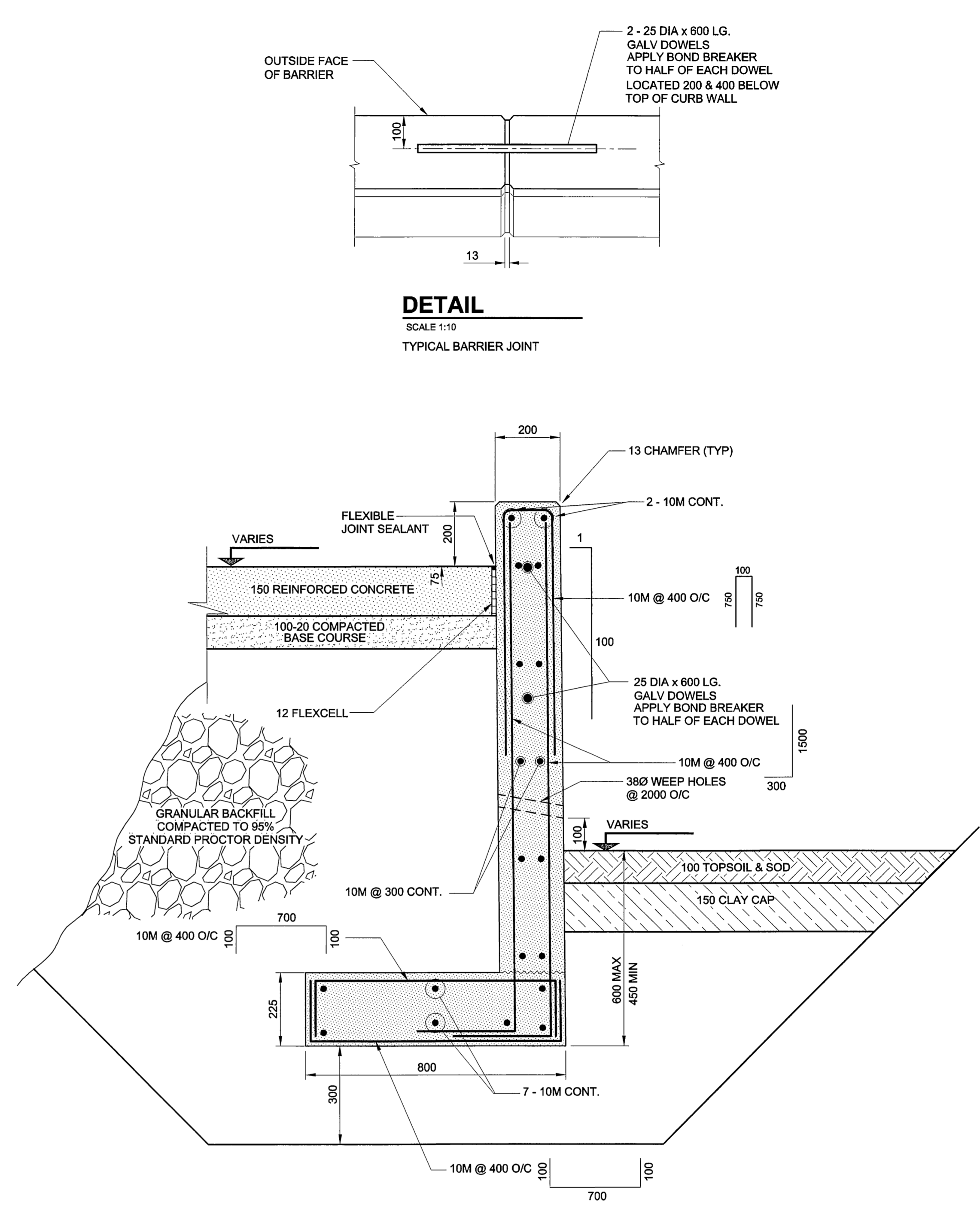

SECTION C
L5
SCALE 1:10
TYPICAL THROUGH CURB WALL

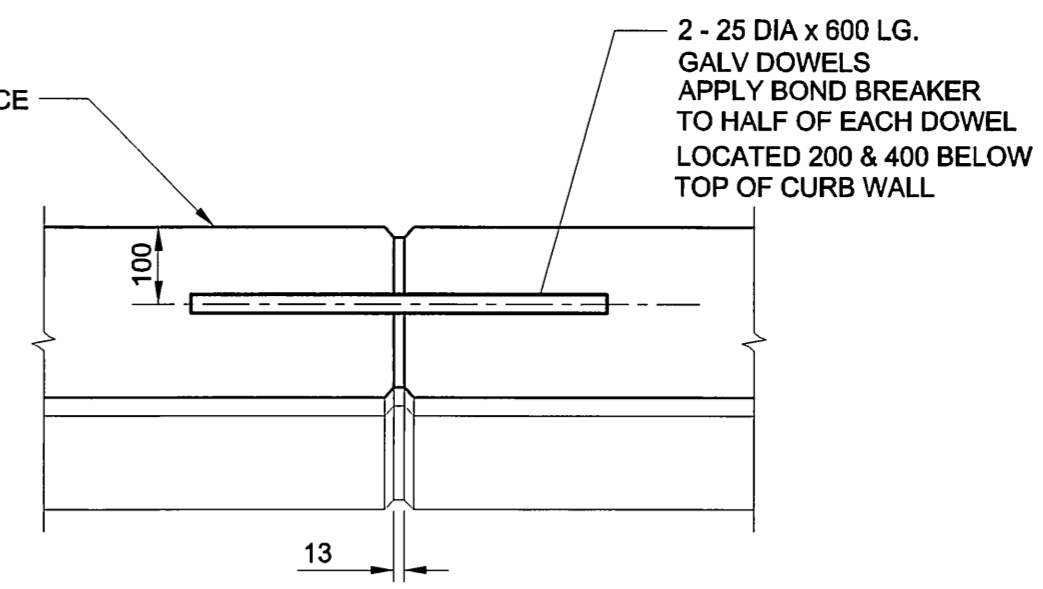

DETAIL
SCALE 1:10
TYPICAL BARRIER JOINT

LOCATION APPROVED
UNDERGROUND STRUCTURES

SUPR. U/G STRUCTURES DATE COMMITTEE

NOTE:
LOCATION OF UNDERGROUND STRUCTURES AS SHOWN ARE BASED ON THE BEST INFORMATION AVAILABLE. BUT NO GUARANTEE IS GIVEN THAT ALL EXISTING UTILITIES ARE SHOWN OR THAT THE GIVEN LOCATIONS ARE EXACT. CONFIRMATION OF EXISTENCE AND EXACT LOCATION OF ALL SERVICES MUST BE OBTAINED FROM THE INDIVIDUAL UTILITIES BEFORE PROCEEDING WITH CONSTRUCTION.

APECM
Certificate of Authorization
UMA Engineering Ltd.
No. 256 Expiry: April 30, 2007

NO.	REVISIONS	DATE	BY
B	ISSUED FOR BID	06/05/17	WJd
A	ISSUED FOR REVIEW	06/03/10	KMB

UMA AECOM	
© 2005 UMA ENGINEERING LTD. ALL RIGHTS RESERVED.	
DESIGNED BY SBB	CHECKED BY
DRAWN BY WJd	APPROVED BY <i>[Signature]</i>
HOR. SCALE 1:250	RELEASED FOR CONSTRUCTION
VERT. SCALE -	DATE 06/05/17

PROFESSIONAL'S SEAL
PROVINCE OF MANITOBA
REGISTERED PROFESSIONAL ENGINEER
[Signature]
S.B. BISWANGER
CONSULTANT DRAWING NO. 06
0265-378-00

TENDER NO. 225-2006

THE CITY OF WINNIPEG
PUBLIC WORKS DEPARTMENT

LUXTON COMMUNITY CENTRE
SITE DEVELOPMENT PROJECT
Luxton / St. John's Park / Seven Oaks

Building Communities Initiative Plan
RETAINING WALL SECTIONS

CITY DRAWING NUMBER	6 OF 8
SHEET	6 OF 8
REV	L6 B