

SAND FILLED BARREL SYSTEM DETAIL
SCALE: 1:100

TYPICAL CROSS SECTION OF PR 207 IN THE VICINITY OF THE RAILWAY
SCALE: HOR. 1:150 VERT. 1:50

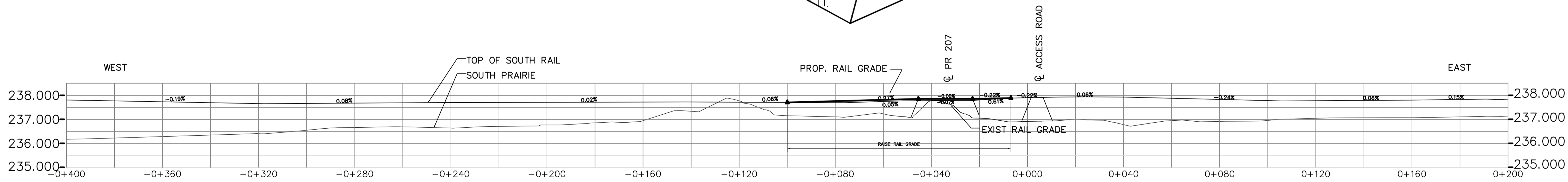

PROFILE - GWWD RAILWAY
SCALE: HOR. 1:1000 VERT. 1:100

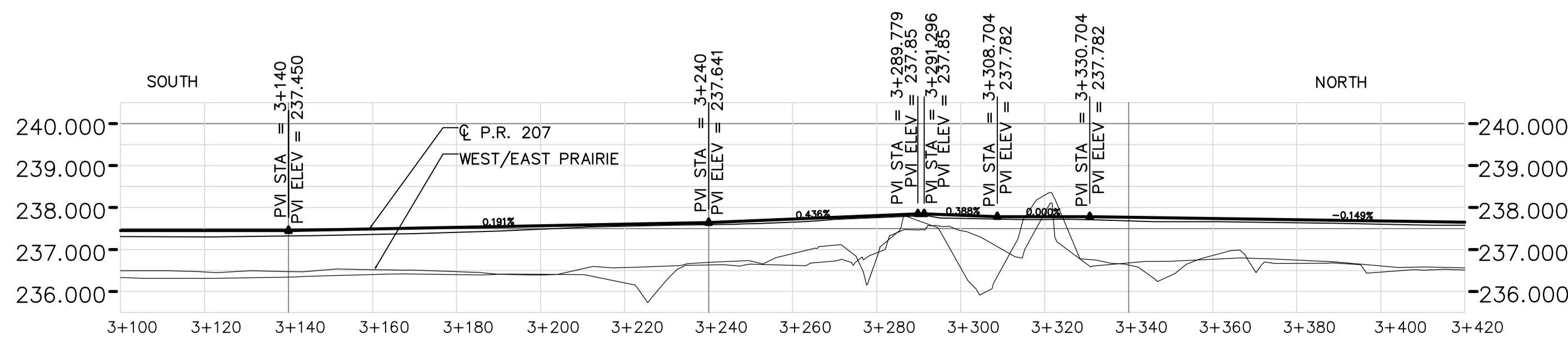

PROFILE - PR 207
SCALE: HOR. 1:1000 VERT. 1:100

Released to the City of Winnipeg for Tendering Purposes
ORIGINAL SIGNED
Eric Christiansen P.Eng.
Director of Highway Planning & Design
Manitoba Transportation & Government Services
Date: MAY 16, 2006
MTGS Plan No. 7161

APEGM
Certificate of Authorization
Earth Tech Canada Inc.
No. 730 Expiry: April 30, 2007

CH2M HILL Frederickson Cooper ARCHITECTS		EarthTech A Tyco International Ltd. Company		ENGINEER'S SEAL ORIGINAL SIGNED BY JEFF CRANG May 16, 2006		THE CITY OF WINNIPEG WATER AND WASTE DEPARTMENT ENGINEERING DIVISION WINNIPEG WATER TREATMENT PROGRAM - PROVINCIAL ROAD #207 UPGRADE CIVIL RAILWAY CROSSING PLAN - PR #207		CITY FILE NUMBER SHEET OF CITY DRAWING NUMBER 1-0601A-CO172-001-00D	
DESIGNED BY	JC	CHECKED BY	JC	CONSULTANT DRAWING NO.	WN-CO172				
DRAWN BY	MW	APPROVED BY	AHL						
SCALE:	AS NOTED	RELEASED FOR CONSTRUCTION BY:	R. SOROKOWSKI						
NO.	ISSUED FOR TENDER	DATE	06/05/16	DATE	2006/03/28				
NO.	REVISIONS	DATE		DATE	May 16, 2006				