

6 SECTION
TM2.02 SCALE 1:50

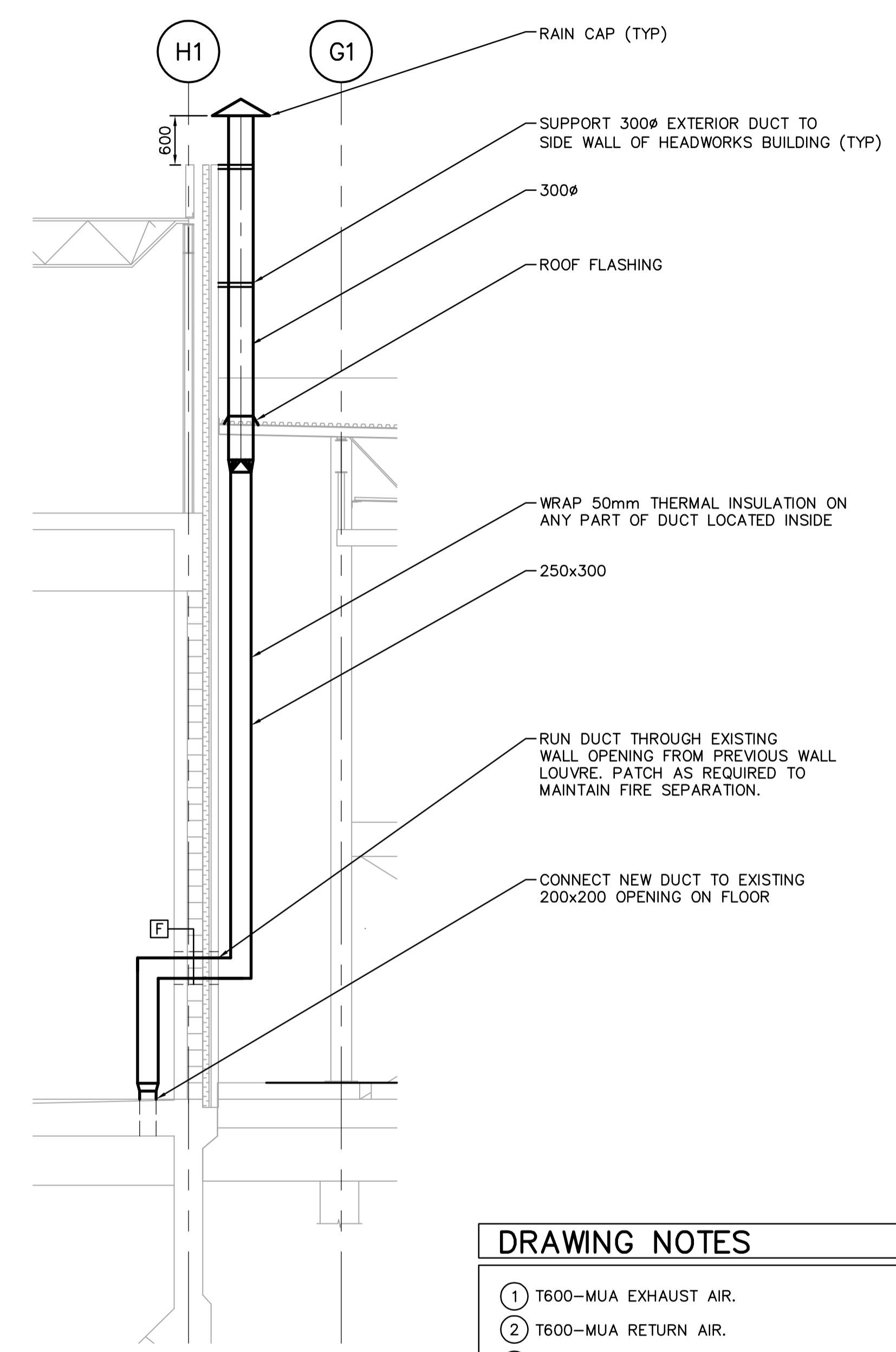

7 SECTION
TM2.02 SCALE 1:50

DRAWING NOTES

- 1 T600-MUA EXHAUST AIR.
- 2 T600-MUA RETURN AIR.
- 3 EXHAUST DUCT OF 2 DAF TANKS.
- 4 TYPICAL FLEXIBLE DUCT CONNECTIONS.
- 5 MOTORIZED DAMPER.
- 6 ALL INTERIOR EXHAUST DUCTWORK FROM T600-MUA SHALL HAVE 50mm THERMAL EXTERNAL INSULATION AND ALUMINUM JACKET.

GENERAL NOTES

1. COORDINATE WITH OTHER TRADES SO AS TO PREVENT CONFLICTS.
2. ALL DUCTWORK SHALL BE SUPPORTED AND SUSPENDED AS PER SPECIFICATIONS AND LOCAL CODES (SEE DETAILS).
3. ALL DUCTWORK TO BE STAINLESS STEEL CONSTRUCTION.



B.M. ELEV.	 A Tyco International Ltd. Company		ENGINEER'S SEAL	
			ORIGINAL SIGNED BY A. BURACHYNSKY	2006/04/26
DESIGNED BY LJW/DC	CHECKED BY PVL	CONSULTANT DRAWING NO. TM4.03		 THE CITY OF WINNIPEG WATER AND WASTE DEPARTMENT ENGINEERING DIVISION
DRAWN BY LJW/DL	APPROVED BY JEH	WEWPC BIOLOGICAL NUTRIENT REMOVAL UPGRADE CONTRACT 3		
01 21-2006 ADDENDUM 6 06/07/04 DC	HOR. SCALE: 1:50		RELEASED FOR CONSTRUCTION BY: J. VEILLEUX	CITY FILE NUMBER
00 ISSUED FOR TENDER 06/04/26 DC	VERTICAL SCALE:			SHEET OF
NO. REVISIONS	DATE	BY	DATE	CITY DRAWING NUMBER
	2006/01/04		2006/04/26	MECHANICAL AREA T - DAF THICKENER BUILDING SECTION