

- NOTES:**
- SEE MCC #2A & #2B SINGLE LINE DIAGRAM AND DP-P11 & DP-P12 POWER DISTRIBUTION FOR 600V POWER DISTRIBUTION.
 - SEE LP-P11 FOR 120/208V POWER DISTRIBUTION.
 - PROVIDE STAIRWELL SMOKE DETECTORS AT EVERY THIRD FLOOR AND AT TOP.

CABLE TRAY TAGGING
SEE DETAIL
3
WB-E0455

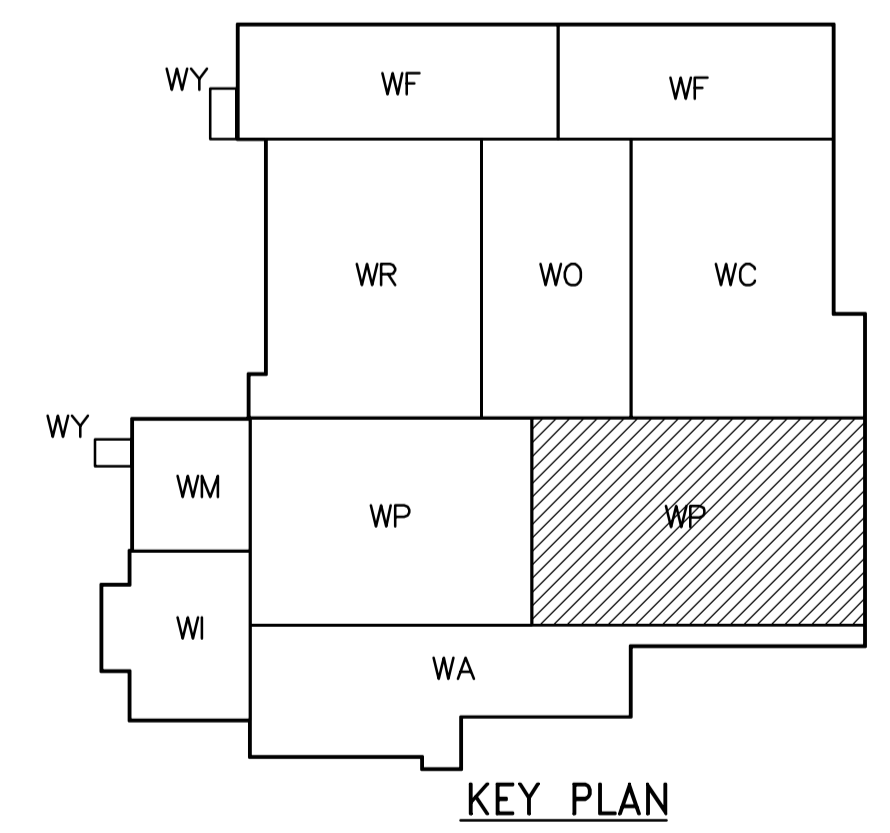

FIRST FLOOR FACILITY PLAN (AREA 2)
1:100

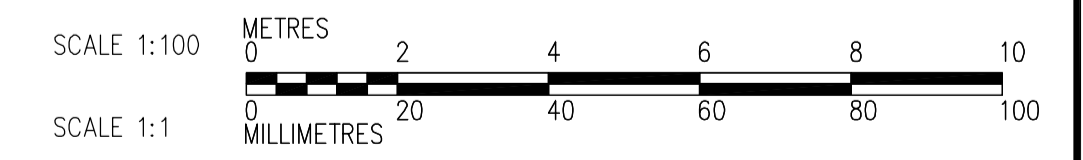

<p>APEGN Certificate of Authorization CH2M HILL Canada Ltd. No. 1441 Expiry: April 30, 2006</p>	<p>Frederickson Cooper ARCHITECTS</p>	<p>EarthTech A Tyco International Ltd. Company</p>	ENGINEER'S SEAL	<p>THE CITY OF WINNIPEG WATER AND WASTE DEPARTMENT ENGINEERING DIVISION</p>		
			DESIGNED BY JT		CHECKED BY ND	ORIGINAL SIGNED BY L.D. LLEWELLYN
			DRAWN BY KJ		APPROVED BY AHL	2006/03/29
			SCALE: 1:100		RELEASED FOR CONSTRUCTION BY: R. SOROKOWSKI	CONSULTANT DRAWING NO. WP-E0112
00 ISSUED FOR TENDER 06/03/29 LL	NO. REVISIONS DATE BY DATE 2005/07/12	DATE 2006/03/29	WATER TREATMENT PLANT FLOCCULATION AND DAF MECHANICAL AND ELECTRICAL	CITY FILE NUMBER		
			ELECTRICAL FLOC/DAF AREA 2 FIRST FLOOR FACILITY PLAN	SHEET OF		
				CITY DRAWING NUMBER 1-0601P-A-E0112-001-000		