

- NOTES:**
- REFER TO SUPPLY CONTRACTOR SHOP DRAWINGS FOR EQUIPMENT DETAILS.
 - VALVES HV-0210A TO HV-0210H AND HV-0230A TO HV-0230H ARE ON VERTICAL OF SAMPLE LINES FROM CONTACTOR CELLS.

1 DETAIL 1:20

1 DETAIL 1:50

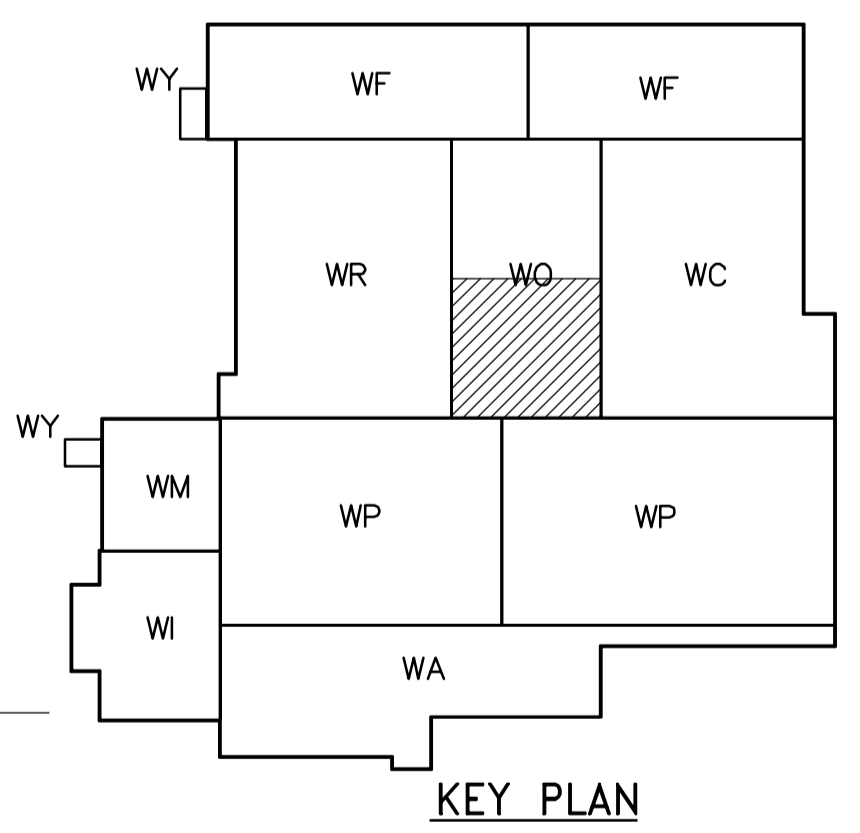
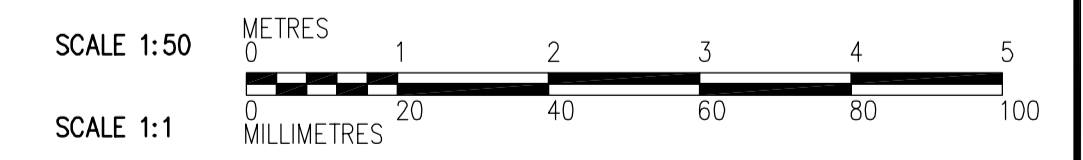

APECM
 Certificate of Authorization
 CH2M HILL Canada Ltd.
 No. 1441 Expiry: April 30, 2006

B.M. ELEV.			
DESIGNED BY	CBE/DP	CHECKED BY	EPM
DRAWN BY	RWA/KM	APPROVED BY	AHL
SCALE:	1:50	RELEASED FOR CONSTRUCTION BY:	R. SOROKOWSKI
ISSUED FOR TENDER	06/03/29	DATE	2006/02/14
NO. REVISIONS		DATE	2006/03/29

CH2MHILL
 Frederickson Cooper
 ARCHITECTS

EarthTech
 A Yoo International Ltd. Company

ENGINEER'S SEAL
 ORIGINAL SIGNED BY
 D.J. PERNITSKY
 2006/03/29
 CONSULTANT DRAWING NO.
 WO-M0402

THE CITY OF WINNIPEG
 WATER AND WASTE DEPARTMENT
 ENGINEERING DIVISION

WATER TREATMENT PLANT
 OZONE
 MECHANICAL AND ELECTRICAL

PROCESS MECHANICAL
 OZONATION AREA
 PLAN DETAIL

CITY FILE NUMBER
 SHEET OF
 CITY DRAWING NUMBER
 1-06010-A-M0402-001-000