

- NOTES:**
1. ALL 120V AND 208V LOADS ARE FED FROM LP-M11.
 2. EMERGENCY LIGHTING EM-X-1, -2 ETC ARE FED FROM BATTERY PACK EM-X.
 3. MOUNT TYPE H LUMINAIRE AT 5m ABOVE FINISHED FLOOR.

FIRST FLOOR POWER AND LIGHTING PLAN
1:100

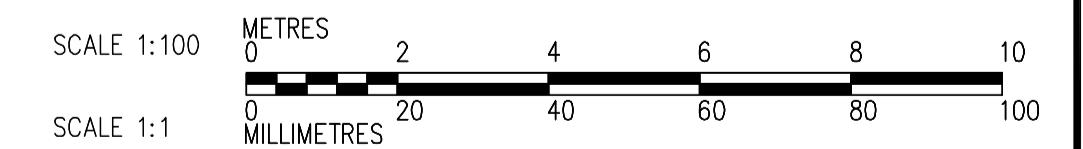
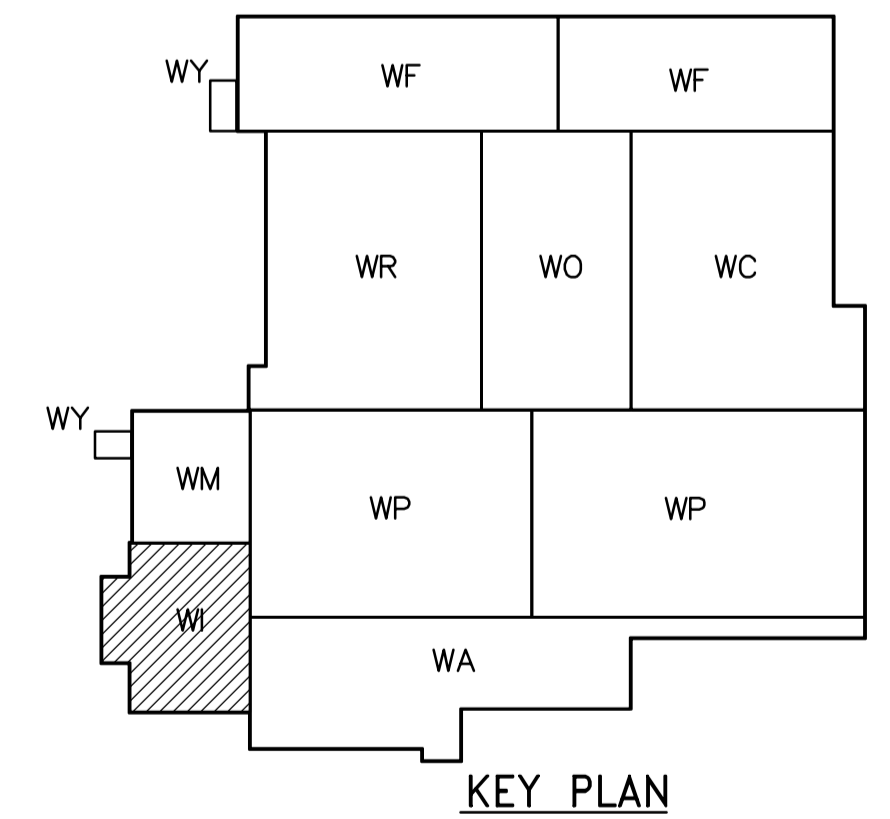

<p>APEGN Certificate of Authorization CH2M HILL Canada Ltd. No. 1441 Expiry: April 30, 2006</p>	<p>Frederickson Cooper ARCHITECTS</p>	<p>A Geo International Ltd. Company</p>	ENGINEER'S SEAL ORIGINAL SIGNED BY L.D. LLEWELLYN 2006/03/29	<p>THE CITY OF WINNIPEG WATER AND WASTE DEPARTMENT ENGINEERING DIVISION</p>	WATER TREATMENT PLANT INLET WORKS AND RAW WATER PUMPING MECHANICAL AND ELECTRICAL	CITY FILE NUMBER SHEET OF
			CONSULTANT DRAWING NO. WI-E0113		ELECTRICAL RAW WATER PUMP STATION AREA FIRST FLOOR POWER AND LIGHTING PLAN	CITY DRAWING NUMBER 1-06011-A-E0113-001-000
B.M. ELEV.		DESIGNED BY: JT CHECKED BY: ND DRAWN BY: KJ APPROVED BY: AHL SCALE: 1:100 RELEASED FOR CONSTRUCTION BY: R. SOROKOWSKI		NO. REVISIONS DATE BY DATE 2005/07/13 DATE 2006/03/29		