

- NOTES:**
1. PROVIDE STAIRWELL SMOKE DETECTORS AT EVERY THIRD FLOOR AND AT TOP.
  2. SEE MCC 4A & 4B AND PANEL SCHEDULE DP-H31 & DP-H32 FOR 600V DISTRIBUTION.
  3. SEE DRAWING WB-E0401 FOR CABLE TRAY MOUNTING DETAILS.

FOR CABLE TRAY TAGGING SEE DETAIL **3** WB-E0455

**THIRD FLOOR FACILITY PLAN**  
1:100

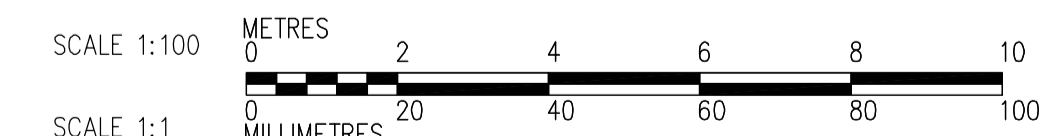
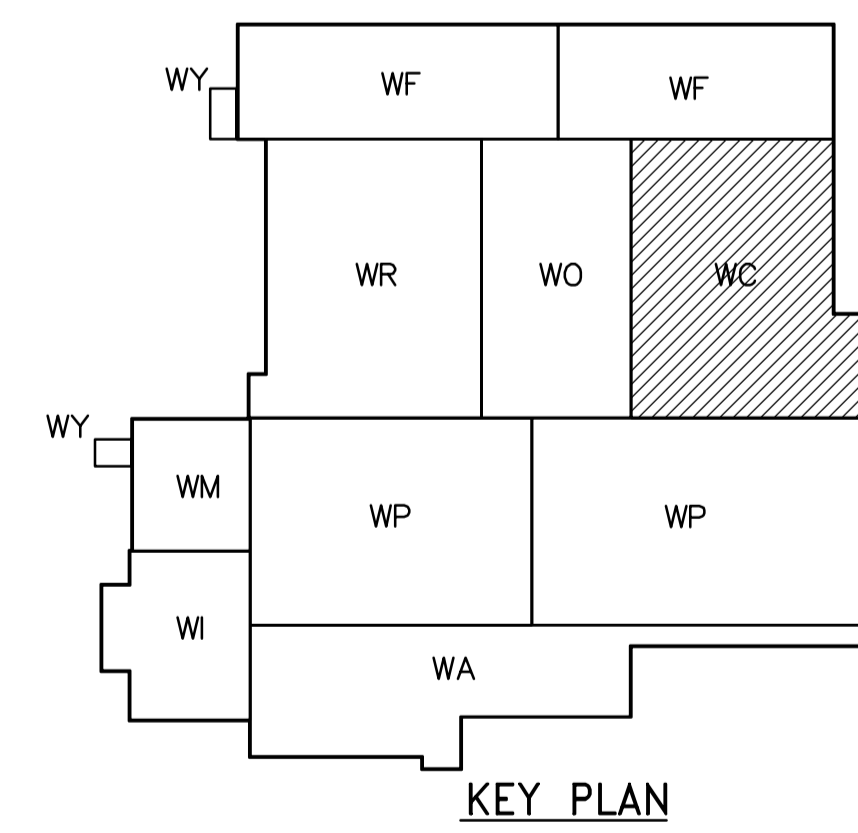

<p><b>APECA</b> Certificate of Authorization CH2M HILL Canada Ltd. No. 1441 Expiry: April 30, 2006</p>	<p>B.M. ELEV.</p> <table border="1"> <tr><td> </td><td> </td><td> </td></tr> <tr><td> </td><td> </td><td> </td></tr> <tr><td> </td><td> </td><td> </td></tr> <tr><td> </td><td> </td><td> </td></tr> </table>													<p>Frederickson Cooper ARCHITECTS</p>	<p>A You International Ltd. Company</p>	<p>ENGINEER'S SEAL</p> <p>ORIGINAL SIGNED BY <b>L.D. LLEWELLYN</b> 2006/03/29</p>	<p><b>THE CITY OF WINNIPEG</b> WATER AND WASTE DEPARTMENT ENGINEERING DIVISION</p> <p>WATER TREATMENT PLANT CHEMICAL FEED SYSTEMS MECHANICAL AND ELECTRICAL</p> <p>ELECTRICAL CHEMICAL AREA THIRD FLOOR FACILITY PLAN</p>														
<table border="1"> <tr><td>00</td><td>ISSUED FOR TENDER</td><td>06/03/29</td><td>LL</td></tr> <tr><td> </td><td> </td><td> </td><td> </td></tr> <tr><td> </td><td> </td><td> </td><td> </td></tr> <tr><td> </td><td> </td><td> </td><td> </td></tr> </table>	00	ISSUED FOR TENDER	06/03/29	LL													<table border="1"> <tr><td>DESIGNED BY</td><td>LL</td><td>CHECKED BY</td><td>ND</td></tr> <tr><td>DRAWN BY</td><td>TL</td><td>APPROVED BY</td><td>AHL</td></tr> <tr><td>SCALE:</td><td>1:100</td><td>RELEASED FOR CONSTRUCTION BY:</td><td>R. SOROKOWSKI</td></tr> </table>	DESIGNED BY	LL	CHECKED BY	ND	DRAWN BY	TL	APPROVED BY	AHL	SCALE:	1:100	RELEASED FOR CONSTRUCTION BY:	R. SOROKOWSKI	<p>CONSULTANT DRAWING NO. WC-E0131</p>	<p>CITY FILE NUMBER</p> <p>SHEET OF</p> <p>CITY DRAWING NUMBER 1-0601C-A-E0131-001-000</p>
00	ISSUED FOR TENDER	06/03/29	LL																												
DESIGNED BY	LL	CHECKED BY	ND																												
DRAWN BY	TL	APPROVED BY	AHL																												
SCALE:	1:100	RELEASED FOR CONSTRUCTION BY:	R. SOROKOWSKI																												
<p>NO. REVISIONS</p>	<p>DATE BY</p>	<p>DATE 2005/07/08</p>	<p>DATE 2006/03/29</p>	<p>DATE</p>																											