

- NOTES:**
1. ALL 120V AND 208V LOADS ARE FED FROM LP-C11.
 2. EMERGENCY LIGHTING EM-X-1, -2 ETC ARE FED FROM BATTERY PACK EM-X.

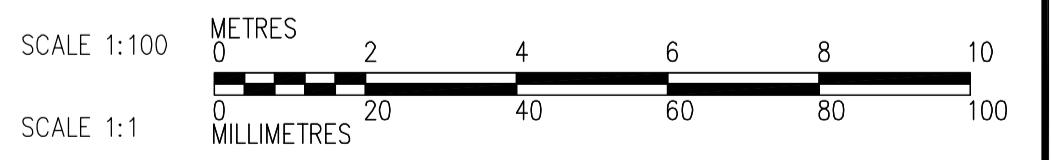
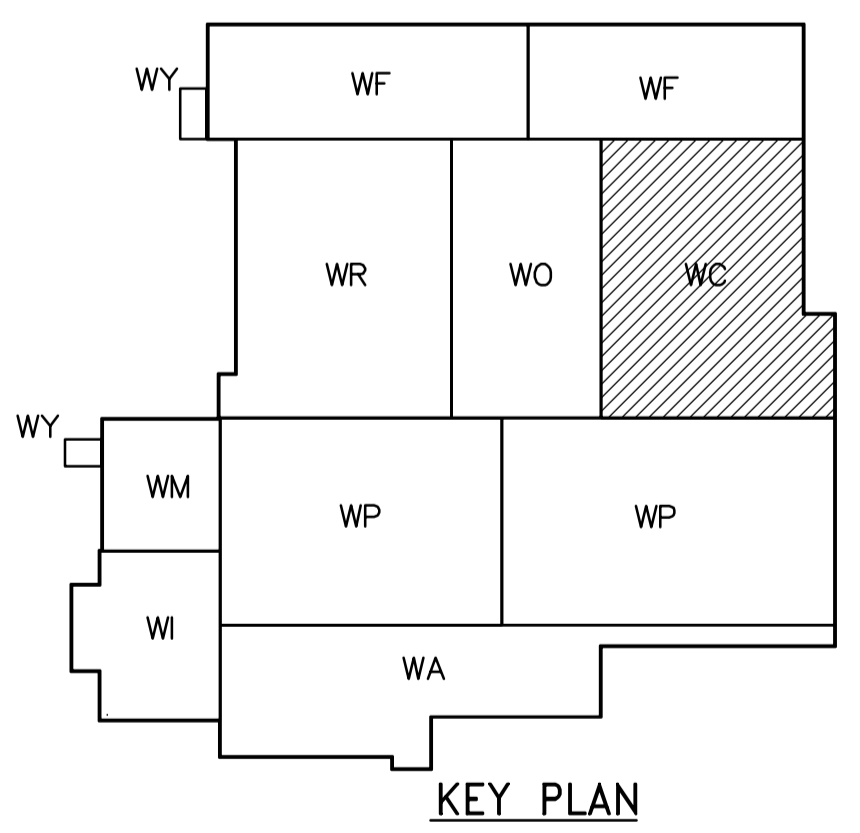

<p>APEGN Certificate of Authorization CH2M HILL Canada Ltd. No. 1441 Expiry: April 30, 2006</p>	<table border="1"> <tr> <td>B.M. ELEV.</td> <td></td> <td></td> <td></td> </tr> <tr> <td>DESIGNED BY</td> <td>LL</td> <td>CHECKED BY</td> <td>ND</td> </tr> <tr> <td>DRAWN BY</td> <td>TLL</td> <td>APPROVED BY</td> <td>AHL</td> </tr> <tr> <td>SCALE:</td> <td>1:100</td> <td>RELEASED FOR CONSTRUCTION BY:</td> <td>R. SOROKOWSKI</td> </tr> <tr> <td>ISSUED FOR TENDER</td> <td>06/03/29</td> <td>DATE</td> <td>2005/07/08</td> </tr> <tr> <td>NO. REVISIONS</td> <td></td> <td>DATE</td> <td>2006/03/29</td> </tr> </table>	B.M. ELEV.				DESIGNED BY	LL	CHECKED BY	ND	DRAWN BY	TLL	APPROVED BY	AHL	SCALE:	1:100	RELEASED FOR CONSTRUCTION BY:	R. SOROKOWSKI	ISSUED FOR TENDER	06/03/29	DATE	2005/07/08	NO. REVISIONS		DATE	2006/03/29	<p>Frederickson Cooper ARCHITECTS</p>	<p>A Terra International Ltd. Company</p>	ENGINEER'S SEAL ORIGINAL SIGNED BY L.D. LLEWELLYN 2006/03/29	<p>THE CITY OF WINNIPEG WATER AND WASTE DEPARTMENT ENGINEERING DIVISION</p>
		B.M. ELEV.																											
DESIGNED BY	LL	CHECKED BY	ND																										
DRAWN BY	TLL	APPROVED BY	AHL																										
SCALE:	1:100	RELEASED FOR CONSTRUCTION BY:	R. SOROKOWSKI																										
ISSUED FOR TENDER	06/03/29	DATE	2005/07/08																										
NO. REVISIONS		DATE	2006/03/29																										
WATER TREATMENT PLANT CHEMICAL FEED SYSTEMS MECHANICAL AND ELECTRICAL	CITY FILE NUMBER SHEET OF																												
SECOND FLOOR POWER AND LIGHTING PLAN 1:100					CONSULTANT DRAWING NO. WC-E0123	WATER TREATMENT PLANT CHEMICAL AREA SECOND FLOOR POWER AND LIGHTING PLAN	CITY DRAWING NUMBER 1-0601C-A-E0123-001-000																						