

- NOTES:**
- SEE MCC #2A & #2B SINGLE LINE DIAGRAM AND DP-C11 & DP-C12 POWER DISTRIBUTION FOR 600V POWER DISTRIBUTION.
 - SEE LP-C11 FOR 120/208V POWER DISTRIBUTION.

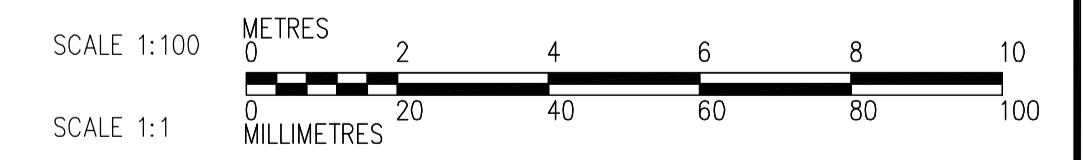
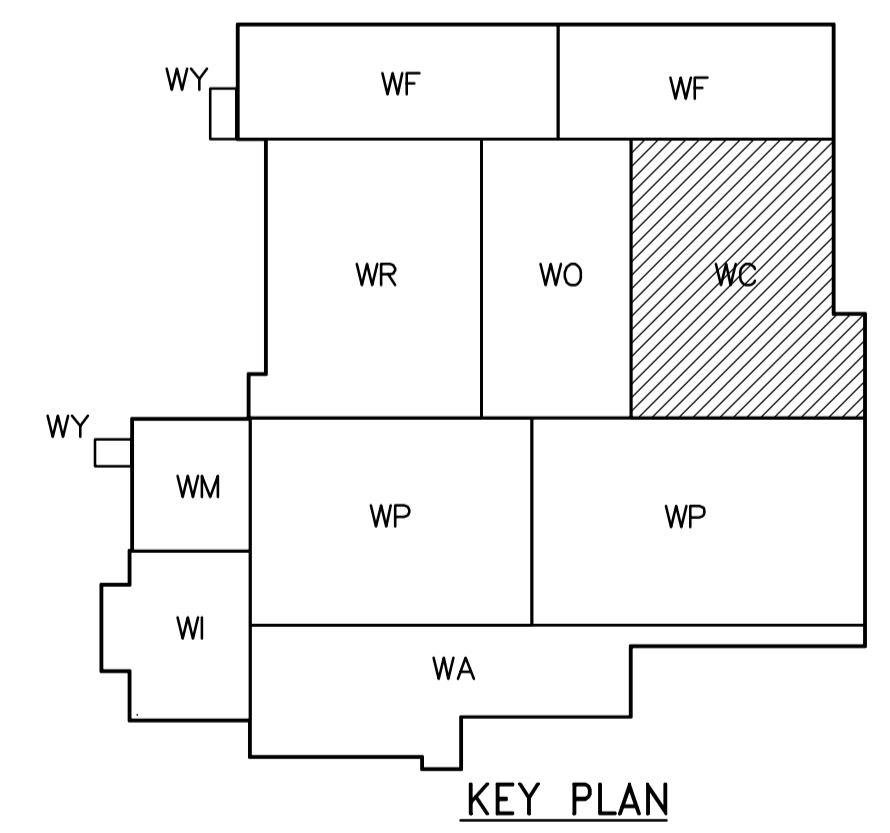

SECOND FLOOR FACILITY PLAN
1:100

<p>APEGN Certificate of Authorization CH2M HILL Canada Ltd. No. 1441 Expiry: April 30, 2006</p>	<p>Frederickson Cooper ARCHITECTS</p>	<p>EarthTech A Tyco International Ltd. Company</p>	ENGINEER'S SEAL	<p>THE CITY OF WINNIPEG WATER AND WASTE DEPARTMENT ENGINEERING DIVISION</p>		
			DESIGNED BY LL		CHECKED BY ND	ORIGINAL SIGNED BY L.D. LLEWELLYN
			DRAWN BY TLL		APPROVED BY AHL	2006/03/29
<p>SCALE: 1:100</p>			<p>RELEASED FOR CONSTRUCTION BY: R. SOROKOWSKI</p>	<p>CITY FILE NUMBER</p>		
<p>00 ISSUED FOR TENDER 06/03/29 LL</p>			<p>CONSULTANT DRAWING NO. WC-E0121</p>	<p>SHEET OF</p>		
<p>NO. REVISIONS DATE BY DATE 2005/07/08 DATE 2006/03/29</p>			<p>ELECTRICAL CHEMICAL AREA SECOND FLOOR FACILITY PLAN</p>	<p>CITY DRAWING NUMBER 1-0601C-A-E0121-001-000</p>		