

- NOTES:**
1. ALL 120V AND 208V LOADS ARE FED FROM LP-A11.
 2. EMERGENCY LIGHTING EM-X-1, -2 ETC ARE FED FROM BATTERY PACK EM-X.
 3. MOUNT TYPE A AND U LUMINAIRES AT 3m ABOVE PLATFORM.

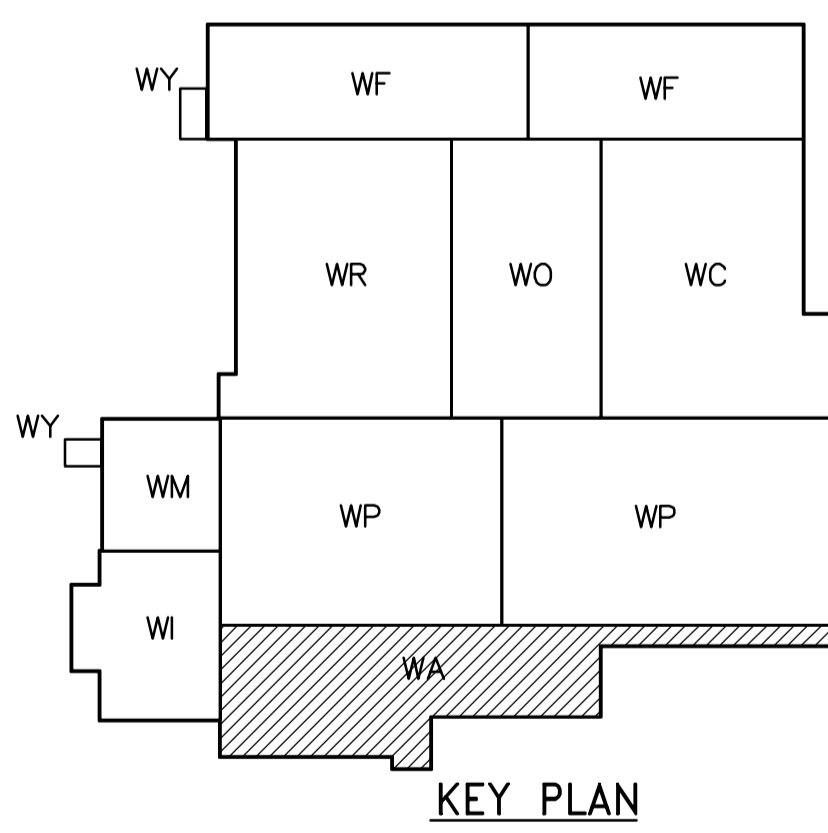

FIRST FLOOR POWER AND LIGHTING PLAN
1:100

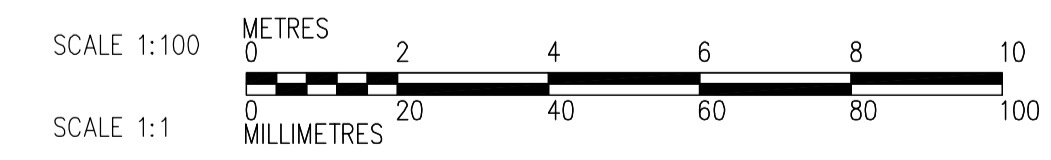

<p>APEGN Certificate of Authorization CH2M HILL Canada Ltd. No. 1441 Expiry: April 30, 2007</p>	<p>Frederickson Cooper ARCHITECTS</p>		<p>EarthTech A Tyco International Ltd. Company</p>		ENGINEER'S SEAL ORIGINAL SIGNED BY L.D. LLEWELLYN 2006/03/29	<p>THE CITY OF WINNIPEG WATER AND WASTE DEPARTMENT ENGINEERING DIVISION</p>
	DESIGNED BY JT CHECKED BY ND		APPROVED BY AHL		CONSULTANT DRAWING NO. WA-E0113	
	DRAWN BY KJ		RELEASED FOR CONSTRUCTION BY: R. SOROKOWSKI			
	SCALE: 1:100		DATE 2005/08/18		CITY FILE NUMBER SHEET OF CITY DRAWING NUMBER 1-0601A-A-E0113-001-02D	
NO. REVISIONS DATE BY		DATE 2005/08/18		DATE 2006/03/29		