

B SIZE 11" x 17" (279mm x 432mm)

PLOT: 06/01/16 9:19:58 AM

UMA FILE NAME: D265-195-02_01-C-1020_RX.dwg Saved By: kberard

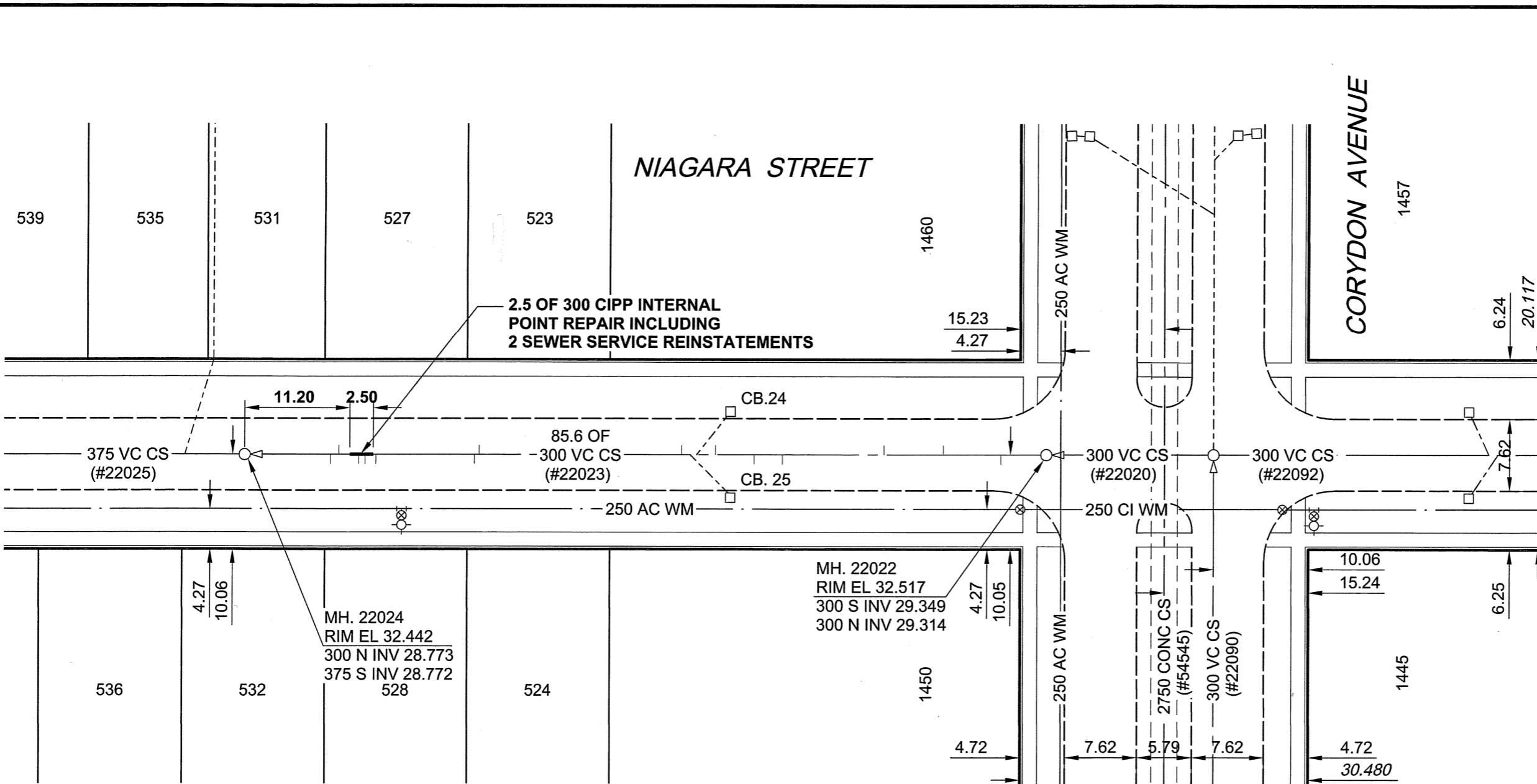

SEWER JUNCTION INFORMATION*

REF. MH	DIST FROM REF. MH	SIZE	CLOCK REF
22022	4.80	150Ø	10
22022	10.90	150Ø	03
22022	17.20	150Ø	03
22022	28.00	150Ø	10
22022	31.00	150Ø	09
22022	35.10	200Ø	03
22022	37.10	150Ø	02
22022	37.80	150Ø	10
22022	38.70	150Ø	03
22022	60.30	150Ø	03
22022	60.80	150Ø	10
22022	71.60	150Ø	09
22022	72.50	200Ø	12
22022	73.20	200Ø	12
22022	75.30	150Ø	02
22022	76.20	150Ø	09

*JUNCTION LOCATION FROM VIDEO INSPECTION

METRIC
WHOLE NUMBERS INDICATE MILLIMETRES
DECIMALIZED NUMBERS INDICATE METRES

APECM
Certificate of Authorization
UMA Engineering Ltd.
No. 256 Expiry: April 30, 2006

BID OPPORTUNITY NO. 695-2005

LOCATION APPROVED UNDERGROUND STRUCTURES			
SUPR. U/G STRUCTURES COMMITTEE		DATE	
NOTE: LOCATION OF UNDERGROUND STRUCTURES AS SHOWN ARE BASED ON THE BEST INFORMATION AVAILABLE. BUT NO GUARANTEE IS GIVEN THAT ALL EXISTING UTILITIES ARE SHOWN OR THAT THE GIVEN LOCATIONS ARE EXACT. CONFIRMATION OF EXISTENCE AND EXACT LOCATION OF ALL SERVICES MUST BE OBTAINED FROM THE INDIVIDUAL UTILITIES BEFORE PROCEEDING WITH CONSTRUCTION.			
BM 51-028 ELEV 232.964m	S.E. Cor. Corydon Ave. & Ash St. Brass plug in 4.6 m Conc pile, 2.6 m W. of E.L. Ash St & 0.7 m S. of S.L. Corydon Ave.		
NO.	ISSUED FOR CONSTRUCTION	YY/MM/DD	BY
0	ISSUED FOR CONSTRUCTION	06/01/12	KMB
NO.	REVISIONS	YY/MM/DD	BY

UMA AECOM			
© 2005 UMA ENGINEERING LTD. ALL RIGHTS RESERVED.			
DESIGNED BY	ALD / MJR	CHECKED BY	ALD
DRAWN BY	KMB	APPROVED BY	<i>Benjamin Leber</i>
HOR. SCALE	1:500	RELEASED FOR CONSTRUCTION	<i>[Signature]</i>
VERT. SCALE		DATE	06/01/16

PROFESSIONAL'S SEAL

CONSULTANT DRAWING NO. 19
D265-195-02

THE CITY OF WINNIPEG
WATER AND WASTE DEPARTMENT

**2005 COMBINED SEWER RENEWALS
BY CIPP INTERNAL POINT REPAIRS
CONTRACT 20**

NIAGARA STREET
MH AT S PL OF CORYDON AVENUE
TO 1ST MH S OF CORYDON AVENUE

SHEET 19 OF 26	REV 0
CITY DRAWING NUMBER	05728