

B SIZE 11" x 17" (279mm x 432mm)

PLOT: 06/01/12 11:01:29 AM

UMA FILE NAME: D265-195-02\_01-C-1015\_RX.dwg Saved By: kberard

# LINDSAY STREET

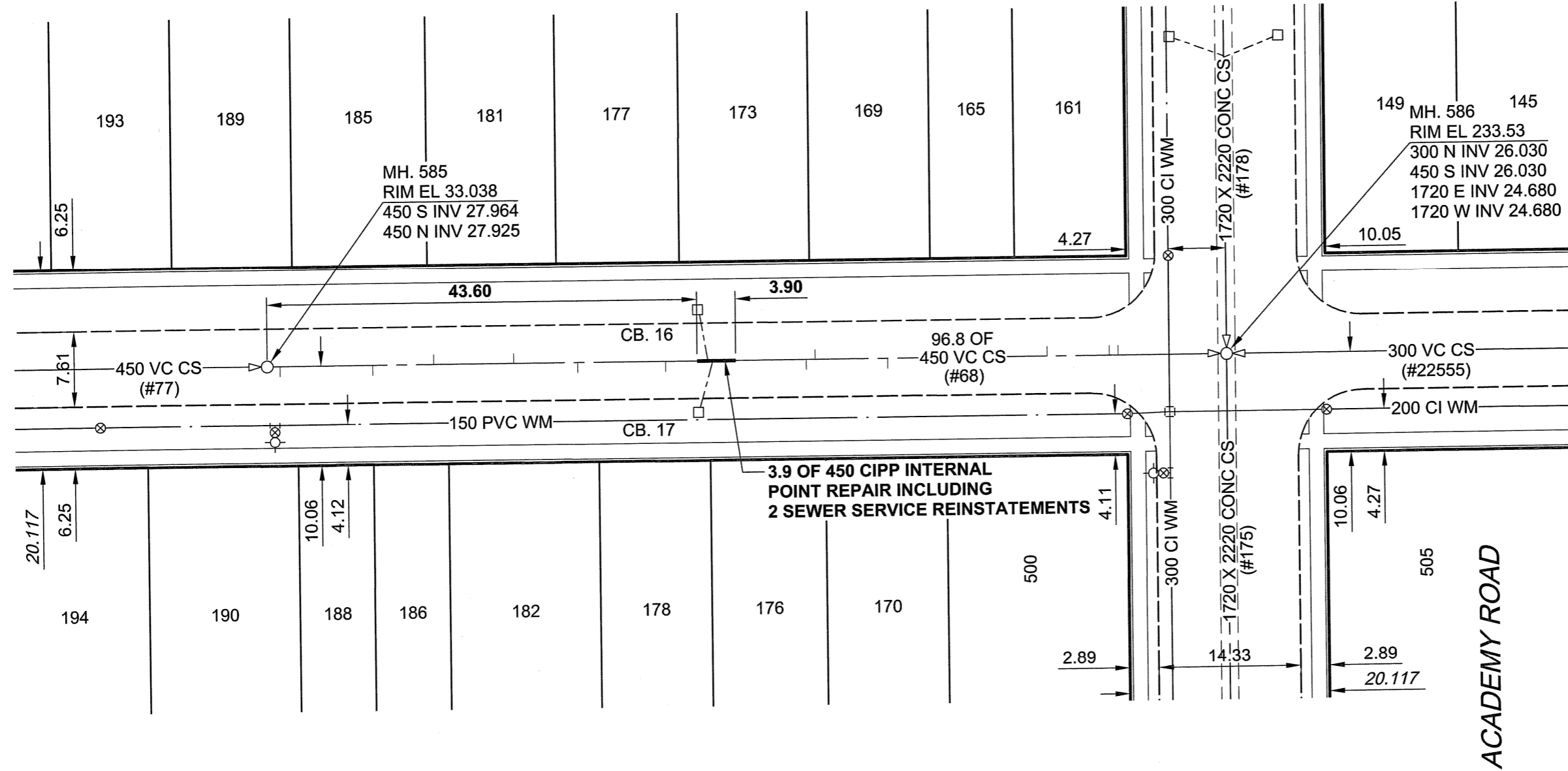

### SEWER JUNCTION INFORMATION\*

REF. MH	DIST FROM	SIZE	CLOCK
585	1.30	150Ø	01
585	10.70	150Ø	01
585	16.90	150Ø	10
585	25.00	150Ø	11
585	31.50	150Ø	02
585	40.40	150Ø	01
585	44.70	150Ø	11
585	45.20	150Ø	01
585	54.60	150Ø	01
585	55.50	150Ø	10
585	62.80	150Ø	01
585	78.90	150Ø	11
585	85.20	150Ø	12
585	86.10	150Ø	11

\*JUNCTION LOCATION FROM VIDEO INSPECTION

**METRIC**  
WHOLE NUMBERS INDICATE MILLIMETRES  
DECIMALIZED NUMBERS INDICATE METRES

**APECM**  
Certificate of Authorization  
UMA Engineering Ltd.  
No. 256 Expiry: April 30, 2006

BID OPPORTUNITY NO. 695-2005

### LOCATION APPROVED UNDERGROUND STRUCTURES

SUPR. U/G STRUCTURES DATE COMMITTEE

**NOTE:**  
LOCATION OF UNDERGROUND STRUCTURES AS SHOWN ARE BASED ON THE BEST INFORMATION AVAILABLE. BUT NO GUARANTEE IS GIVEN THAT ALL EXISTING UTILITIES ARE SHOWN OR THAT THE GIVEN LOCATIONS ARE EXACT. CONFIRMATION OF EXISTENCE AND EXACT LOCATION OF ALL SERVICES MUST BE OBTAINED FROM THE INDIVIDUAL UTILITIES BEFORE PROCEEDING WITH CONSTRUCTION.

BM 51-042 ELEV 232.799m	S.E. Cor. Academy Rd. & Borebank St. Tbtl. in 7.6 m Conc. pile beneath Valve Box, 8.5 m W. of E.L. Borebank St. & 5.6 m N. of S.L. Academy Rd.		
0	ISSUED FOR CONSTRUCTION	06/01/12	KMB
NO.	REVISIONS	YY/MM/DD	BY

DESIGNED BY <b>ALD / MJR</b>		CHECKED BY <b>ALD</b>	
DRAWN BY <b>KMB</b>		APPROVED BY <i>[Signature]</i>	
HOR. SCALE <b>1:500</b>		RELEASED FOR CONSTRUCTION	
VERT. SCALE		DATE <b>06/01/16</b>	

PROFESSIONAL'S SEAL

CONSULTANT DRAWING NO. 14  
D265-195-02

**THE CITY OF WINNIPEG**  
Winnipeg WATER AND WASTE DEPARTMENT

**2005 COMBINED SEWER RENEWALS  
BY CIPP INTERNAL POINT REPAIRS  
CONTRACT 20**

**LINDSAY STREET**  
1ST MH S OF ACADEMY ROAD  
TO MH AT ACADEMY ROAD

SHEET 14 OF 26  
CITY DRAWING NUMBER  
**05723**  
REV 0