

B SIZE 11" x 17" (279mm x 432mm)

PLOT: 06/01/12 10:39:39 AM

UMA FILE NAME: D265-195-02\_01-C-1009\_RX.dwg Saved By: kberard

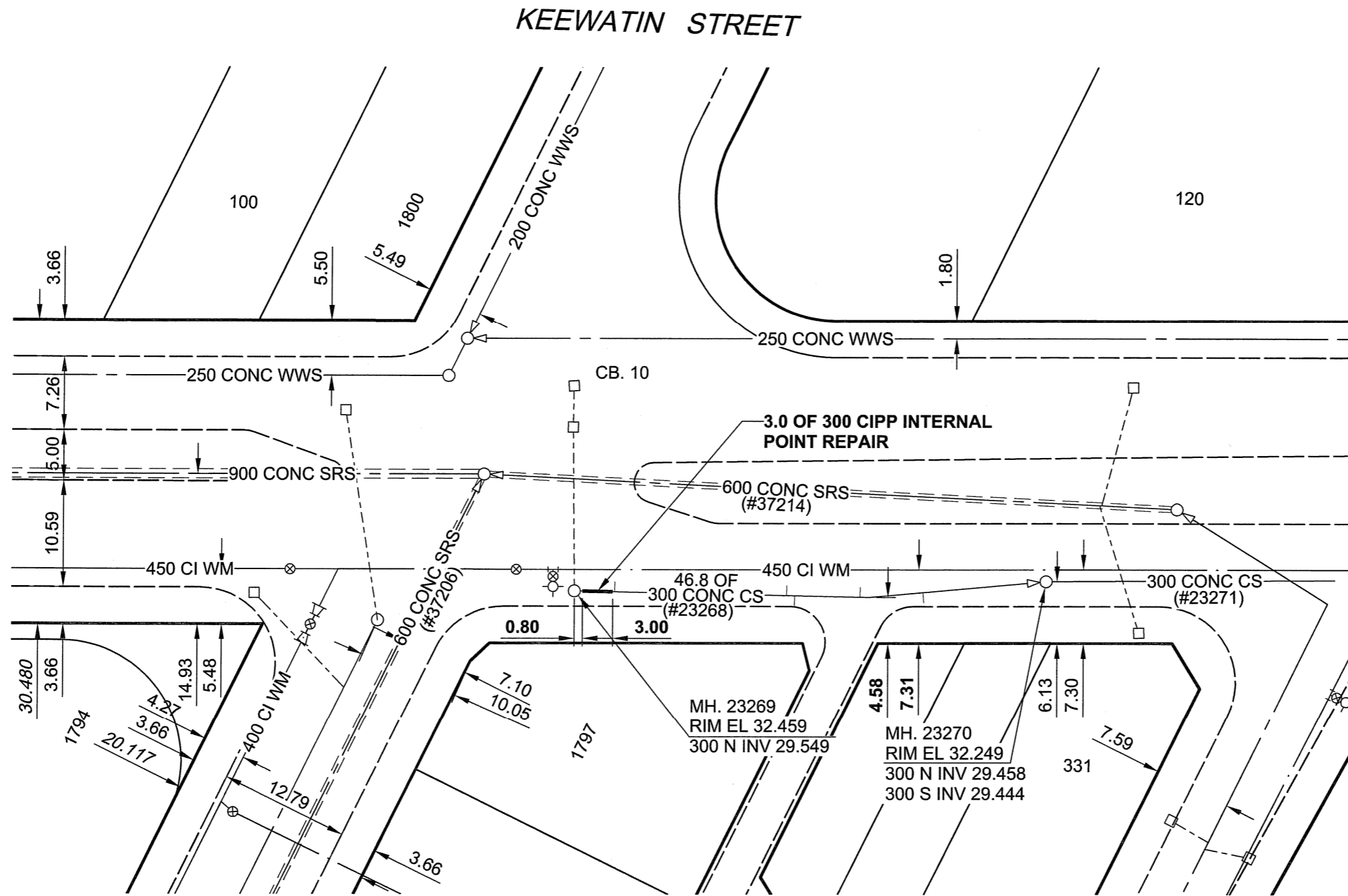

**SEWER JUNCTION INFORMATION\***

REF. MH	DIST FROM REF. MH	SIZE	CLOCK REF
23269	4.00	150Ø	12
23269	21.00	100Ø	11
23269	21.80	150Ø	02
23269	28.30	200Ø	11
23269	34.50	150Ø	02

\*JUNCTION LOCATION FROM VIDEO INSPECTION

**METRIC**  
WHOLE NUMBERS INDICATE MILLIMETRES  
DECIMALIZED NUMBERS INDICATE METRES

**APECM**  
Certificate of Authorization  
UMA Engineering Ltd.  
No. 256 Expiry: April 30, 2005

BID OPPORTUNITY NO. 695-2005

**LOCATION APPROVED**  
UNDERGROUND STRUCTURES

SUPR. U/G STRUCTURES	DATE
COMMITTEE	

**NOTE:**  
LOCATION OF UNDERGROUND STRUCTURES AS SHOWN ARE BASED ON THE BEST INFORMATION AVAILABLE. BUT NO GUARANTEE IS GIVEN THAT ALL EXISTING UTILITIES ARE SHOWN OR THAT THE GIVEN LOCATIONS ARE EXACT. CONFIRMATION OF EXISTENCE AND EXACT LOCATION OF ALL SERVICES MUST BE OBTAINED FROM THE INDIVIDUAL UTILITIES BEFORE PROCEEDING WITH CONSTRUCTION.

BM 23-008 ELEV 232.957	S.W. Cor. Logan Ave. & Keewatin St., Tbtl. in N. Conc. foundation No. 1800 Logan Ave. (Westbrook Medical Centre), 3 m W. & 0.3 m below brick of N.E. Cor. of Bldg.		
0	ISSUED FOR CONSTRUCTION	06/01/12	KMB
NO.	REVISIONS	YY/MM/DD	BY

UMA | AECOM

©2005 UMA ENGINEERING LTD. ALL RIGHTS RESERVED.

DESIGNED BY	ALD / MJR	CHECKED BY	ALD
DRAWN BY	KMB	APPROVED BY	<i>[Signature]</i>
HOR. SCALE	1:500	RELEASED FOR CONSTRUCTION	<i>[Signature]</i>
VERT. SCALE		DATE	06/01/06

PROFESSIONAL'S SEAL

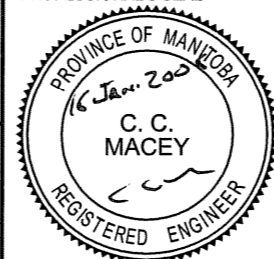

CONSULTANT DRAWING NO. 08  
D265-195-02



**THE CITY OF WINNIPEG**  
**WATER AND WASTE DEPARTMENT**

**2005 COMBINED SEWER RENEWALS**  
**BY CIPP INTERNAL POINT REPAIRS**  
**CONTRACT 20**

**KEEWATIN STREET**  
1ST MH N OF LOGAN AVENUE  
TO 2ND MH N OF LOGAN AVENUE

SHEET 08 OF 26

CITY DRAWING NUMBER

05717 REV 0