

B SIZE 11" x 17" (279mm x 432mm)

PLOT: 06/01/12 1:24:32 PM

UMA FILE NAME: D265-195-02_01-C-1007_RX.dwg Saved By: kberard

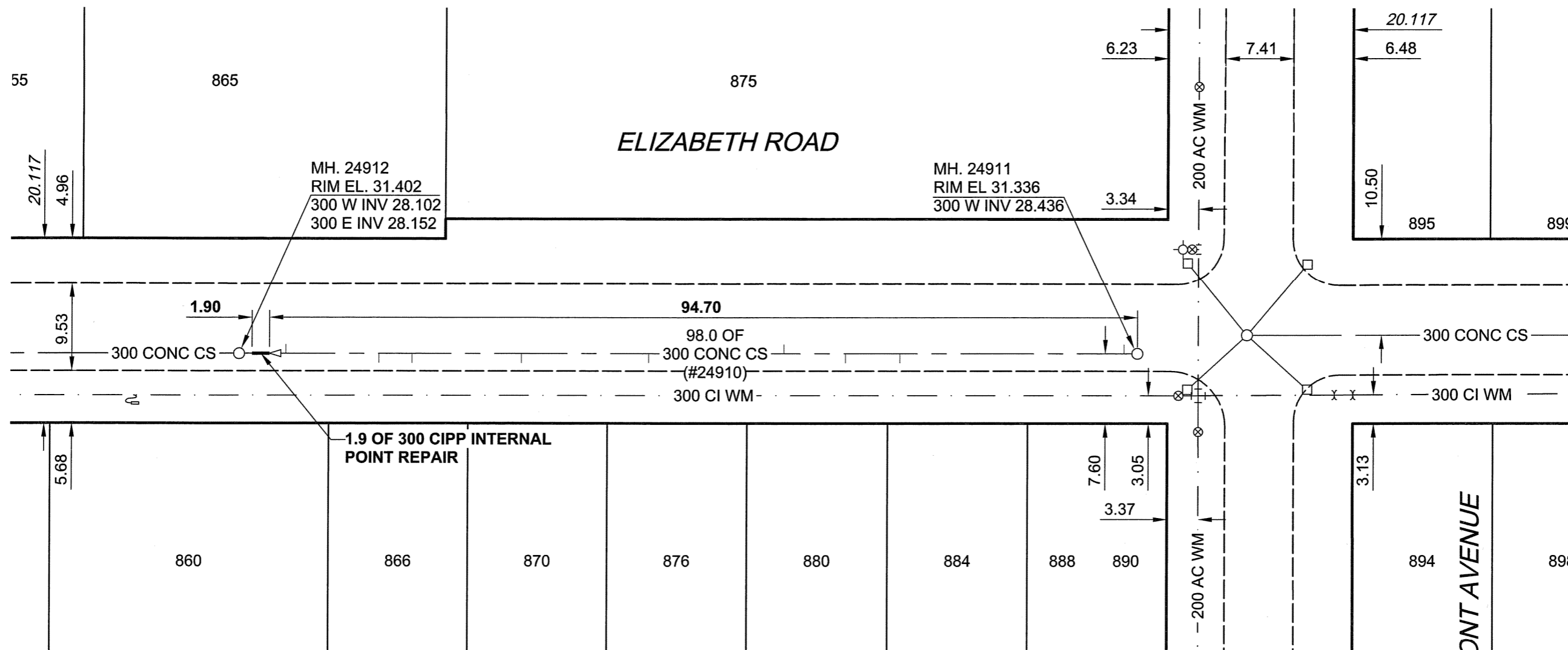

SEWER JUNCTION INFORMATION*

REF. MH	DIST FROM REF. MH	SIZE	CLOCK REF
24911	1.80	150Ø	01
24911	25.80	150Ø	10
24911	31.70	150Ø	10
24911	38.40	150Ø	02
24911	53.10	150Ø	10
24911	67.00	150Ø	10
24911	79.00	150Ø	10
24911	82.60	150Ø	09
24911	92.80	150Ø	02

*JUNCTION LOCATION FROM VIDEO INSPECTION

BID OPPORTUNITY NO. 695-2005

METRIC

WHOLE NUMBERS INDICATE MILLIMETRES
DECIMALIZED NUMBERS INDICATE METRES

UMA | AECOM

©2005 UMA ENGINEERING LTD. ALL RIGHTS RESERVED.

DESIGNED BY	ALD / MJR	CHECKED BY	ALD
DRAWN BY	KMB	APPROVED BY	<i>[Signature]</i>
HOR. SCALE	1:500	RELEASED FOR CONSTRUCTION	<i>[Signature]</i>
VERT. SCALE		DATE	06/01/12

PROFESSIONAL'S SEAL

CONSULTANT DRAWING NO. 06
D265-195-02

**2005 COMBINED SEWER RENEWALS
BY CIPP INTERNAL POINT REPAIRS
CONTRACT 20**

ELIZABETH ROAD
MH AT DE BOURMONT AVENUE
TO 1ST MH W OF DE BOURMONT AVENUE

SHEET	06	OF	26
CITY DRAWING NUMBER	05715		
REV	0		

LOCATION APPROVED
UNDERGROUND STRUCTURES

SUPR. U/G STRUCTURES	DATE

NOTE:
LOCATION OF UNDERGROUND STRUCTURES AS SHOWN ARE BASED ON THE BEST INFORMATION AVAILABLE. BUT NO GUARANTEE IS GIVEN THAT ALL EXISTING UTILITIES ARE SHOWN OR THAT THE GIVEN LOCATIONS ARE EXACT. CONFIRMATION OF EXISTENCE AND EXACT LOCATION OF ALL SERVICES MUST BE OBTAINED FROM THE INDIVIDUAL UTILITIES BEFORE PROCEEDING WITH CONSTRUCTION.

BM 50-035 ELEV 233.121m	N.E. Cor. Grenfell Blvd. & Nanton Blvd., Tbolt. on top of 0.05 m dia. x 2.4 m iron pipe, 5 m S. of N.L. of Nanton Blvd. & 3 m W. of E.L. of Grenfell Blvd.		
NO.	ISSUED FOR CONSTRUCTION	06/01/12	KMB
NO.	REVISIONS	YY/MM/DD	BY