

COMBINED SEWER

HOME STREET

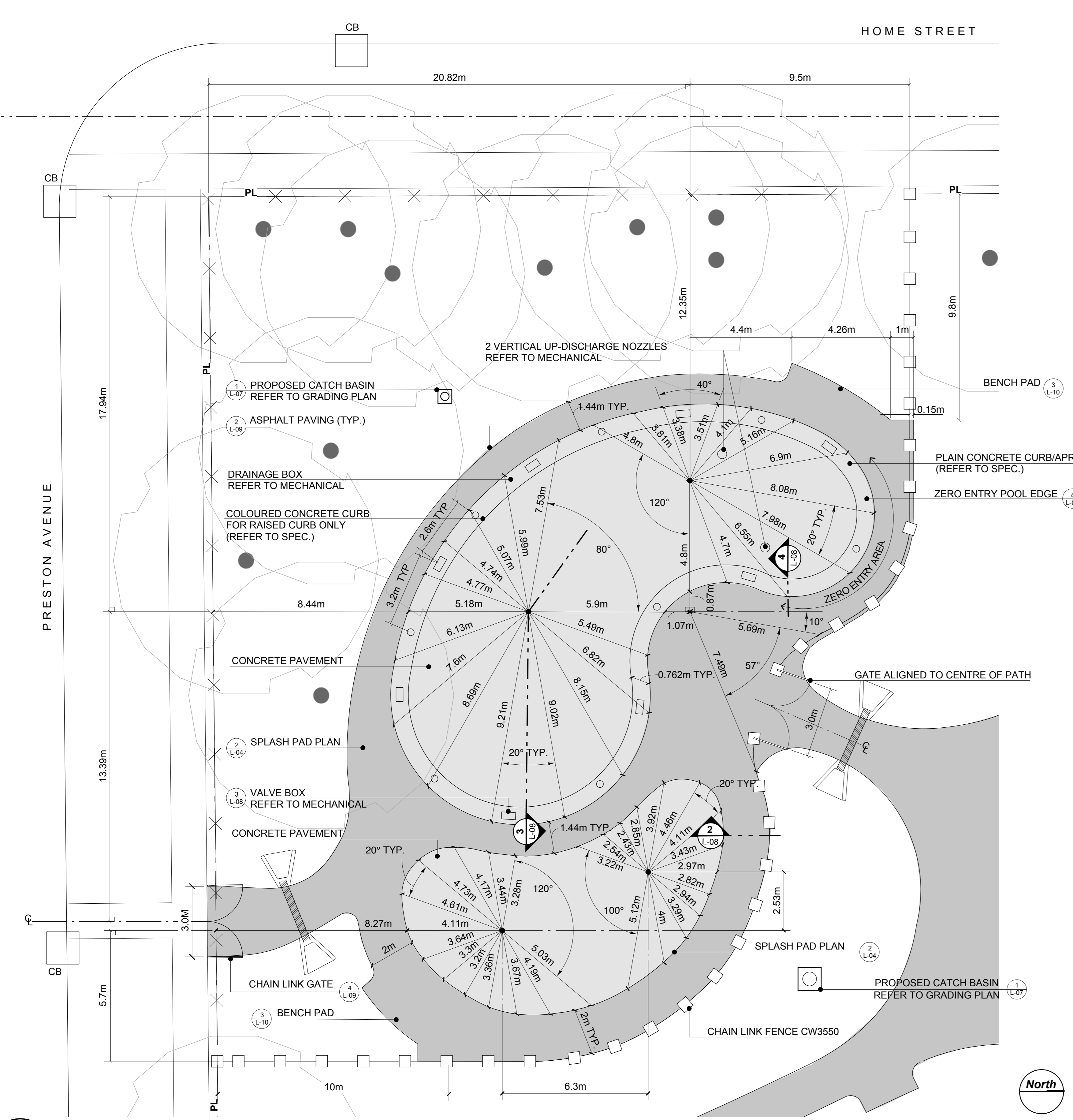

**1**  
**L-04** WATER PLAY AREA PLAN  
SCALE: 1:100

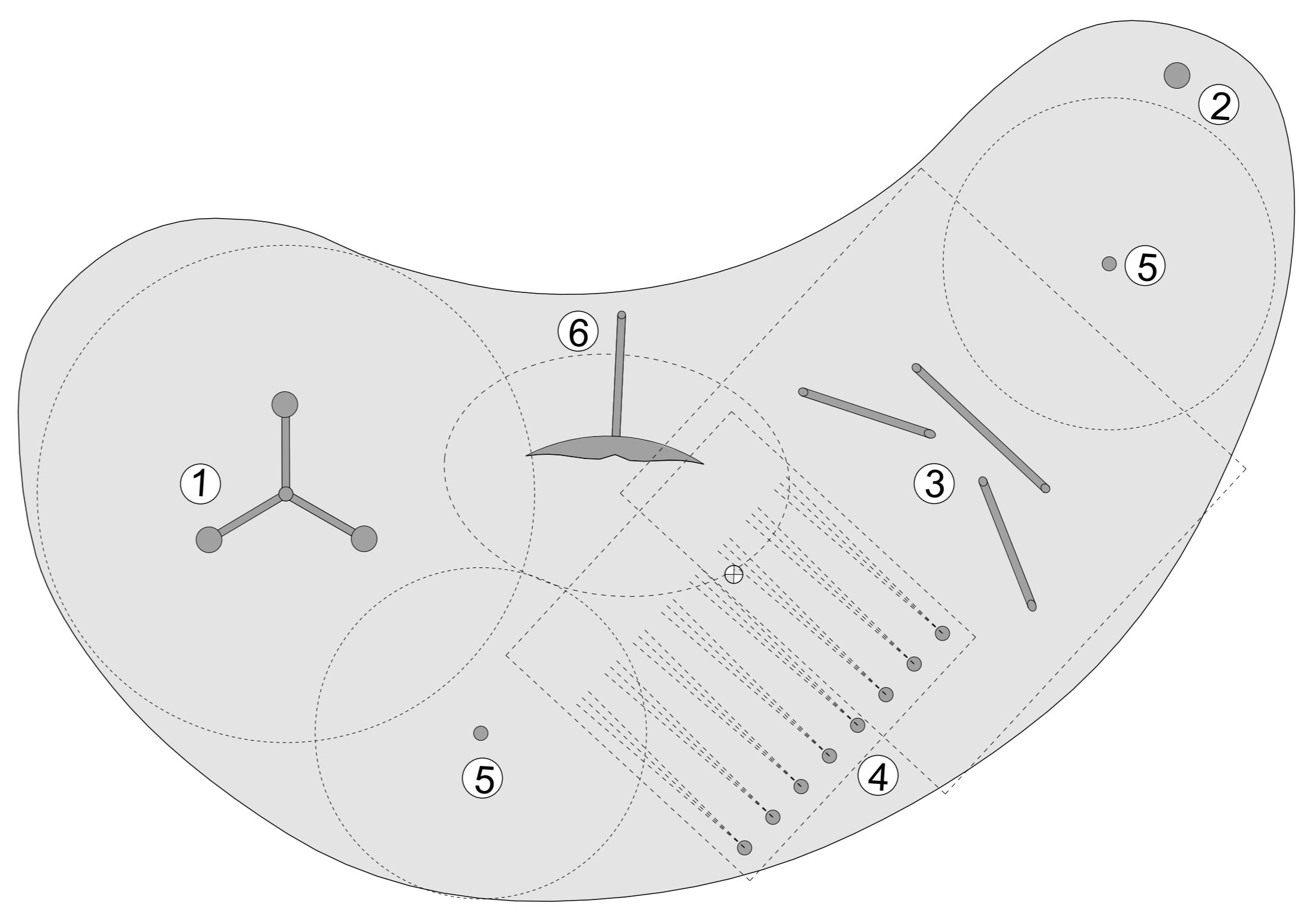

**WATER PLAY COMPONENT LIST**

NO.	NAME	MODEL NO.
①	BUCKET TRIO	VOR-0103
②	MAGIC TOUCH BOLLARD	VOR-0600
③	BULLFROG	VOR-0524
④	WATER TUNNEL	VOR-0304
⑤	GROUND GEYSER	VOR-0301
⑥	WHALE TAIL	VOR-0523

MANUFACTURER: VORTEX  
 SUPPLIER: PLAYGROUNDS-R-US  
 CONTACT: JODI MARR  
 250 TRANSPORT ROAD  
 WINNIPEG, MB  
 204-632-7000 (PH)  
 800-688-4303 (TOLL FREE)  
 204-632-7421 (FAX)

**2**  
**L-04** SPLASH PAD COMPONENT PLAN  
SCALE: 1:50

- LEGEND**
- ASPHALTIC CONCRETE PAVING
  - CONCRETE PAVING & APRON
  - x-x- EXISTING CHAIN LINK FENCING
  - o-o- PROPOSED CHAIN LINK FENCING
  - PROPOSED VALVE BOX
  - PROPOSED DRAINAGE BOX
  - EXISTING DECIDUOUS TREES

- GENERAL NOTES:**
1. Water play components to be installed by supplier.
  2. Contractor is responsible for co-ordinating installation and supplier.
  3. Contractor is responsible for ensuring that components are installed as per CSA and manufacturer's instructions.

SURVEY SOURCE: SHEPHERD & STEVENS 04168315

No.	Revision	Date
7	ISSUED FOR TENDER	FEB 2005
6	PRE-TENDER REVIEW	JAN 13 05
5	PRE-TENDER REVIEW	DEC 21 05
4	ISSUED FOR TENDER	SEP 15 05
3	MATERIALS & METHOD SUBMISSION	AUG 20 05
2	95% CD SUBMISSION	JULY 14 05
1	90% CD SUBMISSION	OCT 21 04



THIS DRAWING MUST NOT BE SCALED.  
 THE CONTRACTOR SHALL VERIFY ALL DIMENSIONS, DATUMS AND LEVELS PRIOR TO COMMENCEMENT OF WORK. ALL ERRORS AND OMISSIONS TO BE REPORTED IMMEDIATELY TO THE CONTRACT ADMINISTRATOR.  
 VARIATIONS & MODIFICATIONS TO WORK SHOWN ON THESE DRAWINGS SHALL NOT BE CARRIED OUT WITHOUT WRITTEN PERMISSION FROM THE CONTRACT ADMINISTRATOR.  
 THIS DRAWING IS THE EXCLUSIVE PROPERTY OF THE CONTRACT ADMINISTRATOR AND CAN BE REPRODUCED ONLY WITH THE PERMISSION OF THE CONTRACT ADMINISTRATOR. IN ANY CASE THE REPRODUCTION MUST BEAR THEIR NAME AS CONTRACT ADMINISTRATOR.

**VIMY RIDGE MEMORIAL PARK  
 PLAYGROUND AREA**

**LAYOUT PLAN  
 WATERPLAY AREA**



Drawn	TG/MB	Approved	HC
Scale	1:100	Date	3/3/06
Job	04 032	Drawing	L-04