

D SIZE 22" x 34" (56mm x 86mm)

PLOT: 05/02/08 4:29:50 PM

UMA FILE NAME: D265-177-01_01-C-1007_RX.dwg Saved By: atleppi

234.0
233.0
232.0
231.0
230.0
229.0
228.0
227.0
226.0
225.0
224.0
223.0

234.0
233.0
232.0
231.0
230.0
229.0
228.0
227.0
226.0
225.0
224.0
223.0

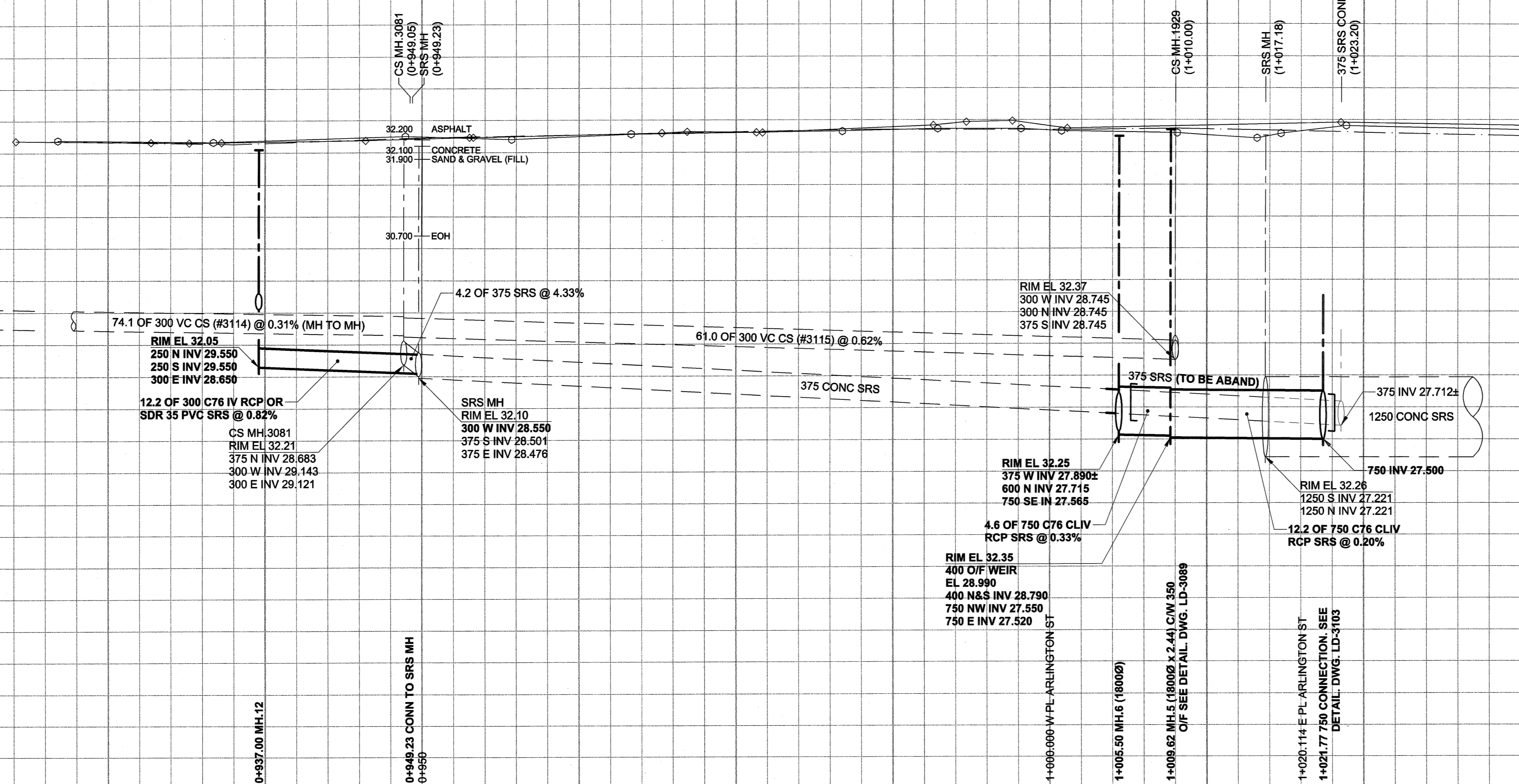

CHAINAGE ALONG S PL

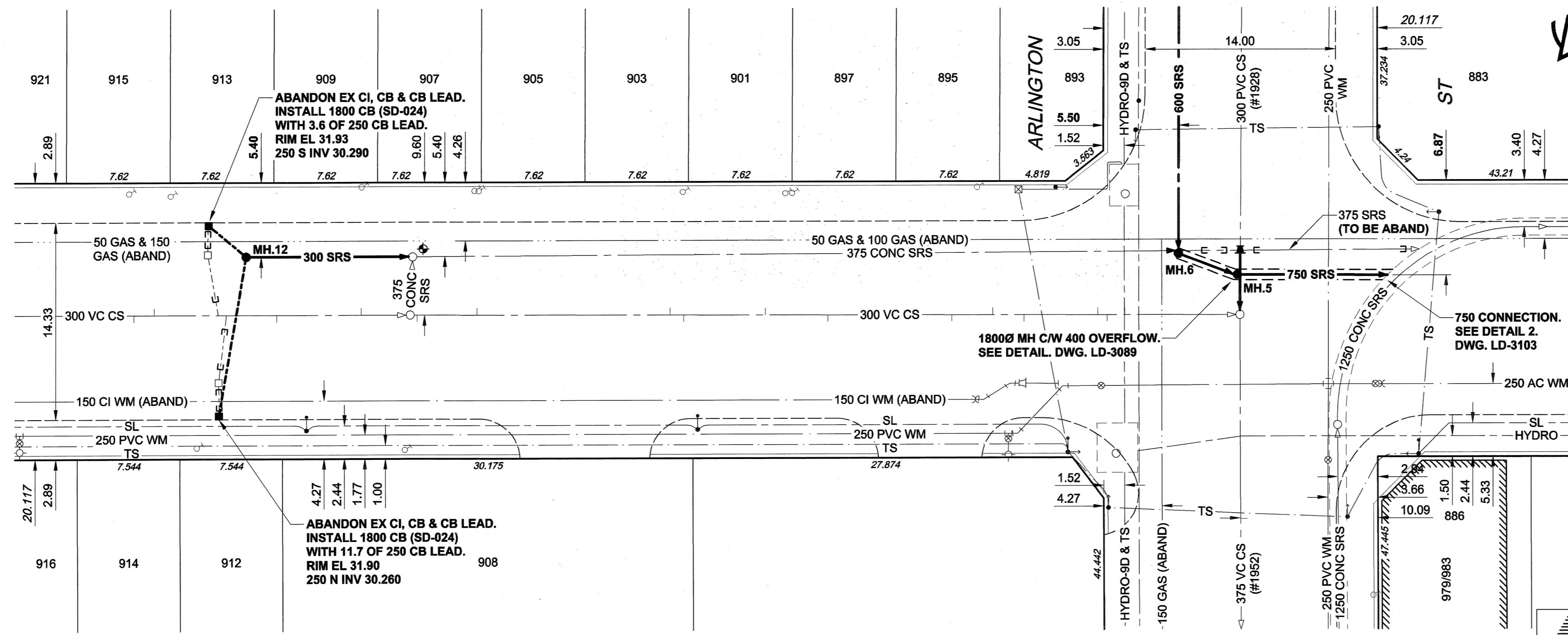

WARNING
IF POWER EQUIPMENT OR EXPLOSIVES ARE TO BE USED FOR EXCAVATION ON THIS PROJECT, THE CONTRACTOR MUST:
1) NOTIFY THE GAS COMPANY OF THE PROPOSED LOCATION OF EXCAVATION.
2) TAKE PRECAUTION TO AVOID DAMAGE TO GAS COMPANY INSTALLATIONS.
SEE PROVINCIAL REGULATION 140/92 FOR DETAILS

EXISTING	LEGEND - PLAN	NEW	EXISTING	LEGEND - PLAN	NEW	EXISTING	LEGEND - PROFILE	NEW
○	150 mm WM	●	○	150 mm WM	●	○	150 mm WM	●
○	HYDRANT	●	○	HYDRANT	●	○	HYDRANT	●
○	VALVE	●	○	VALVE	●	○	VALVE	●
○	LAND DRAINAGE SEWER	●	○	LAND DRAINAGE SEWER	●	○	LAND DRAINAGE SEWER	●
○	WASTE WATER SEWER	●	○	WASTE WATER SEWER	●	○	WASTE WATER SEWER	●
○	MANHOLE	●	○	MANHOLE	●	○	MANHOLE	●
○	CATCH BASIN	●	○	CATCH BASIN	●	○	CATCH BASIN	●
○	CURB INLET	●	○	CURB INLET	●	○	CURB INLET	●
○	CULVERT	●	○	CULVERT	●	○	CULVERT	●
○	PIPE ABANDONMENTS	●	○	PIPE ABANDONMENTS	●	○	PIPE ABANDONMENTS	●
○	SURVEY BAR	●	○	SURVEY BAR	●	○	SURVEY BAR	●
○	CURB STOP	●	○	CURB STOP	●	○	CURB STOP	●
○	REDUCER	●	○	REDUCER	●	○	REDUCER	●
○	COUPLING	●	○	COUPLING	●	○	COUPLING	●
○	ANODE	●	○	ANODE	●	○	ANODE	●
○	HYDRO	●	○	HYDRO	●	○	HYDRO	●
○	TESTHOLE	●	○	TESTHOLE	●	○	TESTHOLE	●
○	LAMP STANDARD	●	○	LAMP STANDARD	●	○	LAMP STANDARD	●
○	TREE	●	○	TREE	●	○	TREE	●

LOCATION APPROVED
UNDERGROUND STRUCTURES
SUPR. U/G STRUCTURES COMMITTEE DATE
NOTE:
LOCATION OF UNDERGROUND STRUCTURES AS SHOWN ARE BASED ON THE BEST INFORMATION AVAILABLE. BUT NO GUARANTEE IS GIVEN THAT ALL EXISTING UTILITIES ARE SHOWN OR THAT THE GIVEN LOCATIONS ARE EXACT. CONFIRMATION OF EXISTENCE AND EXACT LOCATION OF ALL SERVICES MUST BE OBTAINED FROM THE INDIVIDUAL UTILITIES BEFORE PROCEEDING WITH CONSTRUCTION.

BM 36-046 ELEV 232.498m	N.W. Cor. Notre Dame Ave. & Arlington St., Tilt. in E. Conc. foundation No. 309 Notre Dame Ave., 0.5m S. & 0.05m below Tyndall stone N.E. Cor. of Bldg.
0	ISSUED FOR CONSTRUCTION 05/02/08 ADL
NO.	REVISIONS (Y/M/MDD) BY

UMA An AECOM Company 2004 UMA ENGINEERING LTD. ALL RIGHTS RESERVED.	
DESIGNED BY FMI/GEB	CHECKED BY <i>[Signature]</i>
DRAWN BY ADL	APPROVED BY <i>[Signature]</i>
HOR. SCALE 1:250	RELEASED FOR CONSTRUCTION <i>[Signature]</i>
VERT. SCALE 1:50	DATE 05/02/09

APEGM
Certificate of Authorization
UMA Engineering Ltd.
No. 256 Expiry: April 30, 2005

PROFESSIONAL'S SEAL
PROVINCE OF MANITOBA
A. MAGY
REGISTERED PROFESSIONAL ENGINEER
CONSULTANT DRAWING NO. 07
D265-177-01

THE CITY OF WINNIPEG
WATER AND WASTE DEPARTMENT

ALEXANDER/BANNATYNE
COMBINED SEWER RELIEF
CONTRACT 1A
WILLIAM AVENUE
150m E OF LARK STREET
TO ARLINGTON STREET

SHEET 7 OF 18
CITY DRAWING NUMBER
LD-3092
REV 0

BID OPPORTUNITY NO. 12-2005