

TENDER No. 92 - 2004

STILES STREET - FROM WOLSELEY AVE. TO PORTAGE AVE.

L = 307m W = 7.6m A = 2335m²

TYPE - REHABILITATION - MAJOR

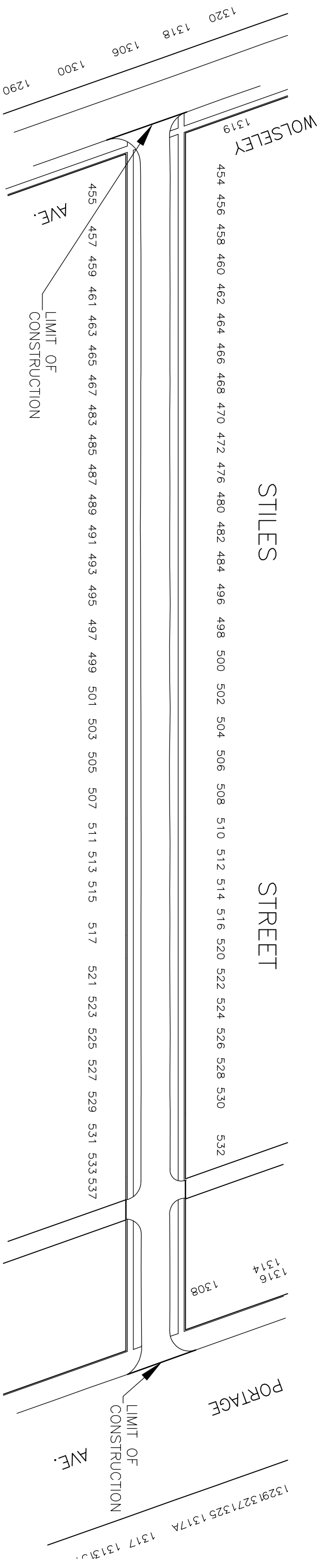

NOTES:

- EXISTING CONCRETE ROADWAY WITH ASPHALT OVERLAY
- ALL CURB TO BE REPLACED WITH NEW CURB AND GUTTER UTILIZING SLIP-FORM PAYER (620 lm)
- AVERAGE ASPHALT THICKNESS 100mm
- STILES STREET WILL BE CURB AND GUTTER REHABILITATION, WITH FEW SLAB AND JOINT REPAIRS



 DILLON CONSULTING JANUARY 2004	2004 RESIDENTIAL STREET RENEWAL PROGRAM	PROJ. NO. 03-2620-1000
	STILES STREET REHABILITATION	FIG. NO. R-2