

13 PRESSURE TREATED PLYWOOD CAN/CSA 080.15M

ASPHALTIC SEALANT ALL AROUND

FASTEN TO PRECAST CONC. TEE'S WITH ONE 6.35mmx32 ZAMAC @ 300 O.C.

18ga. G-90 (GALVANIZED)

PRECAST CONC. TEE'S (EXISTING)

FASTEN STEEL DECK TO 18ga. G-90 WITH ONE 200-470 WAFER HD TEK SCREW @ 300 O.C.

SECTION 1-1

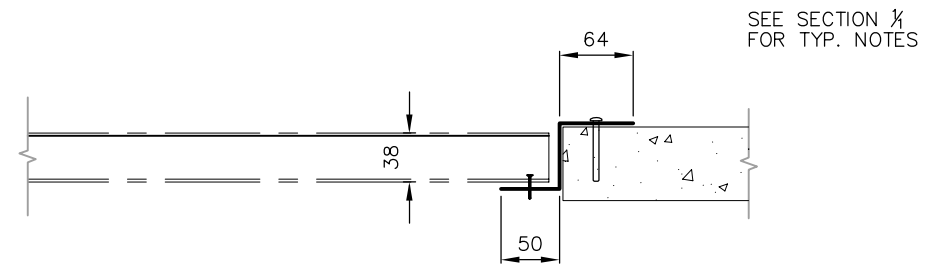

SECTION 2-1

**METRIC**  
WHOLE NUMBERS INDICATE MILLIMETRES  
DECIMALIZED NUMBERS INDICATE METRES

|                |               |  |                           |                        |  |
|----------------|---------------|--|---------------------------|------------------------|--|
| B.M. ELEV.     | FIELD BOOK #: | <b>CITY OF WINNIPEG<br/>WATER AND WASTE<br/>ENGINEERING DIVISION</b> |                           | ENGINEER'S SEAL        | <b>THE CITY OF WINNIPEG<br/>WATER AND WASTE DEPARTMENT</b>   |
| POSTED TO LBIS |               | DESIGNED BY  | CHECKED BY JE             |                        |  |
|                |               | DRAWN BY BH  | APPROVED BY JE            |                        | <b>NORTH END WATER POLLUTION<br/>CONTROL CENTRE<br/>GRIT REMOVAL BUILDING RE-ROOFING<br/>SKYLIGHT DETAIL</b> |
|                |               | HOR. SCALE N.T.S.  | RELEASED FOR CONSTRUCTION | TENDER No:             |  |
|                |               | VERTICAL   | DATE 2004 09 07           | FILENAME :             | SHEET 1 OF 1   |
| NO. REVISIONS  | DATE BY       |  |                           | PLOT DATE : 2004.09.07 | CITY DRAWING NUMBER<br><b>NEP-0056A</b>  |