

NOTE: EXACT POLE LOCATIONS TO BE DETERMINED ON SITE SUBSEQUENT TO GROUND TRUTH IDENTIFICATION OF ALL UNDERGROUND STRUCTURES.

© David Wagner Associates Inc. All rights reserved. All drawings are conceptual in nature. It is to be clearly understood that the author, in producing said drawings, shall not be liable for any and all loss, damage or injury that may result from the drawings themselves, or from the construction work produced from this plan, or from any claims that may result subsequent to the project being constructed and use commencing on the site, whether such claims are brought by persons using the site, or by the owners or others of neighbouring properties.

Should any claim be made directly against the author as a result of the drawings themselves, or as a result of the way in which the project is constructed in accordance with those drawings, or as a result of any loss, injury or damage that may be caused either on the site or outside the boundaries of the property or persons, the author is to be indemnified by the Owners in full, including the costs of defending any actions brought against the author, or the costs of paying any settlement entered into by the author, or settling any judgments made against the author.

No reproductions may be made without the permission of the Landscape Architect and when made, must bear his / her name. Any and all designs herein are the property of the Landscape Architect. If stamped and dated, the designs herein are licensed for construction, once only. All prints to be returned to the Landscape Architect on request.

This drawing shall not be used for building purposes until countersigned by the Landscape Architect.

The contractor shall check all dimensions and other data on site and report any discrepancies to the Landscape Architect.

Figured dimensions to be taken in preference to scaled dimensions.

If in doubt please ask.

DATE ISSUED
12 August 2004

LOCATION OF UNDERGROUND STRUCTURES AS SHOWN ARE BASED ON THE BEST INFORMATION AVAILABLE BUT NO GUARANTEE IS GIVEN THAT ALL EXISTING UTILITIES ARE SHOWN OR THAT THE GIVEN LOCATIONS ARE EXACT. CONFIRMATION OF EXISTENCE AND EXACT LOCATION OF ALL SERVICES MUST BE OBTAINED FROM THE INDIVIDUAL UTILITIES BEFORE PROCEEDING WITH CONSTRUCTION.

NOTE: ALL PROPOSED POLE LOCATIONS ARE CONCEPTUAL IN NATURE. EXACT LOCATIONS MUST BE FIELD APPROVED BY THE PROJECT ADMINISTRATOR. SUBSEQUENT TO IDENTIFICATION OF ALL SUBSURFACE INFRASTRUCTURE, AS IDENTIFIED BY ALL/APPLICABLE UTILITIES OR COMPANIES.

NOTE: DO NOT SCALE - DRAWING PLOT MAY NOT BE AT 100%

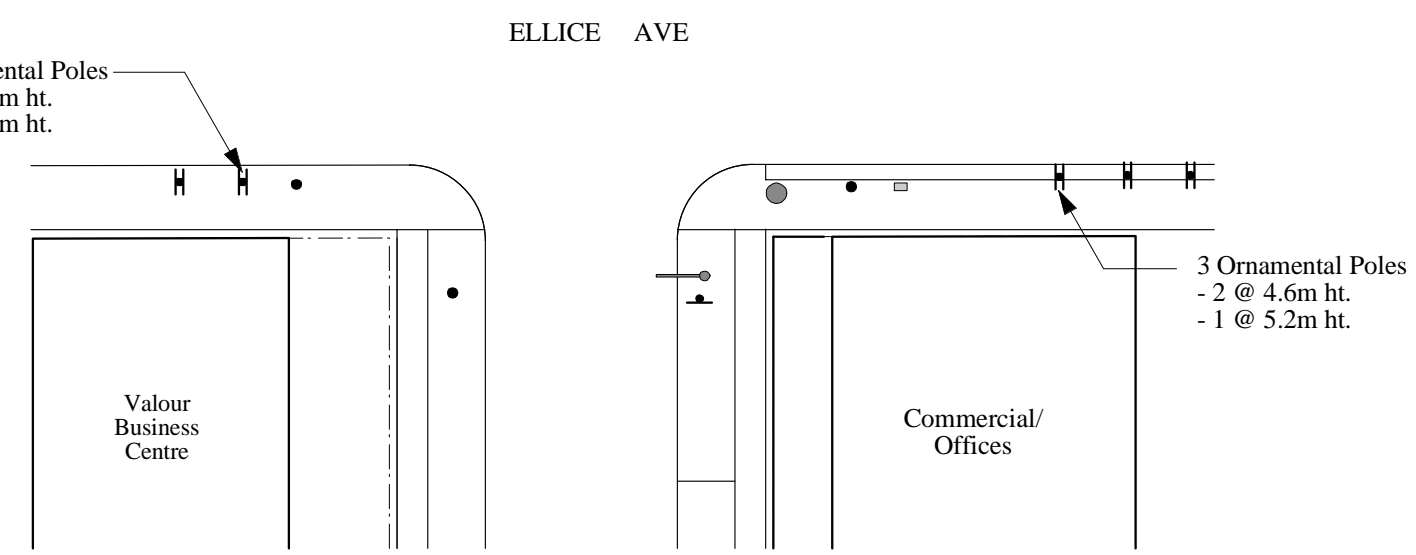
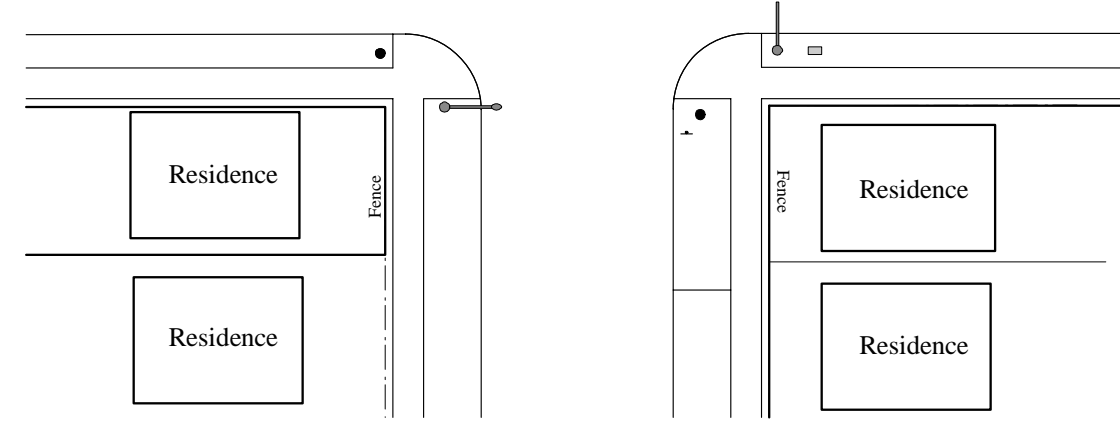
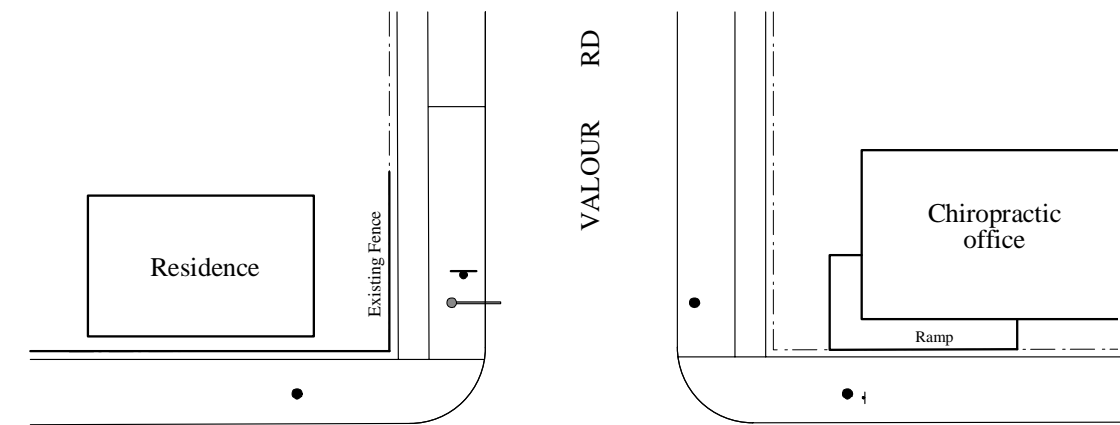
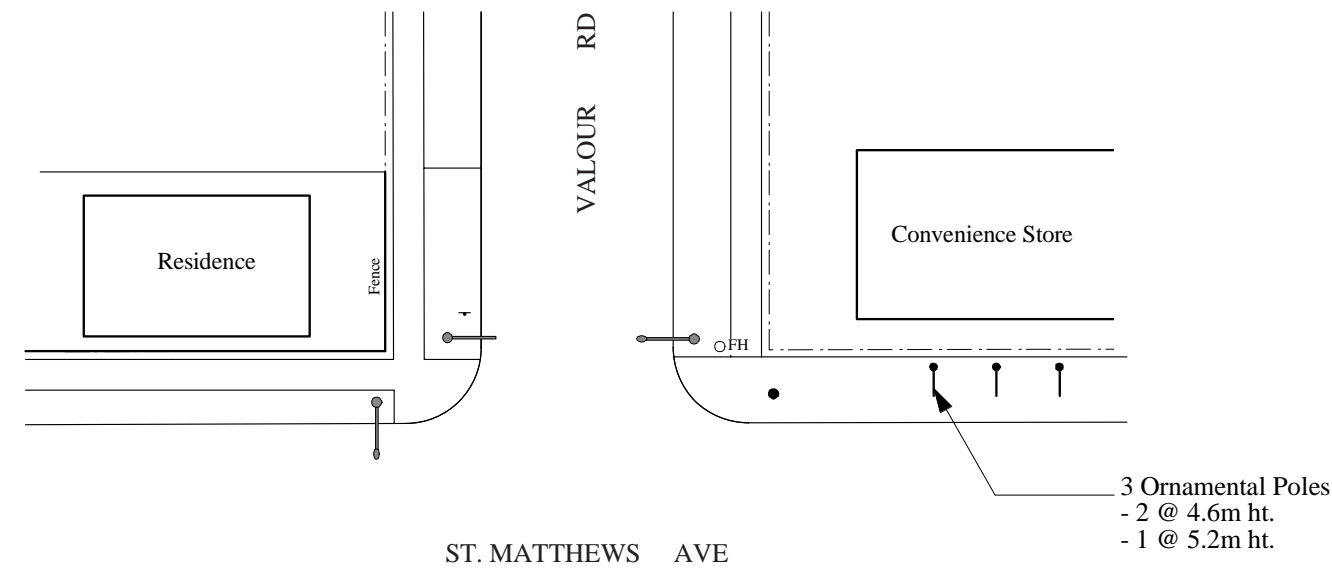

1 Proposed St. Matthews Avenue at Valour Road
L3

2 Proposed Ellice Avenue at Valour Road
L3

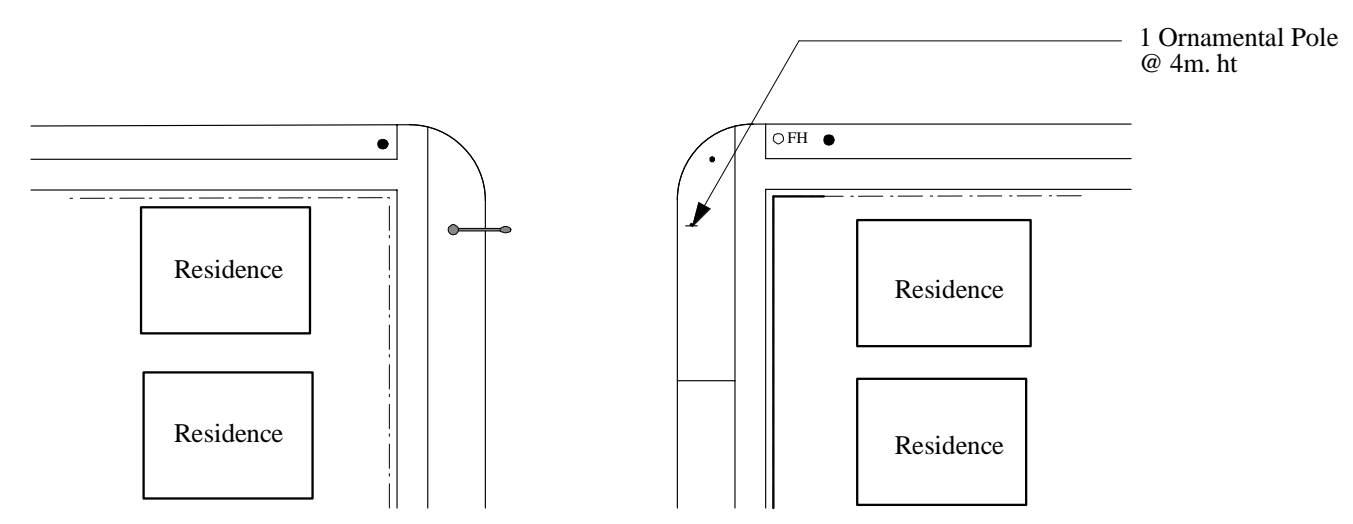
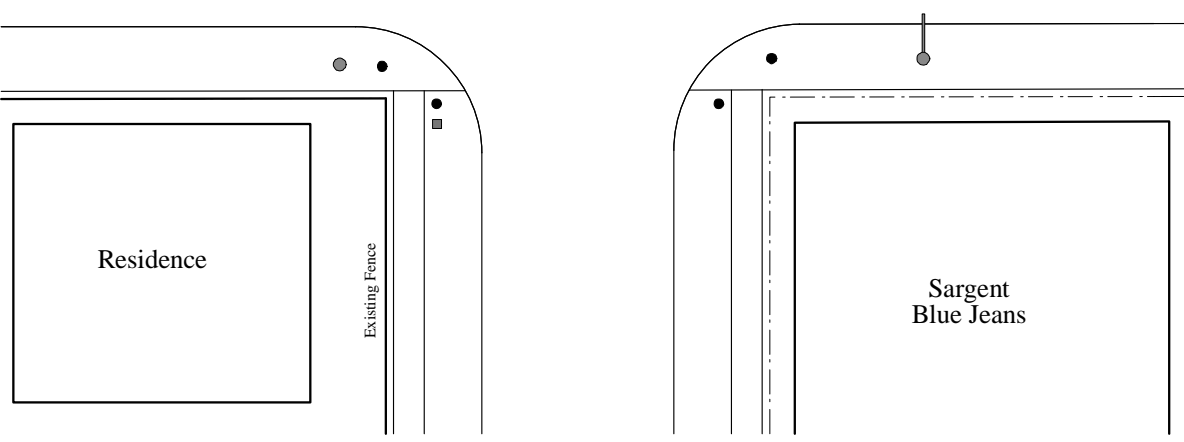
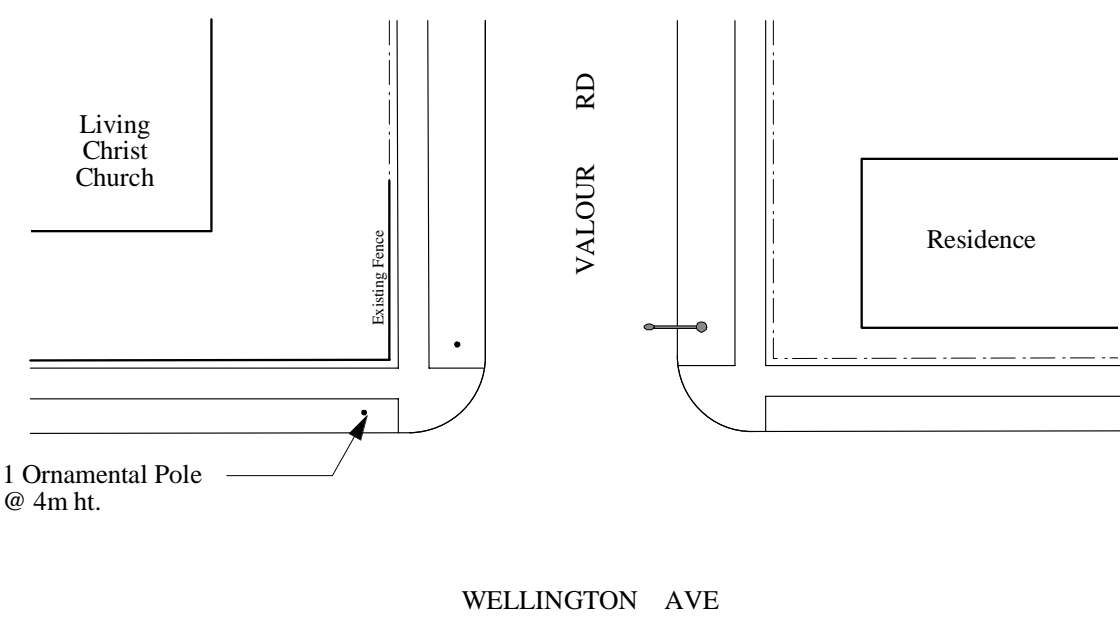
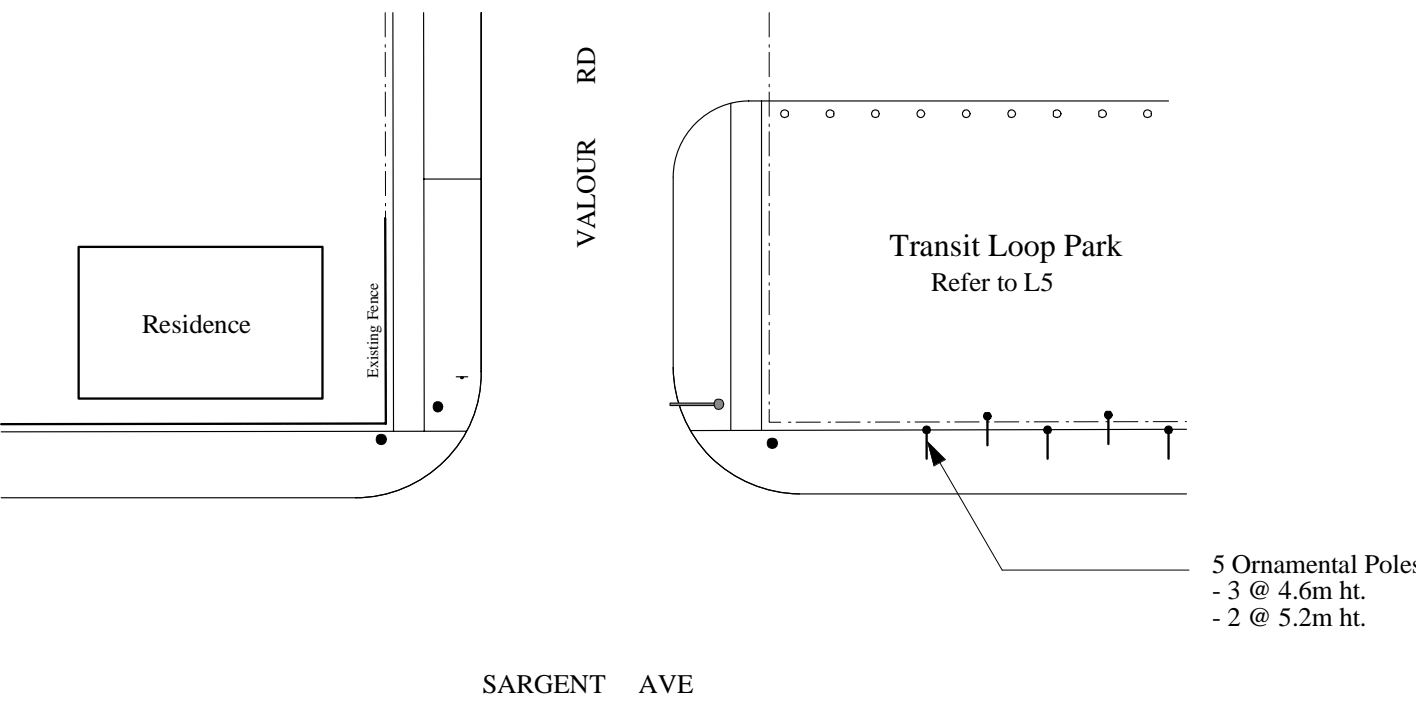

3 Proposed Sargent Avenue at Valour Road
L3

4 Proposed Wellington Avenue at Valour Road
L3



Manager Parks and Open Space Division
Released For Construction Date

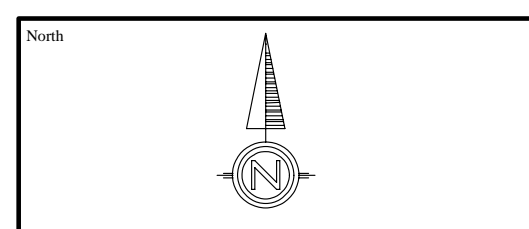

Project
Valour Road Streetscaping
Winnipeg, Manitoba

Sheet Title
Proposed Ornamental Poles Intersections

Drawn DW / MM	Approved
Date 12 August 2004	Scale 1:300
Job No. 0405-6	Drawing No. L3

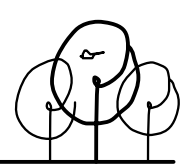

David Wagner Associates Inc.
4 - 430 River Avenue Winnipeg, Manitoba. R3L 0C6 (204) 452-2426
LANDSCAPE ARCHITECTURE • URBAN DESIGN • GOLF COURSE ARCHITECTURE