

KEY PLAN

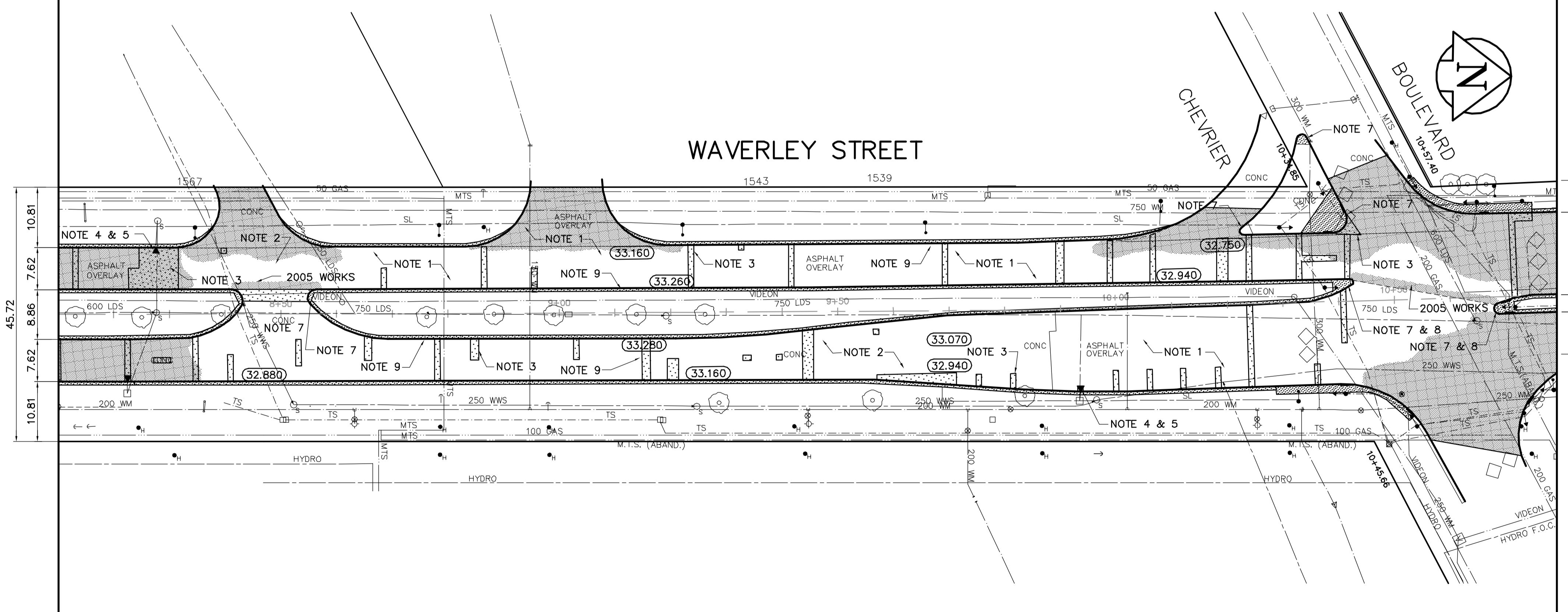

- REFERENCE NOTES**
- BASELINE IS CENTRED BETWEEN NORTHBOUND AND SOUTHBOUND GUTTER BACK OF CURB LINE.
 - LEGAL PLAN - L.B.I.S.
 - ADD 200.000 TO OBTAIN GEODETIC DATUM.
 - PAVEMENT DIMENSIONS ARE TO BACK OF CURB.
 - EARTH TECH FIELD BOOK NO. 4380.
- CONSTRUCTION NOTES**
- PLANE AND CONSTRUCT NEW ASPHALTIC CONCRETE OVERLAY.
 - CONSTRUCT NEW ASPHALTIC CONCRETE OVERLAY.
 - CONSTRUCT NEW 200mm PLAIN DOWELLED CONCRETE PAVEMENT c/w ASPHALTIC CONCRETE OVERLAY.
 - ABANDON EXISTING DRAINAGE INLET.
 - INSTALL NEW CURB & GUTTER INLET c/w CATCHPIT (SD223) AND CONNECT NEW 250 LEAD TO EXIST. CATCHBASIN.
 - ADJUST EXISTING CURB & GUTTER INLET FRAME AND COVER.
 - CONSTRUCT NEW MONOLITHIC CONCRETE BULLNOSE.
 - CONSTRUCT NEW MONOLITHIC CONCRETE MEDIAN SLAB.
 - CONSTRUCT NEW MONOLITHIC CONCRETE SPLASH STRIP.
 - CONSTRUCT NEW CONCRETE MEDIAN SLAB.
 - ADJUST EXISTING WATERMAIN VALVE BOX TO GRADE.
 - ADJUST EXISTING CATCHBASIN/MANHOLE FRAME AND COVER.
 - INSTALL NEW WATERMAIN VALVE BOX EXTENDABLE SECTION INSERT.
 - INSTALL NEW CAST IRON RISER RING.

APEGM
 Certificate of Authorization
 Earth Tech Canada Inc.
 No. 730 Expiry: April 30, 2005

METRIC
 WHOLE NUMBERS INDICATE MILLIMETRES
 DECIMALIZED NUMBERS INDICATE METRES

150 mm W.M.		300mm L.D.S.		250mm W.W.S.		232.750	
WATERMAIN	HYDRANT	LAND DRAINAGE SEWER	WASTEWATER SEWER	MANHOLE	CATCH BASIN	CURB INLET	JUNCTIONS
VALVE							CULVERT
							GAS
HYDRO	M.T.S.	CONCRETE	ASPHALT	PROPERTY LINE	SURVEY BAR	ELEVATION	(32.750)
							TREE
							SIDEWALK RAMP
							CONCRETE SIDEWALK
							FENCE
WEST MEDIAN GUTTER	EAST MEDIAN GUTTER	WEST GUTTER	EAST GUTTER				

LOCATION APPROVED UNDERGROUND STRUCTURES

SUPV. U/G STRUCTURES DATE COMMITTEE

NOTE:
 LOCATION OF UNDERGROUND STRUCTURES AS SHOWN ARE BASED ON THE BEST INFORMATION AVAILABLE, BUT NO GUARANTEE IS GIVEN THAT ALL EXISTING UTILITIES ARE SHOWN OR THAT THE GIVEN LOCATIONS ARE EXACT. CONFIRMATION OF EXISTENCE AND EXACT LOCATION OF ALL SERVICES MUST BE OBTAINED FROM THE INDIVIDUAL UTILITIES BEFORE PROCEEDING WITH CONSTRUCTION.

B.M. 65-022
 ELEV. 232.751
 N.E. Cor. Waverley St. & Clarence Ave.
 Tied to W. corner of No. 1380
 Waverley St., 0.5m S. & 0.07m below
 Tyndal stone of N.W. Cor. of Bldg.

EARTH TECH
 Earth Tech (Canada) Inc. Winnipeg, Manitoba 204.477.5381

DESIGNED BY BK CHECKED BY KWR
 DRAWN BY PAAP,RT,BC APPROVED BY ORIGINAL SIGNED

HOR. SCALE: 1:500
 VERTICAL: 1:20

ISSUED FOR CONSTRUCTION 30/07/04
 ISSUED FOR REVIEW 22/07/04

NO. REVISIONS DATE BY

DATE 2004/07/12 DATE DATED 29/07/04

ENGINEER'S SEAL
 ORIGINAL SIGNED BY
K.W. RAE
 30/07/04
 REGISTERED PROFESSIONAL ENGINEER

THE CITY OF WINNIPEG
 PUBLIC WORKS DEPARTMENT
 ENGINEERING DIVISION

WAVERLEY STREET
 BISHOP GRANDIN BLVD TO CLARENCE AVENUE
 CONCRETE REPAIRS AND ASPHALT RESURFACING

PLAN-PROFILE
 STA. 8+10 TO STA. 10+80

CITY DRAWING NUMBER PD-3252-04
 SHEET 5 OF 7