

KEY PLAN

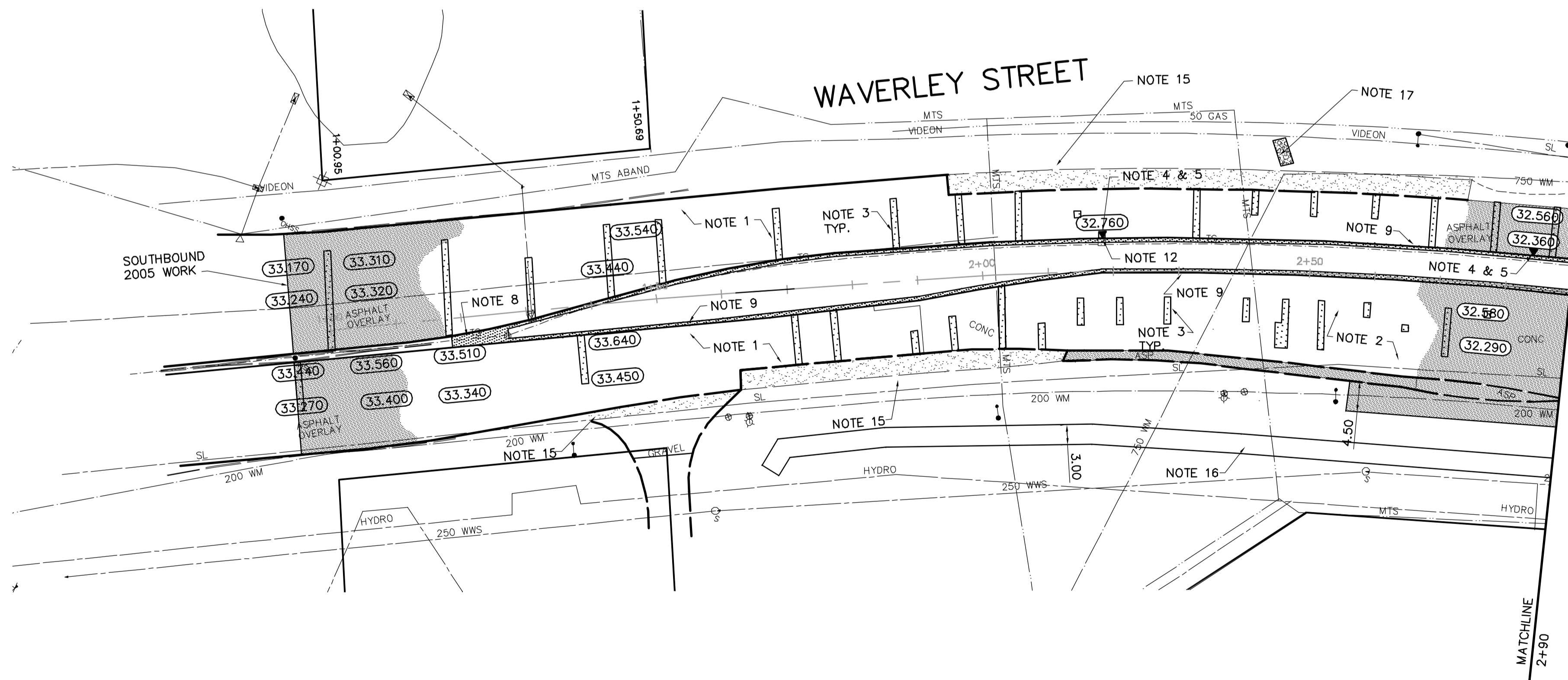
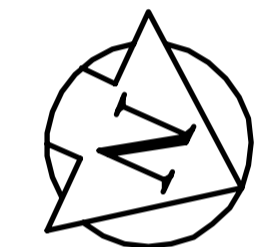

- REFERENCE NOTES**
- BASILINE IS CENTRED BETWEEN NORTHBOUND AND SOUTHBOUND GUTTER BACK OF CURB LINE.
  - LEGAL PLAN - L.B.I.S.
  - ADD 200.000 TO OBTAIN GEODETIC DATUM.
  - PAVEMENT DIMENSIONS ARE TO BACK OF CURB.
  - EARTH TECH FIELD BOOK NO. 4380.
- CONSTRUCTION NOTES**
- PLANE AND CONSTRUCT NEW ASPHALTIC CONCRETE OVERLAY.
  - CONSTRUCT NEW ASPHALTIC CONCRETE OVERLAY.
  - CONSTRUCT NEW 200mm PLAIN DOWELLED CONCRETE PAVEMENT c/w ASPHALTIC CONCRETE OVERLAY.
  - ABANDON EXISTING DRAINAGE INLET.
  - INSTALL NEW CURB & GUTTER INLET c/w CATCHPIT (SD223) AND CONNECT NEW 250 LEAD TO EXIST. CATCHBASIN.
  - ADJUST EXISTING CURB & GUTTER INLET FRAME AND COVER.
  - CONSTRUCT NEW MONOLITHIC CONCRETE BULLNOSE.
  - CONSTRUCT NEW MONOLITHIC CONCRETE MEDIAN SLAB.
  - CONSTRUCT NEW MONOLITHIC CONCRETE SPLASH STRIP.
  - CONSTRUCT NEW CONCRETE MEDIAN SLAB.
  - ADJUST EXISTING WATERMAIN VALVE BOX TO GRADE.
  - ADJUST EXISTING CATCHBASIN/MANHOLE FRAME AND COVER.
  - INSTALL NEW WATERMAIN VALVE BOX EXTENDABLE SECTION INSERT.
  - INSTALL NEW CAST IRON RISER RING.
  - REGRADE EXISTING GRAVEL SHOULDER AND PLACE LIMESTONE SURFACING MATERIAL.
  - REGRADE EXISTING DITCH AND SEED.
  - PLACE RIPRAP.

**APEGM**  
 Certificate of Authorization  
 Earth Tech Canada Inc.  
 No. 730 Expiry: April 30, 2005

METRIC  
 WHOLE NUMBERS INDICATE MILLIMETRES  
 DECIMALIZED NUMBERS INDICATE METRES

EXISTING	LEGEND - PLAN	PROPOSED	EXISTING	LEGEND - PLAN	PROPOSED	EXISTING	LEGEND - PROFILE	PROPOSED
150 mm W.M.	WATERMAIN	150 mm W.M.	HYDRO	CONCRETE	CONCRETE	---	Q PROFILE	---
300mm L.D.S.	LAND DRAINAGE SEWER	300mm L.D.S.	M.T.S.	ASPHALT	ASPHALT	---	WEST MEDIAN GUTTER	---
250mm W.W.S.	WASTEWATER SEWER	250mm W.W.S.	CONCRETE	PROPERTY LINE	PROPERTY LINE	---	EAST MEDIAN GUTTER	---
○	MANHOLE	●	ASPHALT	SURVEY BAR	SURVEY BAR	---	WEST GUTTER	---
□	CATCH BASIN	■	CONCRETE	ELEVATION	ELEVATION	---	EAST GUTTER	---
▽	CURB INLET	▽	ASPHALT	TREE	TREE	---		
+	JUNCTIONS	+	CONCRETE	SIDEWALK RAMP	SIDEWALK RAMP	---		
---	CULVERT	---	CONCRETE	CONCRETE SIDEWALK	CONCRETE SIDEWALK	---		
---	GAS	---	CONCRETE	FENCE	FENCE	---		

**LOCATION APPROVED UNDERGROUND STRUCTURES**

SUPV. U/G STRUCTURES DATE COMMITTEE

**NOTE:**  
 LOCATION OF UNDERGROUND STRUCTURES AS SHOWN ARE BASED ON THE BEST INFORMATION AVAILABLE. BUT NO GUARANTEE IS GIVEN THAT ALL EXISTING UTILITIES ARE SHOWN OR THAT THE GIVEN LOCATIONS ARE EXACT. CONFIRMATION OF EXISTENCE AND EXACT LOCATION OF ALL SERVICES MUST BE OBTAINED FROM THE INDIVIDUAL UTILITIES BEFORE PROCEEDING WITH CONSTRUCTION.

B.M. 65-022  
 ELEV. 232.751  
 N.E. Cor. Waverley St. & Clarence Ave.  
 Tab. in W. conc. mds. of No. 1380  
 Waverley St., 0.5m S. & 0.07m below  
 Tyndal stone of N.W. Cor. of Bldg.

**EARTH TECH**  
 Earth Tech (Canada) Inc. Winnipeg, Manitoba 204.477.5381

DESIGNED BY BK CHECKED BY KWR  
 DRAWN BY PAAP,RT APPROVED BY ORIGINAL SIGNED

HOR. SCALE: 1:500  
 VERTICAL: 1:20

RELEASED FOR CONSTRUCTION BY:  
 ORIGINAL SIGNED AND DATED 29/07/04

1 ISSUED FOR CONSTRUCTION 30/07/04  
 0 ISSUED FOR REVIEW 22/07/04

NO. REVISIONS DATE BY

ENGINEER'S SEAL  
 PROVINCE OF MANITOBA  
 ORIGINAL SIGNED BY  
**K.W. RAE**  
 30/07/04  
 REGISTERED PROFESSIONAL ENGINEER

**THE CITY OF WINNIPEG**  
 PUBLIC WORKS DEPARTMENT  
 ENGINEERING DIVISION

**Waverley Street**  
 BISHOP GRANDIN BLVD TO CLARENCE AVENUE  
 CONCRETE REPAIRS AND ASPHALT RESURFACING

CITY DRAWING NUMBER PD-3252-01  
 SHEET 2 OF 7

PLAN-PROFILE  
 BISHOP GRANDIN BLVD TO STA. 2+90