

SEWER SERVICE INFORMATION (ID #19816) *	
DISTANCE FROM MH AT KITSON ST. (MH ID #19815)	
1.6 S	SERVICE CONNECTION W
7.3 S	SERVICE CONNECTION W
21.3 S	SERVICE CONNECTION E
22.0 S	SERVICE CONNECTION W
31.8 S	SERVICE CONNECTION W
35.3 S	SERVICE CONNECTION E
36.0 S	SERVICE CONNECTION E
38.4 S	SERVICE CONNECTION W
44.3 S	SERVICE CONNECTION E
46.0 S	SERVICE CONNECTION W
53.2 S	SERVICE CONNECTION W
62.0 S	SERVICE CONNECTION W
65.6 S	SERVICE CONNECTION E
66.6 S	SERVICE CONNECTION E
67.9 S	SERVICE CONNECTION W
82.1 S	SERVICE CONNECTION W
82.7 S	SERVICE CONNECTION E
89.3 S	SERVICE CONNECTION AT 12 O'CLOCK
92.3 S	SERVICE CONNECTION W
96.8 S	SERVICE CONNECTION W

* - INFORMATION FROM SEWER VIDEO INSPECTION

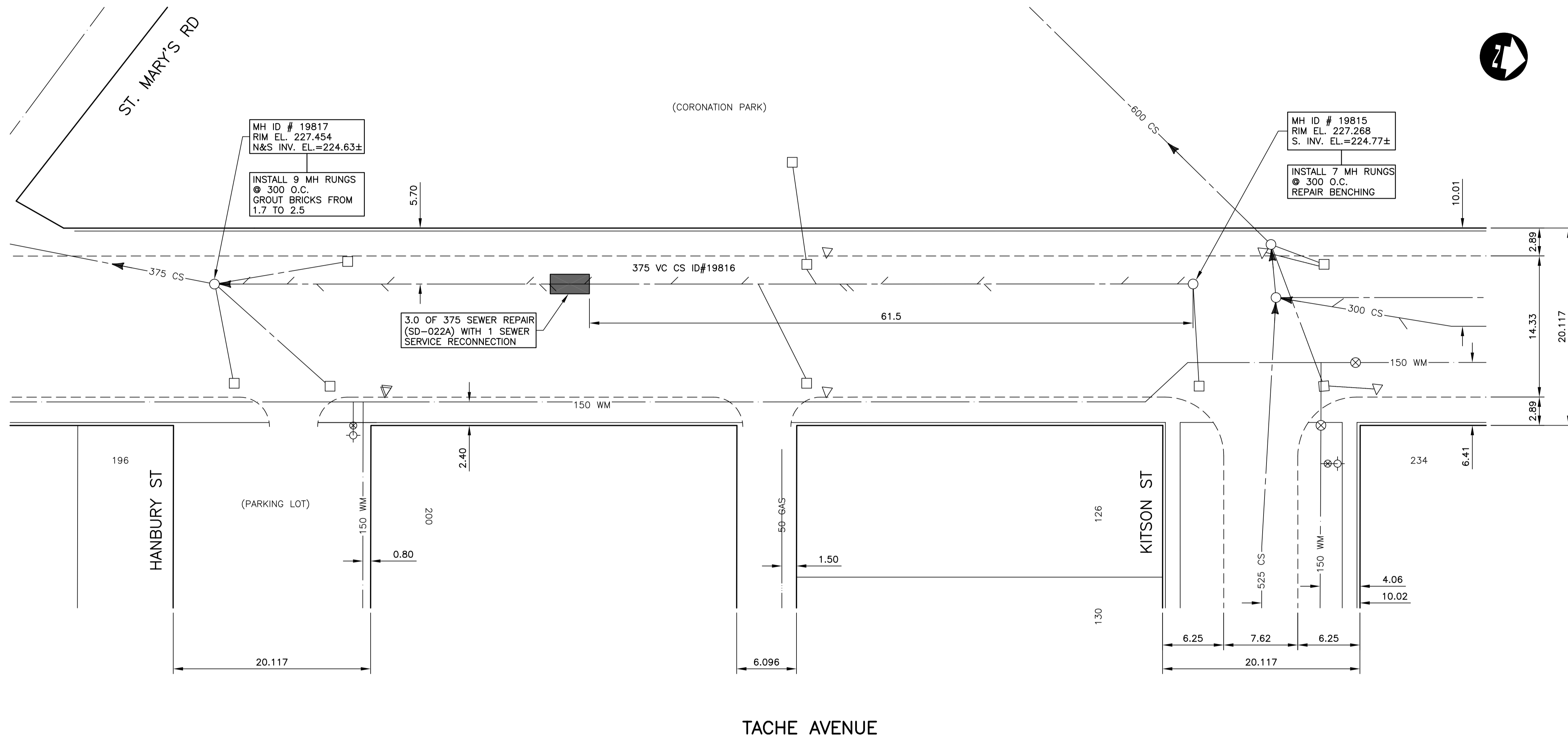

WARNING

IF POWER EQUIPMENT OR EXPLOSIVES ARE TO BE USED FOR EXCAVATION ON THIS PROJECT THE CONTRACTOR MUST:

1. NOTIFY THE GAS COMPANY OF THE PROPOSED LOCATION OF EXCAVATION.
2. TAKE PRECAUTION TO AVOID DAMAGE TO GAS COMPANY INSTALLATIONS
SEE PROVINCIAL REGULATION 210/72 FOR DETAILS

METRIC

WHOLE NUMBERS INDICATE MILLIMETRES
DECIMALIZED NUMBERS INDICATE METRES

150 mm W.M.		150 mm W.M.		HYDRO		150 mm W.M.		150 mm W.M.			
○	WATERMAIN	○	WATERMAIN	---	HYDRO	---	WATERMAIN	---	WATERMAIN		
+	HYDRANT	+	HYDRANT	---	M.T.S.	+	HYDRANT	+	HYDRANT		
⊗	VALVE	⊗	VALVE	---	CONCRETE	⊗	VALVE	⊗	VALVE		
○	LAND DRAINAGE SEWER	○	LAND DRAINAGE SEWER	---	ASPHALT	○	LAND DRAINAGE SEWER	○	LAND DRAINAGE SEWER		
○	WASTE WATER SEWER	○	WASTE WATER SEWER	---	PROPERTY LINE	○	WASTE WATER SEWER	○	WASTE WATER SEWER		
○	MANHOLE	○	MANHOLE	---	SURVEY BAR	○	MANHOLE	○	MANHOLE		
○	CATCH BASIN	○	CATCH BASIN	---	SERVICE VALVE	○	CATCH BASIN	○	CATCH BASIN		
○	CURB INLET	○	CURB INLET	---	I.P.S.	○	CURB INLET	○	CURB INLET		
○	JUNCTIONS	○	JUNCTIONS	---	BUILDING	○	JUNCTIONS	○	JUNCTIONS		
○	CULVERT	○	CULVERT	---		○	CULVERT	○	CULVERT		
○	GAS	○	GAS	---		○	GAS	○	GAS		
---	EXISTING	---	LEGEND-PLAN	---	PROPOSED	---	EXISTING	---	LEGEND-PROFILE	---	PROPOSED

UNDERGROUND STRUCTURES	
SUPV. U/G STRUCTURES COMMITTEE	DATE

NOTE:
LOCATION OF UNDERGROUND STRUCTURES AS SHOWN ARE BASED ON THE BEST INFORMATION AVAILABLE. BUT NO GUARANTEE IS GIVEN THAT ALL EXISTING UTILITIES ARE SHOWN OR THAT THE GIVEN LOCATIONS ARE EXACT. CONFIRMATION OF EXISTENCE AND EXACT LOCATION OF ALL SERVICES MUST BE OBTAINED FROM THE INDIVIDUAL UTILITIES BEFORE PROCEEDING WITH CONSTRUCTION.

B.M. ELEV.	

NO.	REVISIONS	DATE	BY
2	ISSUED FOR TENDER	07/23/04	P.M.K.
1	SUBMITTED TO W&W FOR REVIEW	06/30/04	P.M.K.

DESIGNED BY	A.R.P.
DRAWN BY	S.C.C.
CHECKED BY	P.M.K.
APPROVED BY	
HOR. SCALE	1:500
VERTICAL	
DATE	JUNE 2004

RELEASED FOR CONSTRUCTION (ORIGINAL SIGNED BY) KAS ZUREK
DATE JULY 22, 2004

CONSULTANT DRAWING NO. 043032-06

2004 COMBINED SEWER RENEWALS AND REPAIRS - CONTRACT 10
TACHE AVENUE
MH AT KITSON ST (S. OF CL) TO MH AT HANBURY ST

CITY DRAWING NUMBER	05498
SHEET	6 OF 17
BID OPPORTUNITY NO.	305-2004